

## PARTS & INSTALLATION INSTRUCTIONS AGGRESSOR HYDRAULICS

### PARTS LIST

Item	Part No.	Qty	Description
1	15853	1	AG Hydraulic Carton
	05872	1	• Lift Ram 3 x 8 DA
	07077	2	• Ram Assy 2-1/2" x 11-1/2" Stroke SA
2	05874	1	•• Ram 2-1/2" x 11-1/2" Stroke SA
3	22722	1	•• 90° Elbow SAE 8 x 1/2 ORF
4	22723	1	•• 1/2 x 48" Hose Assy 1/2 ORF
5	08787	1	• Hardware Bag-AG Hydraulic
	08474	1	•• Kit Pressure Relief
6	22723	1	•• 1/2 x 48" Hose Assy 1/2 ORF
7	22722	1	•• 90° Elbow SAE 8 x 1/2 ORF
8	22769	3	•• Fitting 8 SAE x 1/2 ORF
9	22323	4	•• 1" x 4-1/4" Cylinder Pin
10	22324	2	•• 1" x 3-1/2" Cylinder Pin
11	20420	4	•• 1/4 Dia. x 2 Cotter Pin CP
12	22083	2	•• Lynch Pin
13	21262	2	•• Washer Flat 1" SAE CP

Parts indented are included in the carton, bag or assembly under which they are indented.

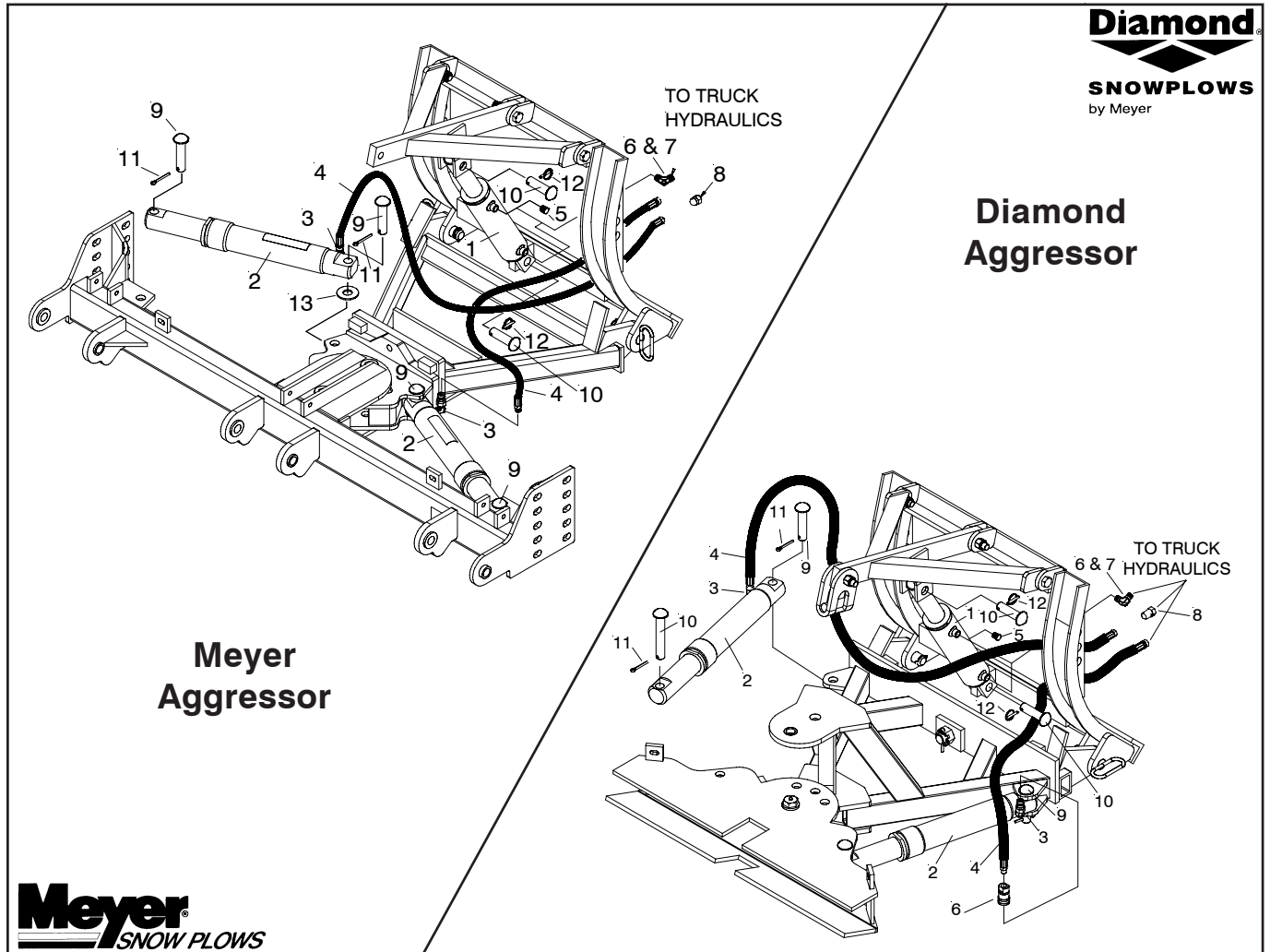

**Diamond**  
**SNOW PLOWS**  
by Meyer

**Diamond  
Aggressor**

**Meyer  
Aggressor**

**Meyer**  
**SNOW PLOWS**

Meyer Products reserves the right, under its continuing product improvement program, to change construction or design details, specifications and prices without notice or without incurring any obligation.

Meyer Products  
18513 Euclid Ave. • Cleveland, Ohio 44112-1084  
Phone 486-1313 (Area Code 216)  
www.meyerproducts.com • email info@meyerproducts.com

Meyer Products East  
6 Angell Lane • Damariscotta, ME 04543-9801  
Phone 563-2227 (Area Code 207)  
www.diamondplow.com • email info@diamondplow.com

## GENERAL INFORMATION

This kit is intended to be used with a vehicle equipped with a central hydraulic system or equivalent. It is the distributors/customers responsibility to supply/install hydraulic components (hoses, pumps, valves, etc.) and controls that are needed to complete the installation.

Note: All Hydraulic cylinders have a maximum operating pressure of 2500 PSI.

Check contents against the parts list to determine all are correct and included, and also to familiarize yourself with them.

**SAFETY PRECAUTIONS** should be used when **any Hydraulics are in OPERATION** and plow is in a **RAISED** position. **Lower plow to ground when vehicle is PARKED.**

**SERVICE INFORMATION** is covered on separate instruction.

Follow these instructions explicitly. Warranty does not apply to a Meyer or Diamond product which has been negligently or improperly assembled or installed.

## INSTALLATION INSTRUCTIONS

- A. Install Lift Ram (1) to Lift Frame/Lift Arm with the ports facing toward the left hand side (Driver's side) using 1" x 3-1/2" Cylinder Pins (10) and Lynch Pins (12).
- B. Remove shipping plugs from both ports on Lift Ram (1). **For Single Acting Lift Ram Application (Gravity Down):** Install Elbow (7) in the lower port and Relief Valve (5) in the upper port in conjunction with a hydraulic sealant.
- C. Attach hose from the truck hydraulics that controls the plow raise to the lower port Elbow (7).

**WARNING: Lift arm extends beyond bumper of vehicle. To minimize damage from a front-end collision, lift arm should be removed from vehicle when snow plow is removed.**

### POWER ANGLING CYLINDERS:

- D. Attach Power Angling Cylinder (2) to Pivot Bar and Push Plate Weld using 1" x 4-1/2" Cylinder Pins (9), and Cotter Pins (11).

**NOTE DIAMOND AGGRESSOR ONLY:** Pins to attach power angling cylinders to moldboard are packed in the 08795 Hardware Bag, part of the 81505 Common Attaching Kit.

**NOTE MEYER AGGRESSOR ONLY:** One 1" Washer (13) should be installed on each side between the bottom of the ram's dead end and the top surface of the lower plate on the Push Plate Weld.

Power Angling Cylinders are not filled with any hydraulic fluid. It may be necessary to bleed the Power Angling Cylinders, proceed as follows:

- a. Temporarily loosen both hose connections at the Power Angling Cylinder's elbows. Base end of Cylinder must be higher than Rod end to enable trapped air to escape.
- c. Angle the Plow in both directions until fluid leaks out at both points in a steady flow.
- d. Retighten the connections.

**Meyer Products or Diamond Equipment assumes no responsibility for installations not made in accordance with these instructions.**