

## PARTS & INSTALLATION INSTRUCTIONS

### MEYER HYDRAULIC LIFT and POWER ANGLING RAMS

#### PARTS LIST

Item	Part No.	Description
	05984	1-1/2" x 6" Lift Ram
	05810	1-1/2" x 10" Power Angling Ram
	05437	1-1/2" x 12" Power Angling Ram
1a	07805	• Gland Nut - Includes Wiper Ring
2a	07705	• Seal Kit- Wiper Ring - (5) Packing Set
1b	07832	• Gland Nut - Includes Wiper Ring
2b	07831	• Seal Kit- Wiper Ring - (5) Packing Set
3	07773	• GUIDE RING
	05827	2" x 6" Lift Ram
	05752	2" x 12" Power Angling Ram
1	07806	• Gland Nut - Includes Wiper Ring
2	07799	• Seal Kit - Wiper Ring - Packing Set
3	07800	• GUIDE RING

**When ordering parts, furnish part No., Name and Description**

Replacement Packings or Seals should be oil soaked before installing.

After assembly, Oil Test to 3000 P.S.I. and check for leaks.

Hydraulic Rams with Gland Nut are designed with Wiper Ring to wipe foreign matter from the Rod.

Packing Set is located under Gland Nut and can be tightened to stop leakage.

**DO NOT** over tighten; packing will seize and restrict Rod movement.

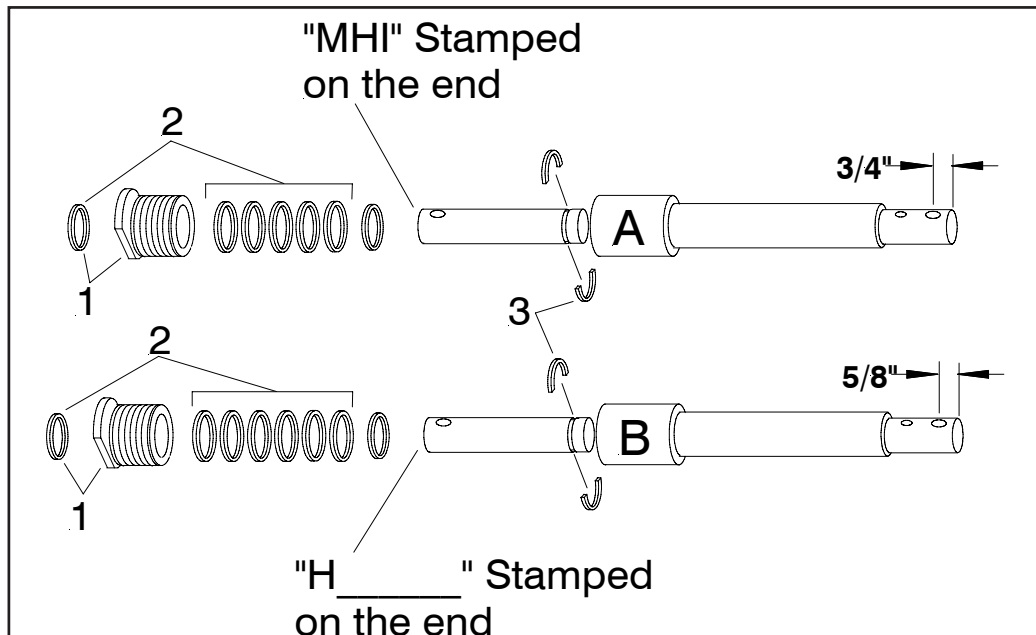

Parts indented are included in the carton, bag or assembly under which they are indented. When ordering parts, furnish Part No., Name, and Description. Also furnish Vehicle Model and Year. Type of Hydraulic Unit and Moldboard Size.

Meyer Products reserves the right, under its continuing product improvement program, to change construction or design details, specifications and prices without notice or without incurring any obligation.