

## PARTS & INSTALLATION INSTRUCTIONS MEYER SNOW PLOW MOUNTING FOR SUZUKI SAMURAI

**VEHICLE MUST COMPLY WITH VEHICLE MANUFACTURER'S  
SPECIFICATIONS FOR SNOW PLOW APPLICATION.**

### PARTS LIST

Item	Part No.	Quantity	Description
	18040	1	MOUNTING CARTON
1	11120	1	• Frame Support
2	11135	1	• Lift Frame
3	11130	1	• Sidemember, R.H.
4	11131	1	• Sidemember, L.H.
5	11125	1	• Clevis Frame
6	11136	2	• Strap
7	11137	2	• Light Bracket
8	11138	2	• Light Bracket Brace
9	10514	1	• Lift Arm
10	10529	1	• Support Arm
11	13600	1	• A-Frame
12	12984	1	• Pivot Bar
13	12978	2	• Trip Spring
	08573	1	• Mounting Hardware Bag
14	20049	2	•• Bolt H 3/8-16 x 1" Gr. 2
15	20050	4	•• Bolt H 3/8-16 x 1-1/4" Gr. 2
16	20056	2	•• Bolt H 3/8-16 x 2-3/4" Gr. 2
17	20062	2	•• Bolt H 3/8-16 x 4-1/2" Gr. 2
18	20083	1	•• Bolt H 7/16-14 x 4" Gr. 5
19	20139	2	•• Bolt H 5/8-11 x 1-1/2" Gr. 5
20	20141	4	•• Bolt H 5/8-11 x 2" Gr. 5
21	20144	1	•• Bolt H 5/8-11 x 2-3/4" Gr. 5
22	20147	2	•• Bolt H 5/8-11 x 3-1/2" Gr. 5
23	20149	2	•• Bolt H 5/8-11 x 4" Gr. 5
24	20305	6	•• Locknut 3/8
25	20309	9	•• Locknut 5/8
26	20319	2	•• Locknut (Eslok) 5/8
27	10538	2	•• Quick Disconnect Pin
28	21984	2	•• Hair Pin Cotter
29	20327	4	•• Lockwasher, 3/8
30	20353	8	•• Flatwasher, 3/8
31	20315	1	•• Locknut (Eslok) 7/16
32	11139	3	•• Plate Washer 5/8
33	11140	1	•• Plate Washer 7/16
34	11067	2	•• Plate
	08511	1	• Hardware Bag - Moldboard
35	11006	2	•• Hinge Pins
36	21984	2	•• Hair Pin Cotter
37	12150	2	•• Eye Bolts
38	20309	5	•• Locknuts 5/8-11
39	13598	2	•• Pivot Bolts
40	13591	1	•• King Bolt
41	20150	2	•• Bolt, H 5/8-11 x 4-1/2" Gr. 5
42	20318	4	•• Nuts, Eslock, 5/8-11
	09916	1	• Snow Plow Marker Kit
43	08201	2	•• Snow Plow Marker Assy.
44	12816	2	•• Clamps
45	20005	2	•• Bolt, H 1/4-20 x 1"
46	20312	2	•• Locknuts, 1/4-20
47	20325	2	•• Lockwasher 1/4
	08470	1	• Kit, Electrical Disconnect
48	09103	1	MOLDBOARD ASSEMBLY — TM-6
49	09104	1	• Cutting Edge — TM-6
50	21943	5	• Bolt C 1/2-13 x 1-3/4"
51	20307	5	• Locknut 1/2-13

Parts indented are included in the carton, bag or assembly under which they are indented. When ordering parts furnish Part No., Name and Description. Also furnish Vehicle Model and Year, Type of Hydraulic Unit and Moldboard Size.

Meyer Products reserves the right, under its continuing product improvement program, to change construction or design details, specifications and prices without notice or without incurring any obligation.

## GENERAL INFORMATION

**CAUTION:** Always disconnect battery before beginning installation. **DO NOT** burn holes or weld vehicle frame. This may cause frame failure.

After first use retighten all mounting bolt connections to specified torque. All mounting bolt connections to be checked periodically for tightness.

Check contents against the parts list to determine all are correct and included, and also to familiarize yourself with them.

Locknuts are furnished. Do not tighten bolts and nuts until installation is complete (unless otherwise specified), then be sure to tighten all attaching parts per specified torque chart.

It is important that the Meyer harness, all wires from the Meyer light switch, and all other electrical wires be routed around hot or moving engine parts, and any sharp sheet metal. Protection must be provided to guard against wire damage at these points. All excess or loose wire must be neatly secured using wire ties.

TORQUE CHART FOOT LBS.

Bolt-Nut Size	GR. 2	GR. 5 or 8.8 Metric	GR. 8
1/4 - 20	4 - 5	26 - 29	60 - 66
5/16 - 18	9 - 11	42 - 46	90 - 100
3/8 - 16	17 - 20	64 - 72	179 - 198
7/16 - 14		127 - 141	
1/2 - 13		227 - 251	
5/8 - 11			
3/4 - 10			

## INSTALLATION INSTRUCTIONS

- Remove bumper, keep all fasteners.
- Remove tow hooks and place in cab of vehicle.
- Insert Frame Support (1) in ends of vehicle frame and secure using 3/8 x 2-3/4" Bolts (16), Locknuts (24) and Flatwashers (30) in the upper hole on each side. Use 3/8 x 4-1/2" Bolts (17), Flatwashers (30), Plate (34) and Locknuts (24) in the lower hole on each side. Refer to drawing for proper location of Flatwashers and Plates. Tighten all fasteners to proper torque.
- Re-attach bumper using original fasteners and tighten to proper torque.
- Temporarily attach hole "A" of Sidemembers (3 & 4) to Frame Support (1) at hole "A". While holding Sidemembers (3 & 4) tightly up against vehicle frame, use them as a template to drill one 11/16" diameter hole on the driver's side frame rail and two 11/16" diameter holes on the passenger side.
- Install 5/8x3-1/2" Bolt (22), 5/8 Platewasher (32) and Locknut (25) in forward hole of R.H. Sidemember (3) and hole "B" on passenger side of vehicle frame. Remove steering gear bolt from hole "B" on driver's side and install 7/16x4" Bolt (18), 7/16 Platewasher (33) and Locknut (31) in hole "B" and forward hole of L.H. Sidemember (4). Install Straps (6) using 5/8x4" Bolts (23), 5/8 Platewasher (32) and Locknuts (25) in rear hole of Sidemembers (3 & 4) and holes "C" in vehicle frame. Refer to drawing for proper order of fasteners. Do not tighten.

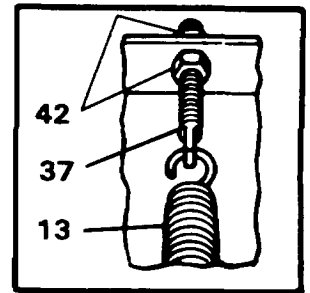
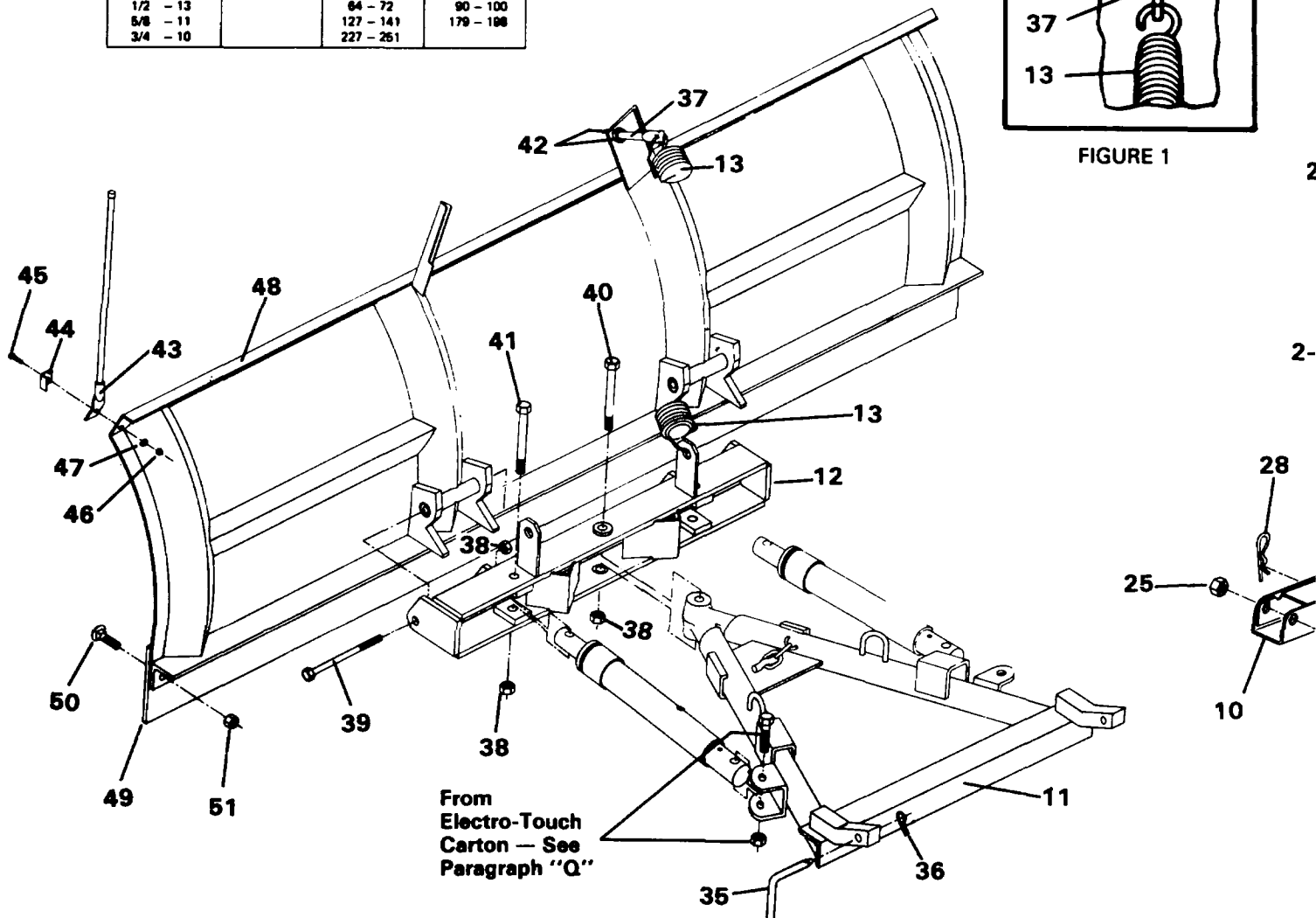

FIGURE 1



- G. Attach Lift Frame (2) and Clevis Frame (5) to Frame Support (1) and Sidemembers (3 & 4) using 5/8x2" Bolts (20) and Locknuts (25). Do not tighten.
- H. Attach loose end of Straps (6) to Clevis Frame (5) using 5/8x 1-1/2" Bolts (19) and Eslok nuts (26). [Eslok nuts are not as tall as the other locknuts and have the locking material in the threads themselves.] Eslok nuts must be used to allow proper installation of Hinge Pins (35).
- I. Tighten all remaining fasteners to proper torque as shown in torque chart while pulling forward on Lift Frame (2) and pushing back on Clevis Frame (5).
- J. Install Light Brackets (7) to top of Lift Frame (2) using 3/8x 1-1/4" Bolts (15), Lockwashers (29) and Light Bracket Braces (8) using 3/8x1" Bolts (14) and Locknuts (24).
- K. Install lights per separate instructions, making certain lights do not interfere with opening of hood. **IMPORTANT:** Follow "special instructions" paragraph on light instruction sheet 1-625 to locate vehicle high and low beam wires. The white wires are attached as follows:
- | connect white wire to: | Driver's Side     | Passenger Side   |
|------------------------|-------------------|------------------|
|                        | White/Blue Stripe | White/Red Stripe |
- L. Attach Electro-Touch Unit to Support Arm (10) using 5/8"x 3-1/2" bolt (22) and 5/8" locknut (25) and to Lift Arm (9) using 5/8" x 2-3/4" bolt (21) and 5/8" locknut (25). Secure this

assembly to Lift Frame (2) using Quick-Disconnect pins (27) and Hair Pin Cotter (28).

- M. Install Electro-Touch wiring system per separate instructions.
- N. Attach Pivot Bar (12) to Moldboard (48) using pivot bolts (39) coated with chassis lubricant, and 5/8" locknut (38).
- O. Attach Trip Springs (13) to Pivot Bar (12) and Moldboard (48) with eye bolts (37) and locknuts (42). Flat end of eye bolt (37) must be in a vertical position, as shown in Figure 1, to hinge properly when Moldboard (48) trips. Proper tension is attained when Trip Spring (13) coils begin to separate and then tightening top locknut (42) four additional turns. Tighten bottom locknut (42) to secure eye bolt (37) in position. See Figure 1.
- P. Assemble A-frame (11) to Pivot Bar (12) using King bolt (40) and 5/8" locknut (38). Grease King bolt (40) prior to installation.
- Q. Install Power-Angling Rams with fitting end to the A-frame (11) using 5/8" x 3-1/4" bolt and 5/8" locknut (packed in hardware bag 08363 in Electro-Touch carton). Attach piston end of ram to Pivot Bar (12) using 5/8" x 4-1/2" bolt (41) and 5/8" locknut (38).
- R. Straighten end of Plow Markers (43) so they will be vertical after installation. Attach using 1/4" x 1" Bolt (45), Clamp (44), 1/4" Locknut (46) and Lockwasher (47).
- S. Secure the Moldboard-Pivot Bar-A-frame assembly to vehicle at Clevis Frame (4) using Hinge Pins (35) and Hair Pin Cotter (28). Attach Lift Chain to Lift Arm (8) with sufficient slack to allow Moldboard to follow ground contours.

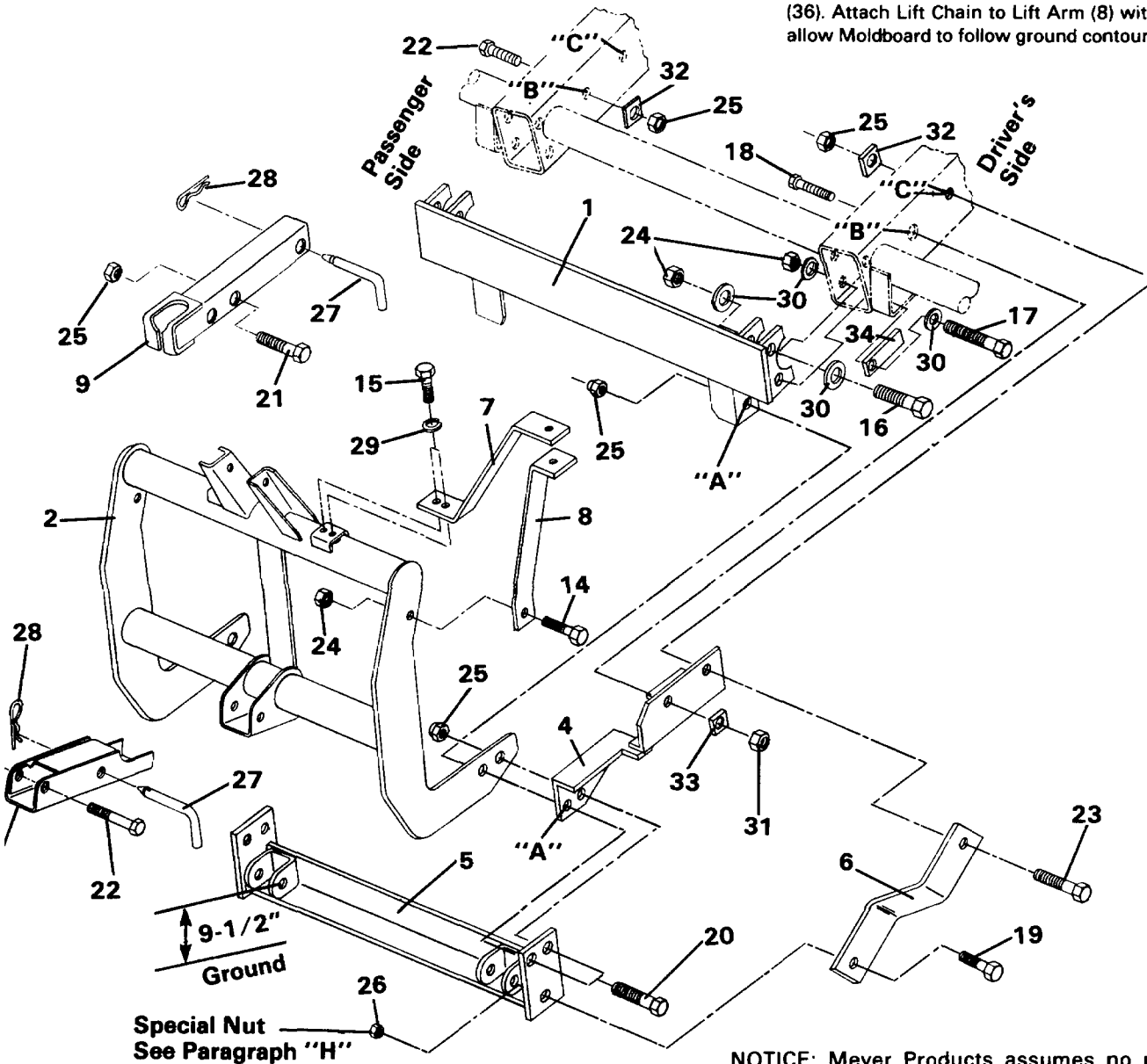

NOTICE: Meyer Products assumes no responsibility for installations not made in accordance with these instructions.