

1999-2000 FORD F-250 & F-350 SERIES UNDERCARRIAGE

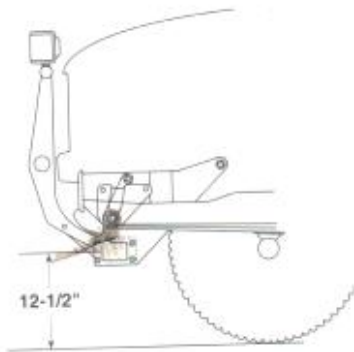

The recommended push beam height for all undercarriage assemblies is 12-1/2" from the center of the push beam to level ground. DO NOT exceed 14" in height for any undercarriage.



WARNING: Most new trucks are equipped with driver and passenger's side air bags. DO NOT remove, disable, or reposition any sensory equipment related to the safe operation of the air bags.

ALWAYS follow the vehicle manufacturer's recommendations for installing snowplowing equipment.

Failure to comply with the above warning may result in serious injury or death.



CAUTION: If your vehicle is equipped with oversize tires, they may come into contact with the undercarriage hanger plates when turning the vehicle.

The problem may be resolved by setting the steering stops on the vehicle. If this does not correct the problem, the original tires will need to be installed on the vehicle.

1. Begin the undercarriage assembly by removing the front bumper of the vehicle. There are four 1/2"-13 x 1-3/4" acorn head bolts with 1/2" washers, two nut plates and two bumper shim plates to remove. *Note: The bumper shim plate prohibits the proper mounting bolts from being installed. Either discard the plate or increase the size of the holes located on the front.*
2. Attach each HANGER PLATE (2) to the truck frame rails using two 1/2"-13 x 1-1/4" bolts and washers. Secure all bolts using a 1/2"-13 top lock nut. *Note: Loosely attach all nuts until all undercarriage plates are positioned.*
3. Rest both ZEE BRACKETS on the truck frame rail and fasten two 1/2"-13 x 1-1/2" bolts with washers to the hanger plate. Loosely tighten 1/2"-13 top lock nuts to all bolts.
4. Install one 9/16"-12 x 1-1/2" bolt with a 9/16" washer inside of the truck frame bumper bracket to the side zee bracket ear. Loosely thread a 9/16"-12 top lock nut to each bolt.
5. Mount the PUSH BEAM to the hanger plate using two 1/2"-13 x 1-1/2" bolts and top lock nuts. *Note: The proper height for the push beam is approximately 12" from the ground to the center of the beam.*
6. Remove the M12 x 1.75 x 35 (10.9 Gr.) rear spring shackle bolt with tabbed nut on the outside of the frame rail. Position each HANGER SUPPORT PLATE on the outside of the hanger plate and truck frame rail. Reattach the shackle bolt and tabbed nut. Bolt the support plate into the truck frame rail using two 1/2"-13 x 2" bolts. Secure the support plate to the hanger plate and push beam using two 1/2"-13 x 2-1/4" bolts and lock nuts.
7. Once all of the undercarriage plates have been positioned and the proper push beam height is set, proceed to tighten all top lock nuts. Reference the chart on page 4 for maximum bolt torque.
8. Replace the bumper using the existing hardware.
9. Position the LIGHT TOWER into the accepting pockets on the push beam and tighten using two 1/2"-13 x 1-1/4" bolts with washers. Secure each bolt with a 1/2" top locking nut. Mount each PLOW HEADLIGHT to the light tower with the hardware kit provided.

Complete the assembly by plugging the connectors from the lights into the connectors on the vehicle wire harness.

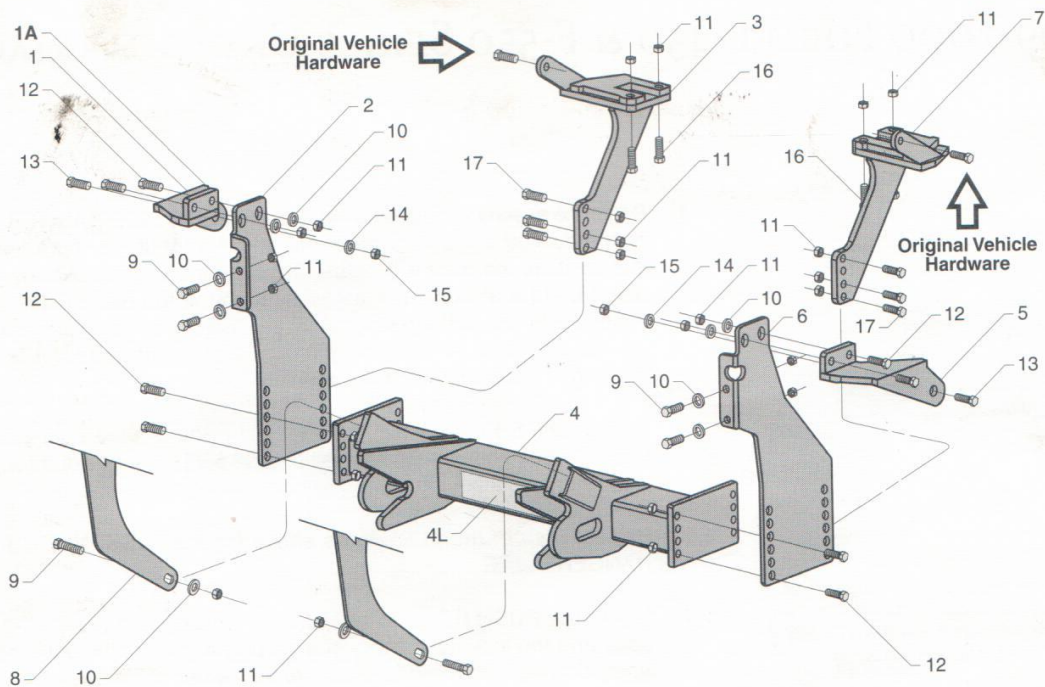

1999-2000 FORD F-250 & F-350 SERIES UNDERCARRIAGE PARTS LIST

Ref. No.	Part No.	Qty.	Part Description
1A	31035	1	1999-2000 Ford F-250 & F-350 Series Undercarriage Assembly (Nos. 1 - 17)
1	31034P	1	Passenger's Side Zee Bracket (1999-2000 Ford F-250 & F-350)
2	31008P	1	Passenger's Side Hanger Plate (1999-2000 Ford F-250 & F-350)
3	31025	1	Passenger's Side Push Beam Support Arm (1999-2000 Ford F-250 & F-350)
4	31021	1	32-1/2" Push Beam (1999-2000 Ford F-250 & F-350)
4L	61085	1	2-1/8" x 13-1/8" Push Beam Decal
5	31034D	1	Driver's Side Zee Bracket (1999-2000 Ford F-250 & F-350)
6	31008D	1	Driver's Side Hanger Plate (1999-2000 Ford F-250 & F-350)
7	31023	1	Driver's Side Push Beam Support Arm (1999-2000 Ford F-250 & F-350)
8	39032	1	Light Tower, Round Mounting Tube
9	61057	6	1/2"-13 x 1-1/4" Grade 8 YZ Hex Head Cap Screw
10	61026	10	1/2", 1-1/16" O.D., 17/32" I.D. YZ SAE Mil-Carb High-Strength Washer
11	61020	24	1/2"-13 Grade C Z Top Lock Nut
12	61055	8	1/2"-13 x 1-1/2" Grade 8 YZ Hex Head Cap Screw
13	61056	2	9/16"-12 x 1-1/2" Grade 8 YZ Hex Cap Screw
14	61059	2	9/16", 1-3/16" O.D., 19/32" I.D. YZ SAE Mil-Carb High-Strength Washer
15	61058	2	9/16"-12 Grade C Z Top Lock Nut
16	61018	4	1/2"-13 x 2" Grade 8 YZ Hex Head Cap Screw
17	61054	6	1/2"-13 x 2-1/4" Grade 8 YZ Hex Head Cap Screw
N/A	61079	1	1999-2000 Ford F-250 & F-350 Series Undercarriage Hardware Kit - Kit Includes: Nos. 9 - 17

Note: The reference numbers listed identify parts shown in the illustration above. These numbers are specific to this illustration only and do not correspond with other diagrams in the manual. Always review the part number given for proper component identification.