

PARTS & INSTALLATION INSTRUCTIONS

E-46 & E-46H MEYER ELECTRO TOUCH™

Conversion Kit with Membrane Switch

Parts List

Item	E-47		E-47H	Qty.	Description
	1 1/2" x 10" RAM	1 1/2" x 12" RAM	2" x 12" RAM		
	15532P	15534P	15535P	1	Conversion Kit E-46 to E-47
1	15758	15758	15758	1	• Power Angling Block
2	22295	22295	22295	1	•• Forged 90 Degree Elbow
3	22293	22293	22293	1	•• Coupler Male Half Low Spill
4	22294	22294	22294	1	•• Coupler Female Half Low Spill
5	07019	07021	07023	1	• Ram L.H. Includes items 6, 7, 8, 11
6	07020	07022	07024	1	• Ram R.H. Includes items 6, 7, 8, 10
7	05810	05437	05752	1	•• Ram
8	22144	22144	22144	1	•• Hose Ass'y. 1/4 x 45" Lg.
9	21857	21857	21857	1	•• 1/4 x 90 Degree Elbow
10	15846	15846	15846	1	•• Coupler 1/4
11	22292	22292	22292	1	•• Female Half
12	22291	22291	22291	1	•• Male Half
13	15764	15764	15764	1	• Harness and Fuse Ass'y.
	08671	08671	08671	1	• Hardware Bag
14	15669	15669	15669	1	•• Weather Plug - Solenoid Wires
15	22143	22143	22143	1	•• Coupler Cap
16	22142	22142	22142	1	•• Coupler Plug
17	21856	21856	21856	4	•• Cap Screw 5/16 - 18 x 1 1/2"
	15765	15765	15765	1	• Hardware Bag
18	07273	07273	07273	1	•• Tap Connector
19	15102	15102	15102	1	•• Bolt 5/16 - 18 x 1 1/2" Gr. 2
20	15427	15427	15427	1	•• Light Switch Bracket
21	15673	15673	15673	1	•• Membrane Switch Bracket
22	15675	15675	15675	1	•• Clamp Plate
23	15676	15676	15676	1	•• Backup Plate
24	20312	20312	20312	2	•• Locknut 1/4 - 20
25	20841	20841	20841	2	•• S. Tapping Scr. #12 - 14 x 1/2" PanHD.
26	20863	20863	20863	2	•• Machine Screw 1/4 - 20 x 1" RND. HD.
27	21398	21398	21398	2	•• S. Tapping Scr. 1/4 - 14 x 3/4"
28	21400	21400	21400	1	•• Washer INT/Ext Tooth 5/16
29	21832	21832	21832	1	•• Bushing - Split
30	21953	21953	21953	1	•• Decal - Danger (Mount on Dashboard)
31	22091	22091	22091	1	•• Decal - Lights
32	22154	22154	22154	1	•• Membrane Switch
	08642	08642	08642	1	• Kit Bracket (Floor Mount)* Optional
33	15677	15677	15677	1	•• Bracket Floor
34	21398	21398	21398	4	•• Hex Head Self Tapping Screw 1/4 - 14 x 3/4"
35	20325	20325	20325	4	•• Lockwasher 1/4"
	08363	08364	08364	1	• Hardware Bag (P.A. Rams)
36a	20146	————	————	4	•• Bolt H 5/8 - 11 x 3 1/4" Gr. 5
36b	————	20147	20147	4	•• Bolt H 5/8 - 11 x 3 1/2" Gr. 5
37	20309	20309	20309	4	•• Locknut 5/8 - 11
38	————	20357	20357	2	•• Flatwasher 5/8

Parts indented are included in the carton, bag or assembly under which they are indented.

Meyer Products reserves the right, under its continuing product improvement program, to change construction or design details, specifications and prices without notice or without incurring any obligation.

GENERAL INFORMATION

Check contents against the parts list to determine all are correct and included. When ordering parts, furnish Part No., Name and Description, Type of Hydraulic Unit and Moldboard Size.

SAFETY PRECAUTIONS should be used when **ELECTRO TOUCH™** is in **OPERATION** and plow is in a **RAISED** position. **Lower plow to ground when vehicle is PARKED.**

OVERHAUL and **SERVICE INFORMATION** is covered on separate Instructions.

CAUTION: Route all Cables away from moving engine parts, Manifolds, and sharp steel metal.

Follow these instructions explicitly. Warranty does not apply to a Meyer product which has been negligently or improperly assembled or installed.

INSTALLATION INSTRUCTIONS

- A. Remove E-46 Unit from Vehicle. Reference Form 1-523 for removal of End Plate and Installation of Power Angling Block (1).
- B. Install Coupler Cap (15) and Plug (16) onto Power Angling Block (1) per Figure 2.
- C. Install E-47 Lift Assembly to Lift Frame with the Electric Motor toward the right hand side (Passenger-side); attach the lift ram in the inner hole of the Lift Arm (unless otherwise instructed in vehicle mounting instructions) as per illustration. On HM-9 and HM-10 Snow Plows only, install the E-47H Lift Assembly with the Electric Motor toward the right hand side (Passenger-side); attach the lift arm in the outer hole of the Lift Arm.

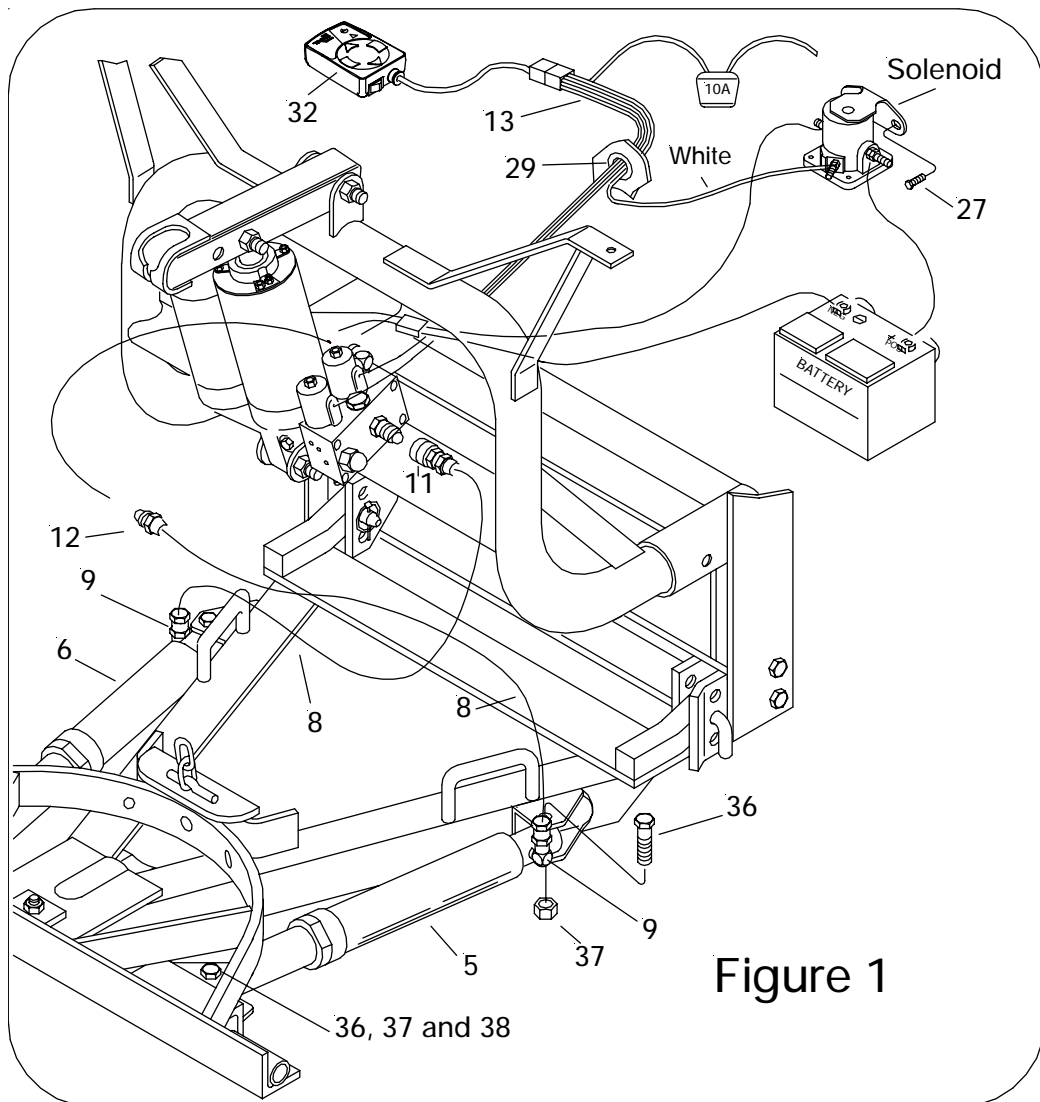

D. Remove old Switch Assy. from vehicle. Reference form 1-521.

E. Choose a convenient location for the control switch. If the desired location is the dashboard, install Bracket (21) by drilling two holes in the dashboard and secure using Round Head Machine screws (26) and Locknuts (24). Install back-up Plate (23) behind dash for added stiffness. See Illustration. Also apply DANGER Decal (30) to dashboard.

F. To mount control to the shift lever, use Bracket (21), Clamp Plate (22), Round Head Screws (26), and Locknuts (24). See Figure 3.

Note: Modification of Bracket (21) may be necessary when installed on certain shift levers.

G. Remove old single switch harness from vehicle. Route new Harness (13) thru Bushing (29) (where previous 7/8" diameter hole is located in firewall) and radiator support panel. Be certain to route all wiring around hot or moving engine parts, and any sharp sheet metal. Protection must be provided to guard against wire damage at these points. All excess or loose wire must be neatly secured using wire ties. Fused lead from Wiring Harness (13) must be attached to terminal in fuse panel that is activated only when the ignition key is "on." The three colored wires in Harness (13) must be routed through grill to E-47 unit.

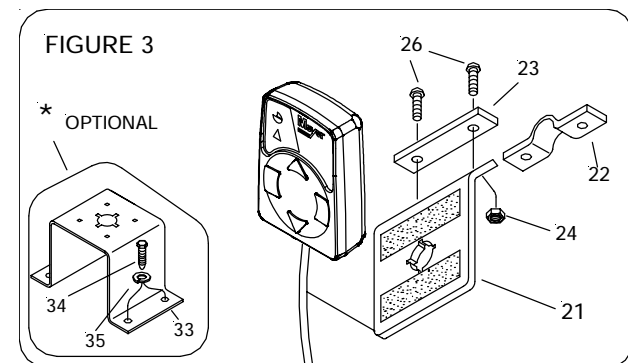
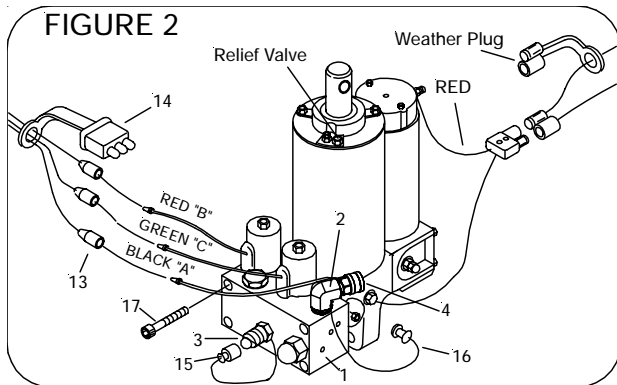

H. Attach small black wire with white stripe from harness (13) to small terminal on Starter Solenoid. Per Illustration.

POWER ANGLING CYLINDERS

Attach Power Angling Cylinders (5 & 6) to Sector and A-Frame using bolts (36) and locknuts (37). When using 1-1/2" x 12" rams also install washer (38) at Piston end of Rams (5 & 6).

Make certain Ram (5) with hose (8) and Male-half coupler (12) is on Driver-side and Ram (6) with Hose (8) and Female-half coupler (11) is on the Passenger-side.

Note:

When the Moldboard Assembly is removed from the vehicle, to prevent contamination to the Couplers and Hydraulic system, the L.H. and R.H. Power Angling Hoses must be re-attached by plugging the coupler (11, 12) together. Also where the power angling hoses were uncoupled at the hydraulic unit, attach Coupler Cap (15) and Plug (16) to the female and male halves of coupler.

Power Angling Cylinders furnished with the ELECTRO TOUCH™ have been factory filled with proper amount of fluid. If for any reason it is necessary to add fluid to Reservoir or to bleed the Power Angling Cylinders, proceed as follows.

- Remove Relief Valve from Reservoir (Top Cap) to add fluid during charging and bleeding.
- Temporarily loosen both hose connections at the R.H., L.H. Power Angling Cylinders. Base end of Cylinder must be higher than Rod end to enable trapped air to escape.
- Angle the Plow in both directions until fluid leaks out at both points in a steady flow.
- Retighten the hose connections.

NOTE:

Proper fluid level is 1-1/2" below filler hole. It must be checked with the lift arm fully retracted (down).

- When Lift Unit is removed, protect the sockets from corrosion by using the Weather Plugs as before. Additional Weather Plug (14) for solenoid wires has been provided.

WARNING:

Lift arm extends beyond bumper of vehicle. To Minimize damage from a front-end collision, lift arm should be removed from vehicle when snow plow is removed.