

## SUBJECT: 10514 LIFT ARM

In our continued efforts to improve distributor profit margins and reduce inventory through consolidation of part numbers and improved product quality, we have made a change to our 10514 Lift Arm used on all of our EZ Custom, EZ Mount Classic Systems.

As a result, this product enhancement will standardize our Lift arm allowing all Electro-Lift® hydraulic units whether 6" or 8" stroke units to be used on all of our EZ Mount Custom, EZ Mount Classic Systems. This will be a running change and will NOT obsolete any inventory at the factory or in the field.

The change is already in place at the factory. Updated 10514 Lift Arm will be seen in cartons packed after September 26, 2005.

To modify an existing 10514 Lift Arm to be used on a EZ Mount Custom or EZ Mount Classic to accept an "H" (8" stroke) hydraulic unit another hole must be drilled in the end of the lift arm. Per illustration

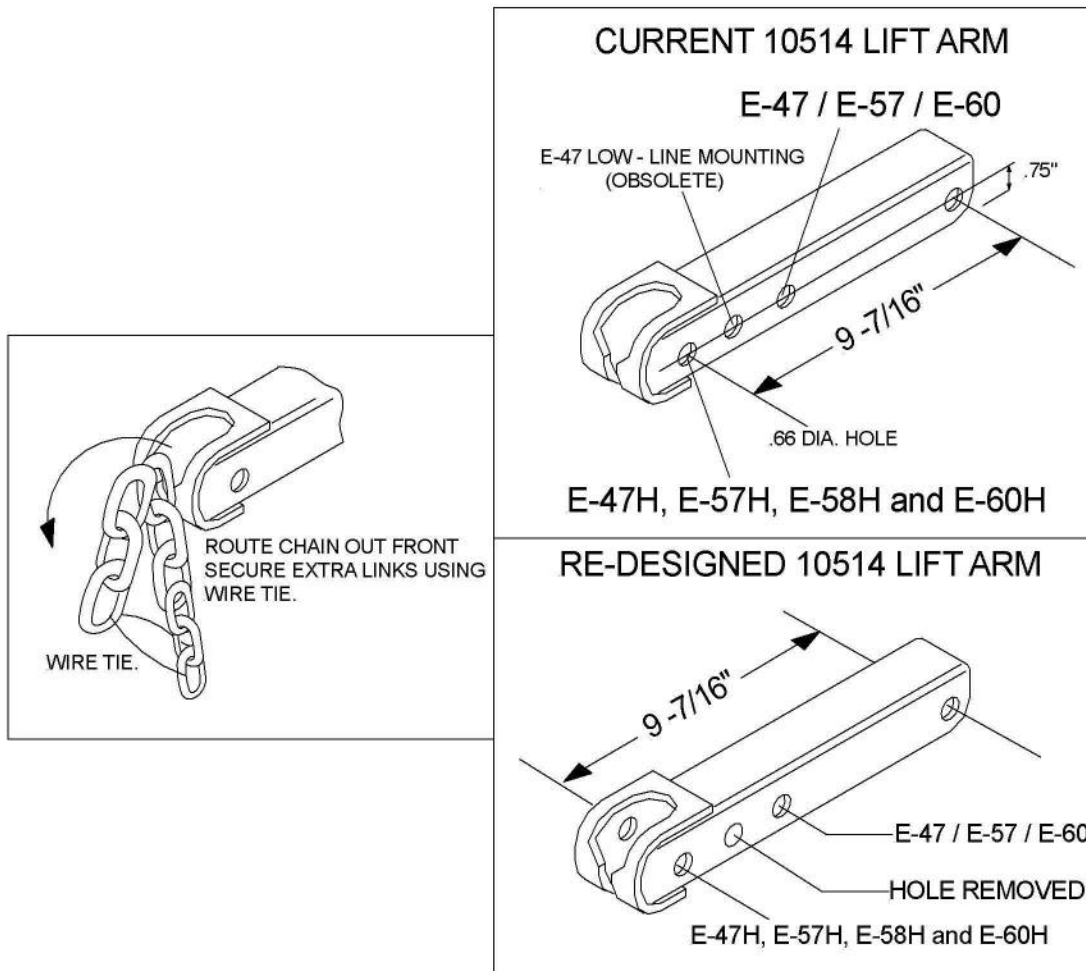

We are very pleased to announce this change and will continue to look for ways to reduce costs while improving product quality for our distributors in the future!

	Route To:			
Initial	President/Owner	Sales Manager	Service Manager	Parts Manager