



## WESTERN PRODUCTS

7777 NORTH 73RD STREET

P.O. BOX 23045

MILWAUKEE, WISCONSIN 53223

**UniMount**<sup>SYSTEM</sup>



A DIVISION OF DOUGLAS DYNAMICS, L.L.C.

Refer to the current  
selection list for  
minimum vehicle  
recommendations and  
ballast requirements.



**NOTE:** This symbol designates a change made in the instructions since the last revision date of September 6, 1995.

## Vehicle Installation Instructions and Parts List

Model 2365

Mount Assembly Box No. 62370

Toyota 4 x 4 Tacoma

1995 & Later

Hydraulics Box No. 56355

Harness Kit No. 61555

January 17, 1997

## Mount Assembly Box No. 62370 PARTS DIAGRAM & LIST

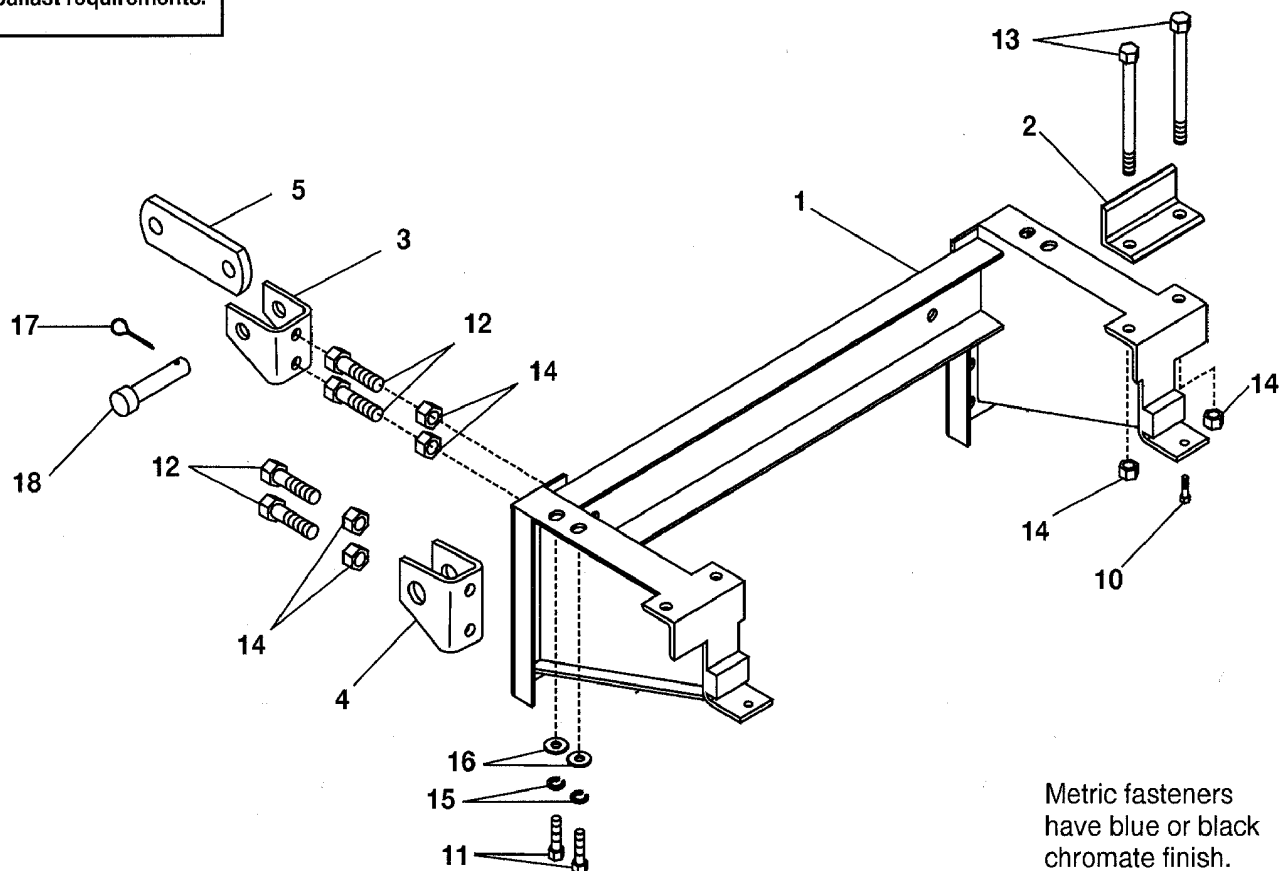

Metric fasteners  
have blue or black  
chromate finish.

ITEM	PART NO.	QTY.	DESCRIPTION
1	62375	1	MOUNT FRAME 2365
2	62327	2	CLAMP PLATE
3	61916	2	LINK ARM LUG
4	61917	2	COUPLING LUG
5	61412	2	LINK ARM
10	93172	2	3/8-16X1-1/2 HXW TRTS BP
11	95071	4	M12X1.25X30 HX CS G8.8
12	90100	8	1/2-13X1-1/2 HX CS G5 ZYC
13	90110	4	1/2-13X5 HX CS G5 ZP
14	91335	12	1/2-13 PT HX LK NUT NYIS ZYC
15	95174	4	M12 SP LK WASHER
16	91105	4	1/2 PLAIN WASHER TY A STD ZYC
17	91911	2	5/32X1-1/2 COTTER PIN ZYC
18	93062	2	RIVET 3/4"X3-1/4" G5 ZYC
<b>NOT SHOWN</b>			
	62316	1	40MM ID X 4" LG CONVOLUTED TUBE
	56080	1	DASH BRACKET
	61880	1	CONTROL BRACKET STOOL
	90661	4	#10-24X3/8 SL HXW TCTS TY D ZP
	61536	5	CABLE TIE - LONG
	62387	1	BOLT BAG ASSY (62370)

### Abbreviations

ASSY	Assembly
BP	Black Phosphate
CS	Cap Screw
G	Grade
HX	Hex
HXW	Hex Washer Head
ID	Inside Diameter
LG	Long
LK	Lock
M	Metric
MM	Millimeter
NYIS	Nylon Insert
PT	Prevailing Torque
SL	Slotted
SP	Spring
STD	Standard
TCTS	Thread Cutting Tapping Screw
TRTS	Thread Rolling Tapping Screw
TY	Type
ZP	Zinc Plate
ZYC	Zinc Yellow Chromate

# **Mount Box No. 62370** **INSTALLATION INSTRUCTIONS**

Recommended Fastener Torque Chart (Ft.-Lb.)			
Size	SAE Grade 2	SAE Grade 5	SAE Grade 8
1/4-20	6	9	13
5/16-18	11	18	28
3/8-16	19	31	46
3/8-24	24	46	68
7/16-14	30	50	75
1/2-13	45	75	115
9/16-12	66	110	165
5/8-11	93	150	225
3/4-10	150	250	370
7/8-9	202	378	591
1-8	300	583	893
Metric Grade 8.8 (Ft.-Lb.)			
Size	Torque	Size	Torque
M 6	7	M 12	60
M 8	17	M 14	95
M 10	35	M 16	155
These torque values apply to mount assembly fasteners except those noted in the instruction.			

**IMPORTANT:** Read instructions before assembling. Bolts should be finger tight until instructed to tighten according to the torque chart. Use standard methods and practices when attaching snowplow including wearing safety glasses during cutting, drilling, and welding.

Parts to be installed are furnished in mount box.

## **AS VIEWED FROM DRIVER-SIDE**

### **MOUNT FRAME:**

1. Remove tow hook, tie-down bracket and splash pan. Retain all removed parts and reinstall whenever mount is removed from vehicle.
2. Position mount frame to bottom side of vehicle frame rails aligning two slots on each side with tow hook holes. Attach each side of mount frame to vehicle frame tow hook holes with two 12mm x 30mm cap screws, 12mm lock washers and 1/2" flat washer to slots.

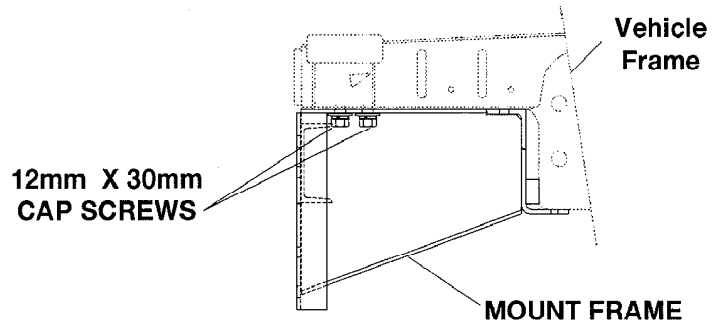

3. Place a clamp plate, with upright leg towards front of vehicle, on top of each vehicle frame rail aligning holes in clamp plate with rear holes in mount frame. If lower radiator hose is close to or touching clamp plate (typically on 4 cylinder engines), install furnished convoluted tubing to protect lower hose. Secure tubing with a cable tie. Attach both clamp plates by inserting four 1/2" x 5" cap screws from top through clamp plate holes and holes in mount frame angle. Secure with 1/2" lock nuts.

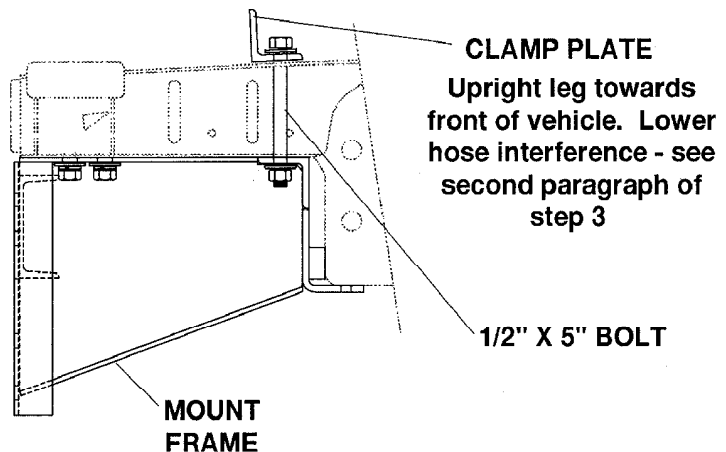

### **TIGHTEN ALL BOLTS TO CORRESPONDING TORQUE CHART VALUES.**

4. Drill two 1/4" holes in frame cross rail using the tabs on rear of mount frame as a template. Attach with a 3/8" x 1-1/2" self tapping screw in each hole.

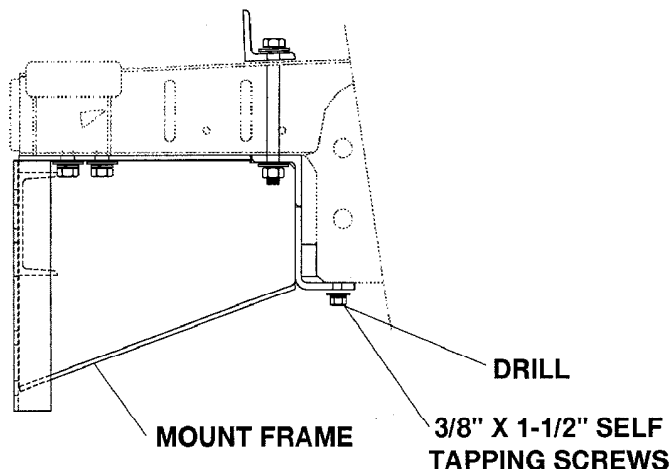

### COUPLING LUGS:

1. Position the coupling lugs (1" diameter holes) against the lower set of holes in the front of the mount frame. (Turning lugs upside down changes height by 1".)

During installation, allow for drop in vehicle height when weight of plow is added. Final coupling lug hole center to level surface distance should be 9-1/2" to 10-1/2" with plow attached and resting on the level surface. (See Coupling Lug Height Check Instructions found on page 8 of these instructions.)

2. Secure each coupling lug with two 1/2" x 1-1/2" bolts and lock nuts.

### LINK ARM LUGS:

1. Install link arm lugs (3/4" diameter holes) so angled side is in the same position as the angled side of the coupling lugs. Position the link arm lugs to the upper holes on the front of the cross channel of the mount frame.

**NOTE:** Centers of coupling lug holes to center of link arm lug holes should be 5-1/2".

2. Secure each link arm lug with two 1/2" x 1-1/2" bolts and lock nuts.

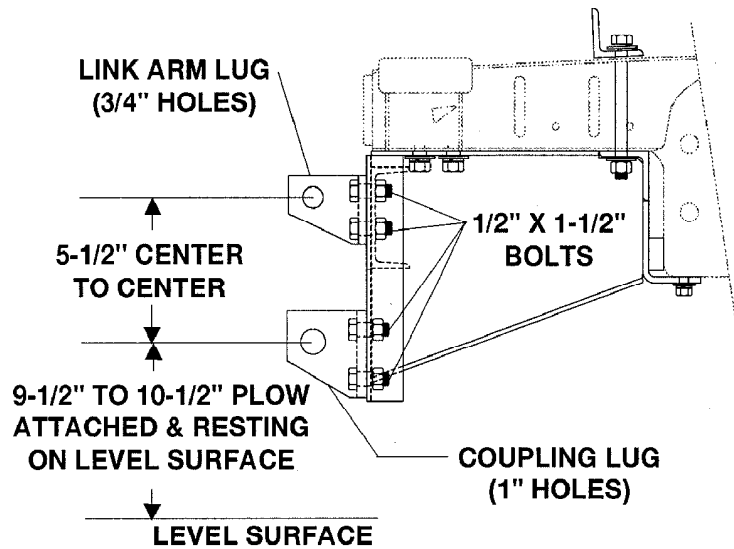

### TIGHTEN ALL BOLTS TO CORRESPONDING TORQUE CHART VALUES.

### LINK ARMS:

Attach link arms, chamfered side of holes towards center of vehicle, to upper pair of spreader lugs using one 3/4" x 3-1/4" grade 5 rivet and cotter pin on each side.

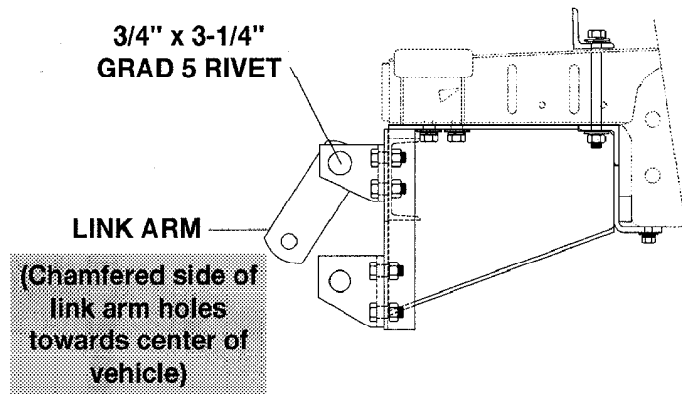

### HARNESS KIT SELECTION:

For DUAL Type 2B/2D headlamps - use Box No. 61550 Headlamp Kit 12-Pin and 61555 Harness Kit 2B/2D 12-Pin - B.

**NOTE:** After using the snowplow for 5 to 10 hours, retorque all mount assembly fasteners.

Solenoid Control installation instructions are on page 4 of these instructions.

Vehicle underhood and installation installation start on page 5 of these instructions.

## Solenoid Control INSTALLATION INSTRUCTIONS

1. Align dash bracket hole shown in diagram to end hole of control bracket.

**NOTE:** Top flange of control bracket may be reversed in dash bracket from position shown in diagram.

Attach with one #8 x 3/8" hex head thread cutting screw and lock washer on each side.

2. Use top holes in dash bracket (see diagram) as a template to drill a 9/64" hole in each side of control bracket. Secure dash bracket to control bracket with a second screw and lock washer in each side.
3. Secure solenoid control to control bracket with two #8 x 5/8" hex head tapping screws.
4. Move seat forward. Temporarily hold control assembly on top of control bracket stool and locate assembly on curb-side of floor tunnel so that it does not interfere with the operation of vehicle controls. Mark location of stool on tunnel and floor, and dash bracket on stool.
5. Remove control bracket from dash bracket. Use dash bracket as a template to drill four 5/32" holes in stool.
6. Place stool in marked location. Use stool as a template to drill two 1/8" holes in tunnel and two 1/8" holes in floor.

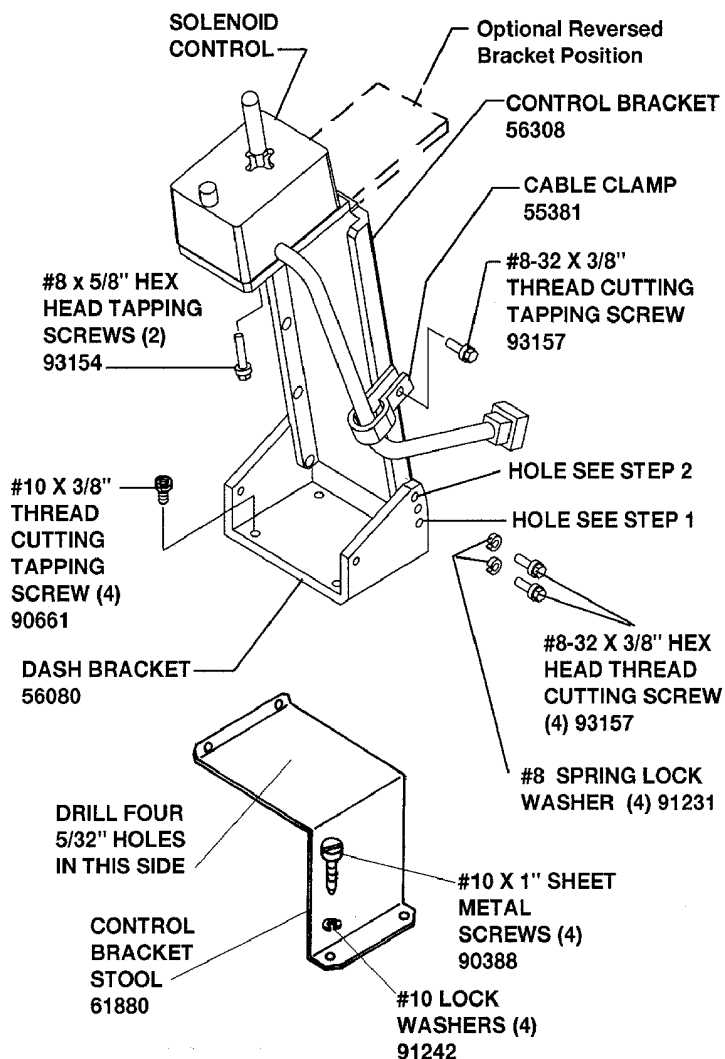

**CAUTION:** Check for clearance before drilling holes.

Secure stool to tunnel and floor with four #10 x 1" tapping screws and lock washers.

7. Secure dash bracket to top of stool with four #10 x 3/8" thread cutting tapping screws (furnished in mount box).
8. Reassemble control bracket to dash bracket. Bend top flange of control bracket to desired position.
9. Secure harness to control bracket with cable clamp and one #8 x 3/8" hex head thread cutting screw.



**SAFETY NOTE:** Whenever you see this symbol, it notes a **SAFETY WARNING**. To avoid serious injury to yourself or others, follow all warnings.

## Vehicle Underhood INSTALLATION INSTRUCTIONS

### VEHICLE HARNESS AND MOTOR RELAY

Except as noted, parts to be installed are found in the hydraulics box.

### HARNESS, SOLENOID CONTROL & MOTOR RELAY INSTALLATION DIAGRAM

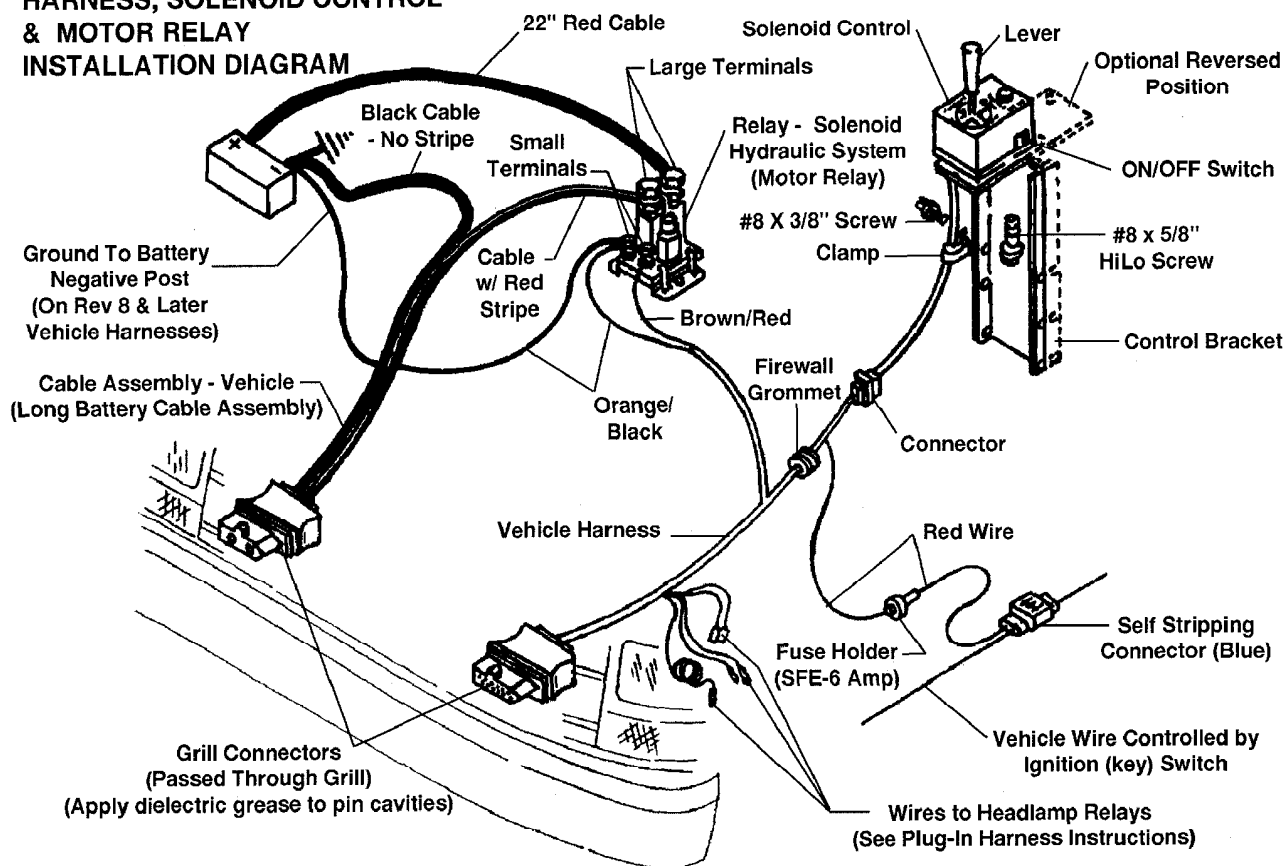

**CAUTION:** To prevent corrosion on all underhood electrical connections, use dielectric grease to fill receptacles and lightly coat ring terminals and blades before assembling, or lightly coat the connections after assembling.

1. Identify wires for the parking lamp on the driver-side and the turn signals on both sides of the vehicle. Attach a black self-stripping bullet receptacle connector (found in harness kit) to each of these three wires.
2. Remove **NEGATIVE** battery cable from battery.



**WARNING:** Electrical shock hazard. Disconnect battery before beginning electrical installation.

3. Find a location for the motor relay where it will be protected from road splash and will be within 18" of the vehicle primary battery.

**NOTE:** Motor relay terminals must be up or horizontal.

Using the motor relay mounting plate as a template, drill two 9/32" holes, and mount motor relay to holes using 1/4" x 3/4" bolts, flat washers, and lock nuts.

4. Route 22" red battery cable between a large motor relay terminal and the **POSITIVE** battery terminal taking care to avoid sharp edges, and hot or moving parts. Attach cable to motor relay terminal with a lock washer and 5/16"-24 jam nut. Attach cable to battery **POSITIVE** terminal with existing terminal fastener.
5. Stretch rectangular openings of plug cover straps (found in harness kit) over grill connector ends of long battery cable assembly (found in hydraulics box) and vehicle harness (found in harness kit). Place plug covers over molds on harnesses.

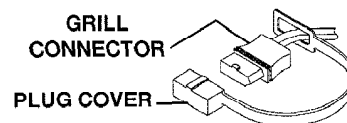

6. Find a location in the vehicle grill on the battery side for mounting the battery cable grill connector. The best location is at least 10-1/2" from the center of the grill and at a convenient height for connecting the plow plugs. Allow grill connector of each harness to hang out in front of grill. Allow enough cable so it is easy to mate and remove connector. Secure with long cable ties (found in mount box).
7. Route battery cable through the grill at the selected location and through or around the radiator bulkhead to motor relay taking care to avoiding sharp edges, and hot or moving parts.
8. Attach cable with red stripe to the unused large terminal on the motor relay, and secure it with a lock washer and 5/16"-24 jam nut.
9. Route the battery cable without a stripe directly to the NEGATIVE battery terminal (carefully separate the two cables as needed to reach battery). DO NOT attach cable to battery at this time.
10. Find a location in grill on driver-side for mounting the vehicle harness (similar position to battery cable mount). See Steps 6 & 7 above for how to mount. Route vehicle harness through grill and around, or through radiator bulkhead (drill 5/8" hole if needed) into engine compartment.
11. Route the wires that break out of the vehicle harness to the area behind the driver-side headlamp. Route rest of harness to the firewall. Drill a 5/8" hole through the firewall in a convenient location away from hot or moving engine parts.

**IMPORTANT:** All vehicles with DRL's — insert fuse holder on pink wire of DRL Adapter Kit (P.N. 61584) through firewall first. Route end of pink wire with receptacles to area of driver-side headlamp.

Feed vehicle harness fuse holder through hole and then feed the plastic connector and harness through to the cab. Disassembly of the fuse holder may make it easier to pass through 5/8" hole.

12. Route brown/red and orange/black (early revision harnesses have brown/red and black/orange wires) wire loom to motor relay. Early revision harnesses must be modified if CabCommand hand-held control is being installed. (See instructions furnished with CabCommand control.)

Attach the brown/red and orange/black (early revisions black/orange) wires small ring terminals to separate small terminals on motor relay using a lock washer and #10-32 nut for each connection.

13. Route the orange/black wire with 3/8" ring terminal to NEGATIVE battery terminal. DO NOT attach wire to battery at this time.
14. Inside the cab, route vehicle harness connector to solenoid or CabCommand control and couple the connectors together.

15. Reconnect vehicle ground cable to NEGATIVE battery terminal. Attach the hydraulic unit black battery cable and orange/black wire terminal to the negative clamp bolt.

16. Locate an accessory wire capable of carrying 7 amps in addition to existing circuit loads and controlled by the ignition (key) switch. Route the vehicle harness SFE-6\* fuse holder red wire to this location and trim off any excess length of wire (keep fuse holder in system). If used, DRL pink wire requires .4 amps.

Open blue self stripping connector and place the end of the red wire against the inner groove stop (end of wire must not extend from the closed connector), and the accessory wire in the outer groove. Close connector over the wires using a pliers and snap the locking tab in place. Repeat with DRL pink wire.

\*Early style harnesses have a 10-amp fuse which must be replaced with SFE-6 fuse for CabCommand control.

**REMINDER:** To prevent corrosion on all underhood electrical connections, use dielectric grease to fill receptacles, including grill connectors, and lightly coat ring terminals and blades before assembly or lightly coat connections after assembly.

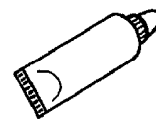

**DIELECTRIC  
GREASE -  
PN 56099 or PN 49326**

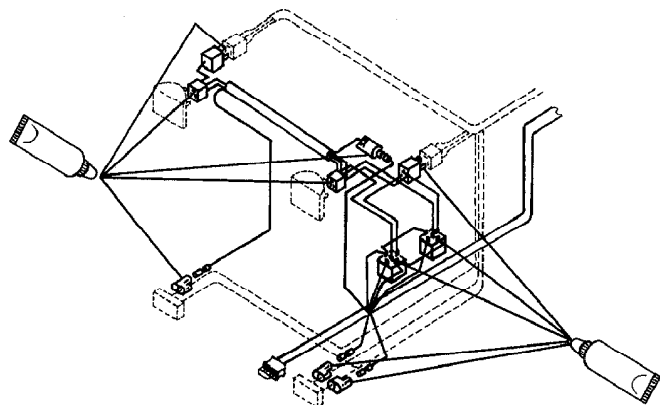
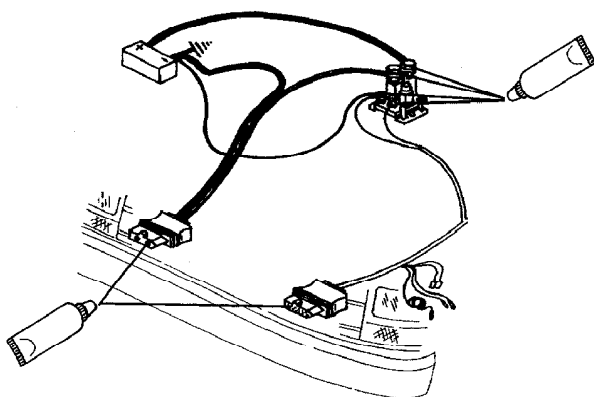



## VEHICLE HEADLAMP WIRING DIAGRAM – TYPE – B

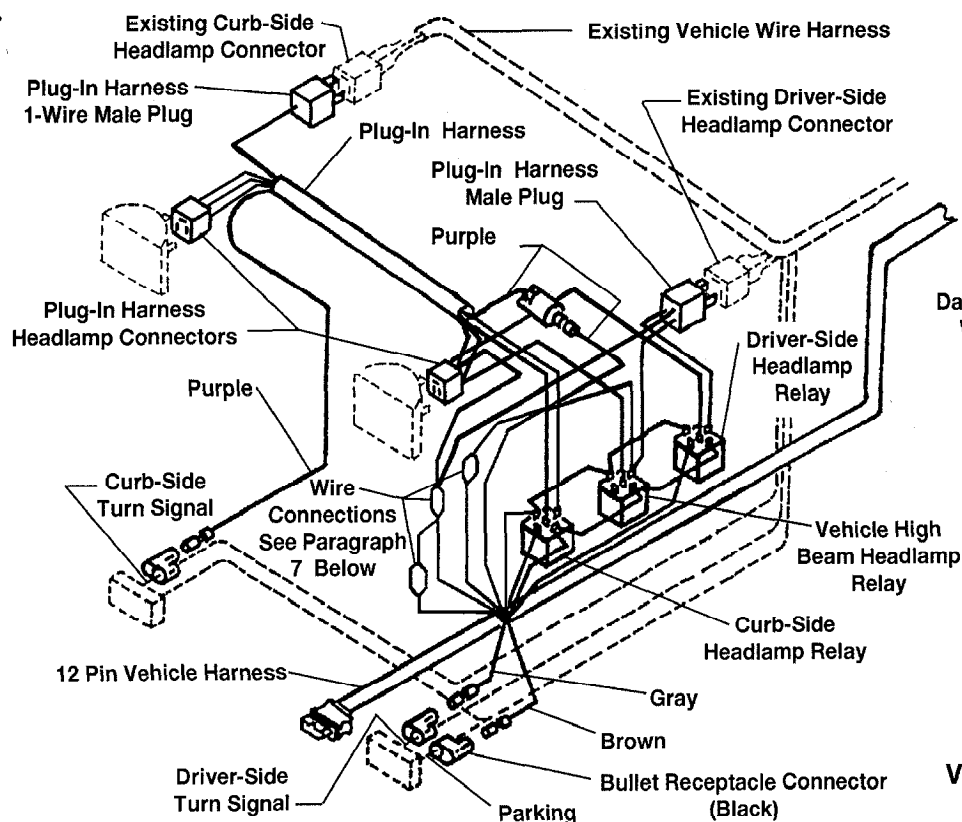

## HEADLAMP RELAY WIRING DIAGRAM Type – B

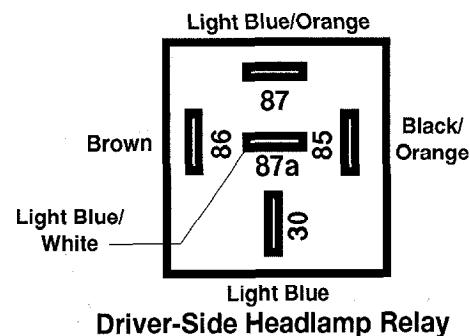
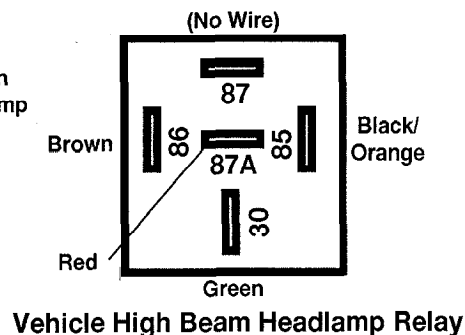
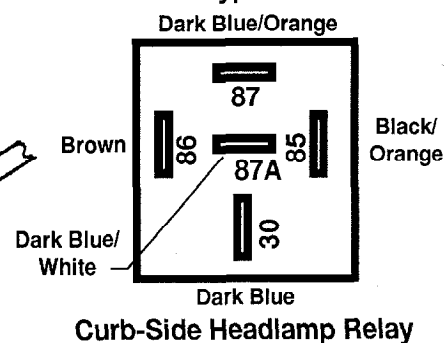

## VEHICLE HEADLAMP PLUG-IN HARNESS & HEADLAMP RELAYS

**REMINDER:** Lubricate all receptacles and blades with dielectric grease before assembling.

1. In the engine compartment behind the driver-side headlamp, insert wire bullets from vehicle harness into black bullet connectors (installed in step one of previous section) as follows:
  - Brown wire to parking lamp wire on driver-side.
  - Gray wire to left turn signal wire on driver-side.
2. At the vehicle driver-side headlamp, remove the connector from the headlamp and couple matching connector with plug-in harness 3-wire male plug (plug-in harness found in harness kit). Attach plug-in harness headlamp connector to headlamp terminals.
3. Route other end of plug-in harness along radiator bulkhead or over radiator shroud to curb-side headlamp. Remove headlamp connector and couple matching connector with plug-in harness 1-wire male plug. Secure with a cable tie. Attach plug-in harness headlamp connector to headlamp terminals.
4. On the curb-side, insert purple wire bullet from plug-in harness into vehicle turn signal black bullet connector installed in step one of the previous section.
5. At the driver-side headlamp, insert the purple wire bullet from the vehicle harness into the purple wire receptacle on the plug-in harness.
6. At driver-side headlamp, connect vehicle and plug-in harness wires with receptacles to the three headlamp relays (found in harness kit) as shown in the above diagram. Use cable ties (found in harness kit) to secure relays and prevent accidental grounding of connections.
7. Plug the following blades into receptacles: black/white wire blade to black/white wire receptacle, yellow and orange blade to black and black/white wire receptacle, green wire blade to white wire receptacle.
8. Place grommet around vehicle harness and insert into firewall hole (also put a grommet in the radiator bulkhead hole if one was drilled). Use cable ties (found in harness kit) to secure harnesses, relays and wires away from sharp edges, and hot or moving engine parts and to prevent accidental grounding of connections.
9. Insert terminals of furnished turn signal relay into flasher mounting slots marked "B" and "L" on the back side of the fuse panel. Remove fuse panel bolts to access flasher.
10. Lubricate terminal cavities of both grill connectors with dielectric grease. Give the dielectric grease tube to vehicle owner for future lubrication of grill connectors.

## OPERATIONAL TESTS AND ADJUSTMENTS

## OPERATIONAL TESTS AND ADJUSTMENTS

Mount plow assembly to vehicle. (See label on back of blade or owner's manual for mounting instructions.)

### Filling Hydraulic Unit

1. Push lift channel all the way down.
  2. Remove fill plug and fluid level plug.
  3. Fill unit through fill plug hole until fluid runs out of fluid level plug hole. Replace both plugs.  
Use: automatic transmission fluid (ATF) Dexron III to -10° F (-23° C),  
WESTERN® High Performance Fluid to -25° F (-32° C),  
Texaco 1537 Aircraft Hydraulic Oil for temperatures below -25° F (-32° C).
  4. Turn ignition (key) switch to the ON or ACCESSORY position.
  5. Turn the control ON/OFF switch to the ON position.
  6. Move control lever to angle left and angle right several times to remove air from Hydra-Turn® rams. **DO NOT raise blade as this may cause pump cavitation.**
  7. Refill unit with fluid following the procedure in step three of this section.
  8. Move the control lever as indicated on label to control the plow. Raise and lower plow several times to remove air. Recheck fluid level according to step three of this section.
- Capacity: Solenoid ISARMATIC® Mark IIIa reservoir 1-3/4 quarts  
Equipped with 10" Hydra-Turn rams 2-3/8 quarts

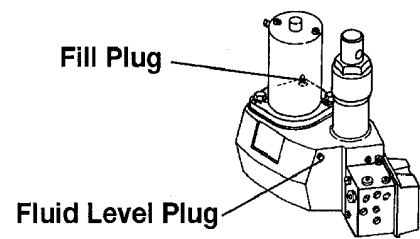

**WARNING:** To prevent accidental movement of plow, always turn the solenoid control to the OFF position when not using the mounted plow.

### Blade Drop Speed Adjustment

The quill on the top rear of the valve manifold (see diagram) adjusts blade drop speed.

Turn quill IN (clockwise) to decrease drop speed.

Turn quill OUT (counterclockwise) to increase drop speed.

**NOTE:** Turning quill too far in can slow raise time.

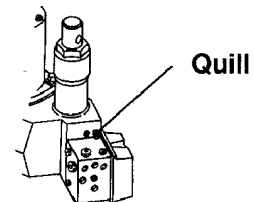

### COUPLING LUG HEIGHT CHECK

### COUPLING LUG HEIGHT CHECK

1. Mount plow to vehicle (see label on back of blade or owner's manual for mounting instructions). See selection list for recommended ballast requirements.
2. Lift plow and move vehicle a minimum of 10 feet. Lower blade.
3. After step 2, with: blade on level surface,  
slack in lift chain,  
rear ballast located behind rear wheels,  
the center of the coupling lug holes (hitch pin shaft) to level surface should measure 9-1/2" to 10-1/2".  
To obtain height, both coupling lugs and link arms may be turned over to change the height by 1".

**NOTE:** Coupling height must be 9-1/2" minimum to allow stand to be pinned to lift frame.

4. Adjust chain slack with plow mounted to vehicle, and lift channel pushed all the way down. To adjust, remove chain from hook. Straighten chain and pull tight. Rehook it to the lift channel. After it is hooked, it will have the correct amount of slack for blade "float." DO NOT remove chain from lift channel when removing plow from vehicle.

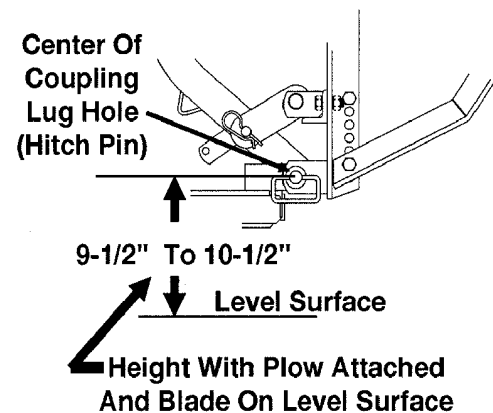



**FINAL HYDRAULIC INSPECTION**

1. Make sure all fasteners and hydraulic and electrical connections are tight.
2. Check ram packing nuts for oil leakage. If any leakage is observed, tighten the packing nut 1/4 turn after you feel the nut contact the packing. Do not over tighten — over tightening affects cylinder operation and shortens the life of the packing. A short period of normal operation will allow chevron packings to become saturated,

and leakage will normally stop.

**VEHICLE LIGHTING CHECK**

1. Check the operation of vehicle and plow lights with plow mounted to vehicle and both plow plugs connected.

**Turn signals and parking lamps**

Parking lamps ON	Both vehicle and plow parking lamps should be on at the same time.
Right turn signal ON	Both vehicle and plow right turn signal lamps should flash at the same time.
Left turn signal ON	Both vehicle and plow left turn signal lamps should flash at the same time.

**Headlamps**

Move vehicle headlamp switch to the ON position. Connecting and disconnecting the 12-pin plow plug from the grill connector should switch between vehicle and plow headlamps as follows:

12-pin plow plug DISCONNECTED	Vehicle headlamps should be on, plow headlamps off.
12-pin plow plug CONNECTED	Plow headlamps should be on, vehicle headlamps off.

Dimmer switch should dim whichever headlamps are operating. The high beam indicator on the dash should light when either set of headlamps is on high beam.

**Solenoid Control or CabCommand Control**

12-pin vehicle harness revision 8 and later or

12-pin vehicle harnesses – earlier revisions modified for CabCommand Control:

The control indicator light should light whenever the control ON/OFF switch and the ignition (key) switches are both turned ON. The plow plugs do not need to be connected to the grill connectors.

**Solenoid Control used with earlier revision harnesses**

12-Pin revision 5, 6, or 7 vehicle harnesses:

The control indicator light should light whenever the control ON/OFF switch and the ignition (key) switches are both turned ON and the plow plugs are connected to the grill connectors.

12-pin vehicle harnesses – all earlier revisions:

The indicator light will also light when the control and ignition (key) switches are on the plow plugs are disconnected. If the parking lights are turned on (with plug plugs disconnected), the indicator light will go out.

2. Connect plow plug to grill connector. Raise plow and aim plow headlamps according to SAE J599 Lighting Inspection Code (See Service Bulletin SP 608) and any applicable federal, state, or local regulations.
3. Check aim of vehicle headlamps with plow removed.
4. When plow is removed from the vehicle, install plug covers on grill connectors and insert the plow plugs into the boot on the hydraulic unit.

**NOTE: After using the snowplow for 5-10 hours, retorque all mount assembly fasteners.**

**Solenoid Control** — 12-Pin Vehicle Harness Revision 8 & later - The control indicator light will light whenever the control ON/OFF switch and the ignition (key) switch are both turned ON. The plow plugs and grill connectors do not need to be connected for the control light to be on.

# Unimount<sup>®</sup> SYSTEM

**Wiring Diagram  
Harness Type – B  
w/ 12 Pin Headlamp Kit  
& SAE Headlamp Types 2B/2D  
With 12-Pin Vehicle Harness**

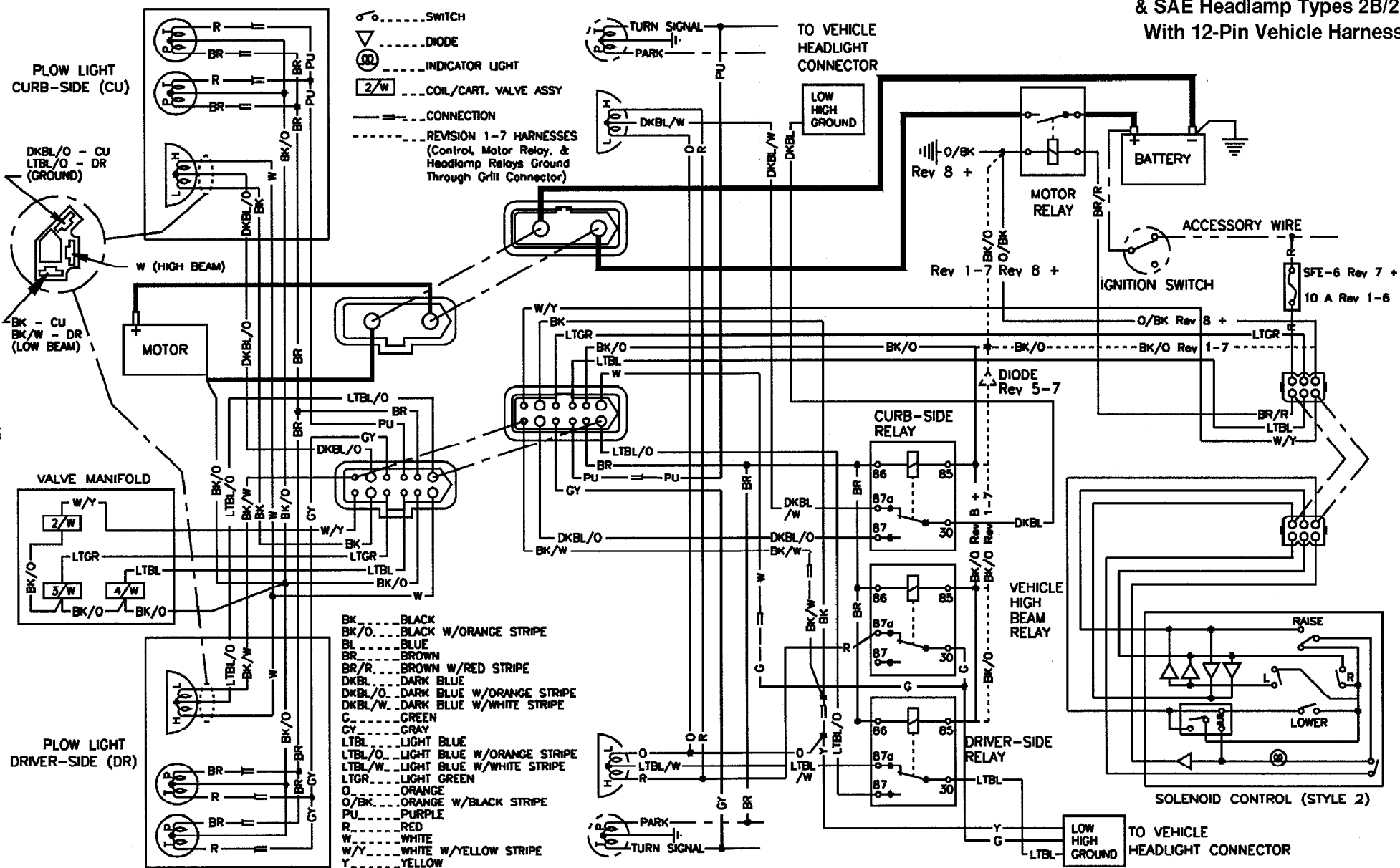

Vehicle harnesses – 12 pin, P.N. 61557, rev. 5, 6, or 7 – The indicator light on the solenoid control will only light when the plow is attached to the vehicle and the ignition switch and control on/off switch are both turned on.

Vehicle harnesses with revision numbers prior to listed revisions at right – The indicator light will also be on when the control and ignition (key) switches are ON and the plow plugs are disconnected. If the parking lights are turned on (with plow plugs disconnected), the indicator light will go out.

Solenoid Control — 12-Pin Vehicle Harness Revision 8 & later - The control indicator light will light whenever the control ON/OFF switch and the ignition (key) switch are both turned ON. The plow plugs and grill connectors do not need to be connected for the control light to be on.

# Unimount<sup>®</sup>

## Wiring Diagram Harness Type – B w/ 12 Pin Headlamp Kit & SAE Headlamp Types 2B/2D With 12-Pin Vehicle Harness w/ DRL's

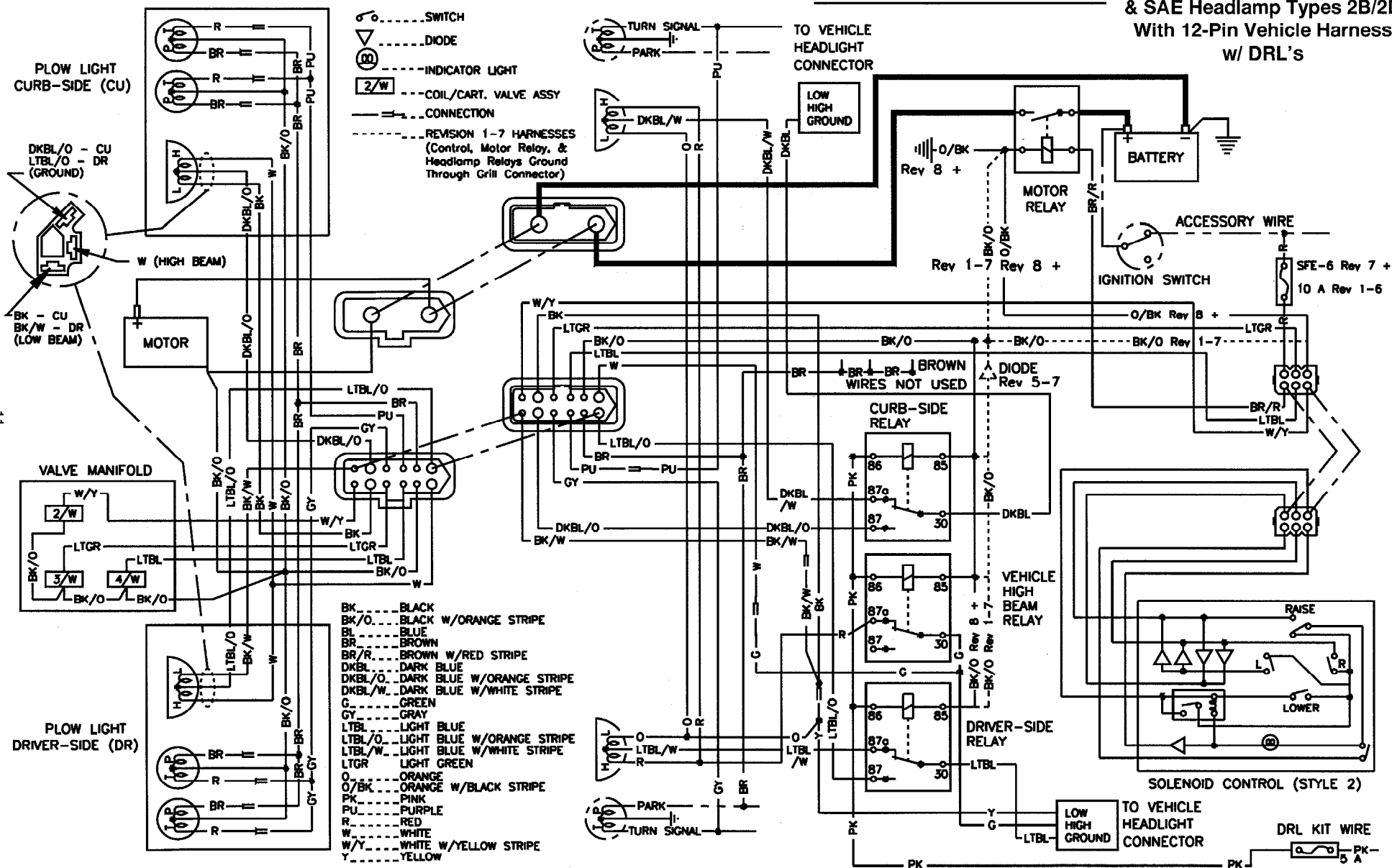

Vehicle harnesses – 12 pin, P.N. 61557, rev. 5, 6, or 7 – The indicator light on the solenoid control will only light when the plow is attached to the vehicle and the ignition switch and control on/off switch are both turned on.

Vehicle harnesses with revision numbers prior to listed revisions at right – The indicator light will also be on when the control and ignition (key) switches are ON and the plow plugs are disconnected. If the parking lights are turned on (with plow plugs disconnected), the indicator light will go out.

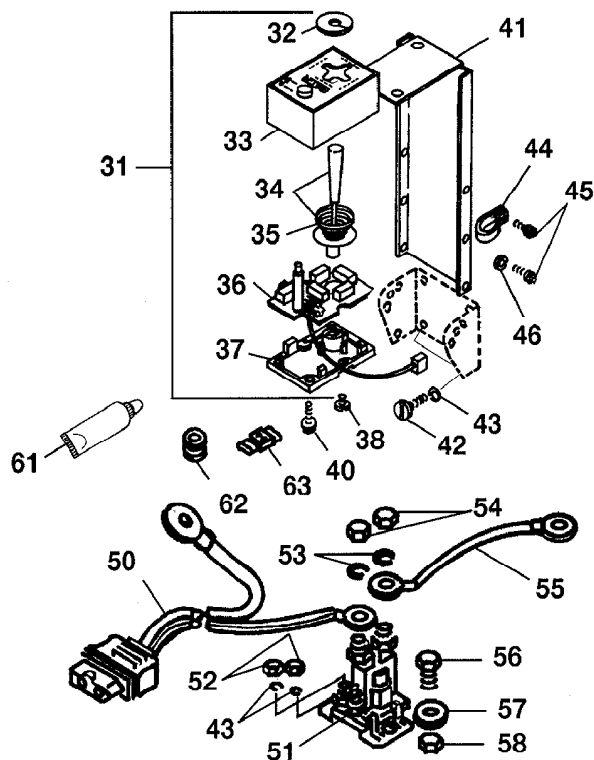

#### ITEM PART NO. QTY. DESCRIPTION

Found in Hydraulics Box No. 56355

31	56369	1	SOLENOID CONTROL (Style 2)
32	56283	1	SHIELD
33	49286	1	BODY W/LABEL & LENS (Style 2)
34	49287	1	LEVER, SPRING & ACTUATOR KIT (Style 2)
35	55923	1	SPRING - CONICAL
36	49283	1	PC BOARD ASSY MOLEX (Style 2)
37	56199	1	BASE
38	93153	2	#6-19X3/8 SL HXW TFTS HILO
40	93154	2	#8-18X5/8 SL HXW TFTS HILO
41	56308	1	CONTROL BRACKET
42	90388	4	#10X1 SL PN TFTS TY AB BZP
43	91242	4	#10 SP LK WASHER BPO
44	55381	1	CABLE CLAMP
45	93157	5	#8-32X3/8 SL HXW TCTS TY T BP
46	91231	4	#8 SP LK WASHER BP
50	61169	1	CABLE ASSEMBLY - VEHICLE
51	56134K	1	RELAY - SOLENOID HYDRAULIC SYS
43	91242	2	#10 SP LK WASHER BPO
52	91402	2	#10-32 HX NUT ZP
53	91202	2	5/16 SP LK WASHER ZP
54	92842	2	5/16-24 HX JAM NUT
55	22511	1	BATTERY CABLE 22" RED
56	90002	2	1/4-20X3/4 HX CS G2 ZP
57	91101	2	1/4 PLAIN WASHER TY A STD ZP
58	91331	2	1/4-20 PT HX LK NUT NYIS ZP
61	56099	1	DIELECTRIC GREASE TUBE (0.25 ounce)
49326		1	WESTERN DIELECTRIC GREASE TUBE (2 ounce)

62 66130 2 RUBBER GROMMET  
63 59114 1 SELF STRIP WIRE CONNECTOR

Parts listed above may be found in one of these assemblies.

56368	1	CARTON ASSY LOOSE PARTS U
56367	1	BOLT BAG ASSY LARGE U
56358	1	BOLT BAG SMALL U

Mount Box No. 62370  
Harness Kit Box No. 61555  
Hydraulics Box No. 56355

#### PARTS DIAGRAM & LIST

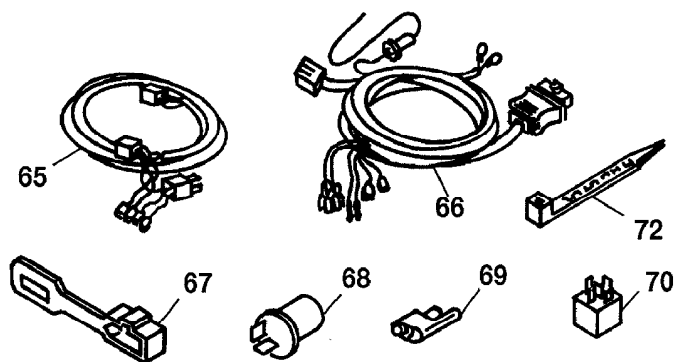

#### ITEM PART NO. QTY. DESCRIPTION

Found in Harness Kit Box No. 61555

65	61556	1	PLUG-IN HARNESS 2B/2D U -B (For Harness Kit No. 61555)
66	61557	1	VEHICLE HARNESS 12-PIN
67	61548	2	PLUG COVER
68	60109	1	FLASHER HD
69	59224	3	BULLET RECEPTACLE CONNECTOR
70	61535	3	RELAY SPDT
72	59223	8	CABLE TIE

Parts listed above may be found in the following assembly.

61572	1	PARTS BAG
-------	---	-----------

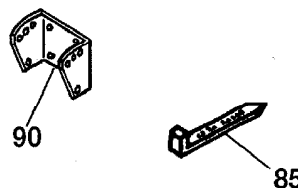

#### ITEM PART NO. QTY. DESCRIPTION

Found in Mount Box No. 62370

85	61536	5	CABLE TIE - LONG
90	56080	1	DASH BRACKET

Indented part numbers are included in the assembly under which they are listed. Quantities shown are included with the assembly.

Abbreviations			
ASSY	Assembly	SL	Slotted
BP	Black Phosphate	SP	Spring
BPO	Black Phosphate & Oil	SPDT	Single Pole Double Throw
BZP	Black Zinc Plate	STD	Standard
CS	Cap Screw	SYS	System
G	Grade	TCTS	Thread Cutting Tapping
HD	Heavy Duty		Screw
HX	Hex	Tfts	Thread Forming Tapping
HXW	Hex Washer		Screw
LK	Lock	TY	Type
NYIS	Nylon Insert	U	UniMount® System
PC	Printed Circuit	W/	With
PN	Pan	ZP	Zinc Plate
PT	Prevailing Torque		