

REF	QTY	PART NO.	DESCRIPTION
1	1	-	UPPER CASING FOR TOUCH PAD CONTROL
2	1	-	LOWER CASING FOR TOUCH PAD CONTROL
3	5	-	#6 X 3/4 HIGH/LOW SCREW
4	1	62193	TOUCH PAD CONTROL PCB
5	1	62194	KIT, DECAL PP TOUCHPAD W/ADHESIVE PADS

REV.	ZONE	DESCRIPTION	E.C.N. #	BY	DATE
A	-	INITIAL RELEASE	19549	SAG	8/11/03
B	-	CHG DESCRIPTION IN ITEM 5	20568	SAG	2/6/04

△ B

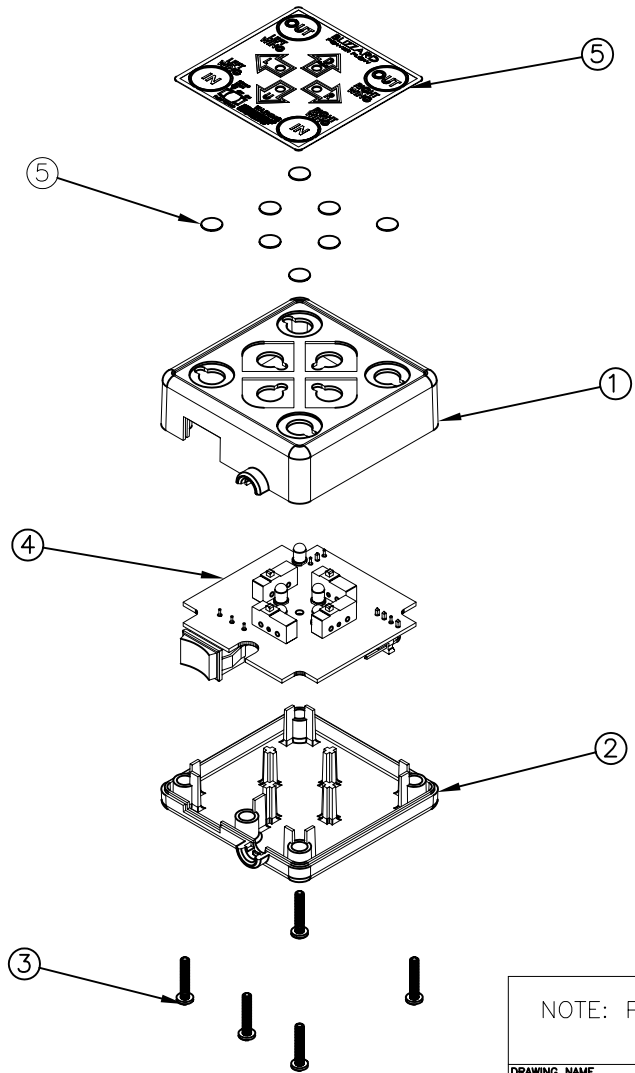

NOTE: PRINT REPRODUCED FOR BLIZZARD TECHNICAL SERVICE USAGE

DRAWING NAME		BLIZZARD TOUCHPAD CONTROL ASSY 810 PP-BLADE	
DRAWN BY	SAG	DATE	8/11/03
CHECKED BY		DATE	
SIZE	B	SCALE	FULL
SHEET	1 of 1	DRAWING NO.	50-3119-00EX
REV.			B

TOLERANCES ARE:
 FRACTIONS DECIMALS ANGLES
 $\pm 1/32$ $XX \pm .01$ $\pm 0'30$
 $XXX \pm .005$
 UNLESS OTHERWISE SPECIFIED,
 DIMENSIONS ARE IN INCHES.

DO NOT SCALE DRAWING

BLIZZARD PN 62141