



**PARTS & INSTALLATION INSTRUCTIONS
MDII™ and EZ MOUNT PLUS™
SNOW PLOW MOUNTING 17130
2002 & Later W1500 PICK-UP 4x4 MODELS
Non Commercial for Personal - use ONLY**

End user must be given this instruction sheet prior to delievery of this Snow Plow.

SAFETY DEFINITIONS

	This is the safety alert symbol. It is used to alert you to potential personal injury hazards. Obey all safety messages that follow this symbol to avoid possible injury or death.
	DANGER Indicates an imminently hazardous situation which, if not avoided, will result in death or serious injury.
	WARNING Indicates a potentially hazardous situation which, if not avoided, could result in death or serious injury.
	CAUTION Indicates an potentially hazardous situation which, if not avoided, may result in minor or moderate injury.
	CAUTION used without the safety alert symbol indicates a potentially hazardous situation which, if not avoided, will result in property damage.

IMPORTANT NOTICE

In conjunction with FMVSS (Federal Motor Vehicle Safety Standards) and OEM (Original Equipment Manufacturer) guidelines, Meyer Products has designed this plow package with the following guidelines:

	Installation of a snowplow may effect your new vehicle warranty. For more information consult your Vehicle Owner's Manual / Vehicle Dealer.
	The vehicle must not be operated when overloaded. In all cases, the loaded vehicle weight, including the entire snowplow system, all aftermarket accessories, driver, passenger, options, nominal fluid levels, and cargo must not exceed the front/rear Gross Axle Weight Rating (GAWR), and total Gross Vehicle Weight Rating (GVWR). These weights ratings are specified on the safety compliance certification label on the driver's side door opening. The use of rear ballast weight may be required to prevent exceeding the front GAWR.

According to the NHTSA (National Highway Traffic Safety Administration) new and untitled vehicles need to be verified by the installer that snowplow and ballast (if needed) do no exceed the front/rear GAWR and total GVWR.

	Read the Meyer Owner's Manual before operating or servicing a snowplow. FOLLOW THESE INSTRUCTIONS EXPLICITLY.
--	--

GENERAL INFORMATION

	SAFETY PRECAUTIONS should be used when Hydraulic Unit is in OPERATION and plow is in a RAISED position. Lower plow to ground when vehicle is PARKED in case of hydraulic failure.
--	---

Check contents against the parts list to determine all are correct and included, and also to familiarize yourself with them.

	Warranty does not apply to a Meyer or Diamond product which has been negligently or improperly assembled or installed.
	CAUTION: To avoid harm to vehicles electrical system always disconnect battery before beginning installation. DO NOT BURN holes or WELD vehicle frame. This may cause frame failure.

OVERHAUL and SERVICE INFORMATION are covered on separate instructions.

Meyer Products and Diamond Equipment reserves the right, under its continuing product improvement program, to change construction or design details, specifications and prices without notice or without incurring any obligation.

Meyer Products LLC
18513 Euclid Ave. • Cleveland, Ohio 44112-1084
Phone 486-1313 (Area Code 216)
www.meyerproducts.com • email info@meyerproducts.com

Meyer New England
6 Angell Lane • Damariscotta, ME 04543-4507
Phone 563-2227 (Area Code 207)
www.diamondplow.com • email info@diamondplow.com



PARTS LIST

ITEM	PART NO.	QTY.	DESCRIPTION
	17130		MOUNTING CARTON
1	19071	1	• Under Frame Weldment
2	19072	1	• RH Sidemember Weldment
3	19073	1	• LH Sidemember Weldment
	08844	1	• HARDWARE BAG
4	19393	2	•• Sleeve 13/16" O.D.
5	19395	4	•• Sleeve 5/8" O.D.
6	20096	10	•• Bolt H 1/2-13 x 1-3/4 Gr. 5
7	20084	4	•• Bolt H 7/16-14 x 4-1/2 Gr.5
8	20140	2	•• Bolt H 5/8-11 x 1-3/4 Gr. 5
9	20151	2	•• Bolt H 5/8-11 x 4-3/4 Gr. 5
10	22491	1	•• Handle Bolt 1-8 x 2
11	22492	1	•• Handle Bolt 1/2-13 x 1-3/4
12	20306	4	•• 7/16-14 Locknut
13	20307	11	•• 1/2-13 Locknut
14	20309	4	•• 5/8-11 Locknut
15	22493	1	•• Locknut 1-8
16	20354	20	•• 7/16 Flatwasher
17	20355	3	•• 1/2" Flatwasher
18	20357	8	•• 5/8 Flatwasher
19	20361	1	•• 1" Flatwasher
*	19370	1	Universal Clevis (Part of Plus CLF carton)
**	11770	1	Universal Clevis (Part of MDII CLF carton)
11" SECTOR			MEYER
	PART NO.	QTY.	DESCRIPTION
	16520	1	Sector A-Frame Carton



Parts indented are included in the carton, bag or assembly under which they are indented.

IMPORTANT

After first use, retighten all mounting bolt connections to specified torque. All mounting bolt connections to be checked periodically for tightness.

Locknuts are furnished **DO NOT** tighten bolts and nuts until installation is complete (unless otherwise specified), then be sure to tighten all attaching parts per specified torque chart.

TORQUE CHART FOOT

Bolt Nut Size	Gr. 2 	Gr. 5 	Gr. 8 
1/4 - 20	4 - 5		
5/16 - 18	9 - 11		
3/8 - 16	17 - 20	26 - 29	
7/16 - 14		42 - 46	60 - 66
1/2 - 13		64 - 72	90 - 100
5/8 - 11		127 - 141	179 - 198

NOTE:

THIS MOUNTING CARTON CAN BE USED WITH THE MDII OR EZ MOUNT PLUS CLF CARTONS.

Meyer Products or Diamond Equipment assumes no responsibility for installations not made in accordance with these instructions.

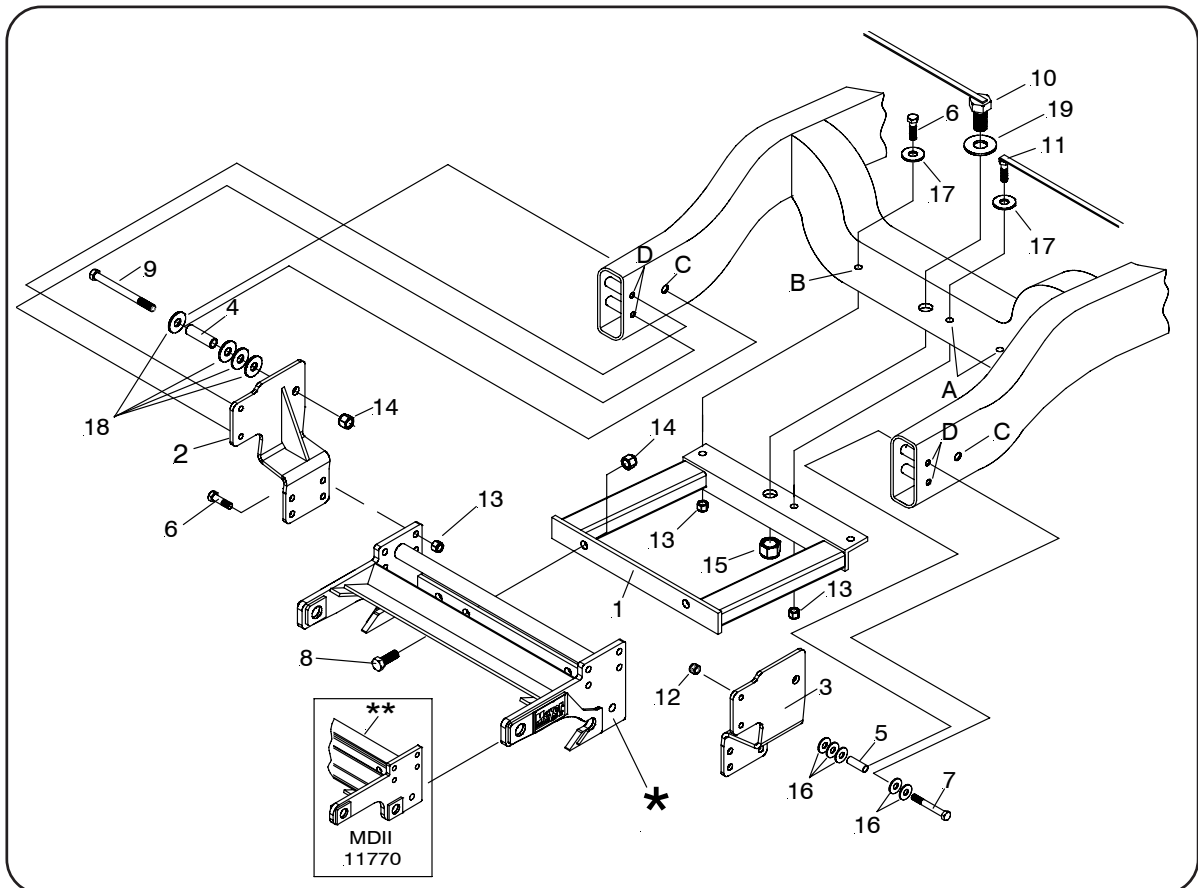

VEHICLE RECOMMENDATIONS

⚠ WARNING

- Due to weight restrictions on vehicle's front GAWR, only a STL 7.5 Moldboard is recommended on vehicle.

⚠ WARNING

- A ballast weight may be required to prevent front GAWR overloading. If required, ballast must be securely attached at least 24 inches behind the rear axle.
- Front end wheel alignment and headlight aim may require readjustment after installation of equipment, and is the responsibility of the equipment installer. Failure to adjust front wheel alignment may cause premature uneven tire wear. If required, reset to chassis manufacturer's specifications found in the Dodge Shop Manual.

Rear ballast is determined by weighing a vehicle's front and rear axles and adding weight behind the rear axle until front axle weight is under or equal to the vehicle specific front GAWR while not exceeding the rear GAWR and GVWR.

Vehicle option packages may vary. If in doubt, it is always a good idea to weigh the vehicle to ensure all weight ratings are not exceeded with plow in the raised position.

INSTALLATION INSTRUCTIONS

- A. Remove driver's side fog light harness if equipped. (It is not necessary to remove the passenger side fog light harness.)
- B. Remove the bumper by removing the through bolts which fasten it to the vehicle on both sides. Retain bolting bars and nuts they will be reused.
- C. Remove air dam. It will not be reused. Note: It may be necessary to temporarily remove bumper to frame mounting brackets to get two of the air dam bolts out (there are four mounting bracket nuts on each side.)
- D. Remove splash shield/ skid plate if equipped. There are two bolts in front and spring clips in the rear.
- E. Without re-installing bumper, loosely install LH and RH side members (2&3) in the front two holes using vehicle bumper bolting bars and nuts. Install universal clevis (*or **) using 1/2-13 x 1-3/4 bolts (6) and 1/2-13 locknuts (13). Install front of under frame (1) using 5/8-11 x 1-3/4" bolts (6) and 5/8-11 locknuts (14).
- F. On 2002-2003 models two 1/2-13 x 1-3/4 bolts (6) and one 1/2-13 x 1-3/4 handle bolt (11) are used on the back of the under frame. The handle bolt (11) goes in the middle. Align the under frame and enlarge the two pilot holes (A) on the driver's side to 1/2" diameter. Snug the bolt(6) & handle bolt (11) using 1/2-13 locknuts(13), then drill the hole on the passenger side to 1/2" (hole B), using the under frame (1) as a template.
- G. On 2004 models, one 1-8 x 2" handle bolt (10) with a 1-8 locknut (15) and 1" washer (19) is used near the center of the under frame.

- H. Snug all bolts, then drill a 5/8" diameter hole through the frame (hole C) on each side using the upper rear hole of each side member (2&3) as a template. Leaving the under frame and universal clevis installed, remove side members (2&3) and re-drill only the inside of the frame to 13/16" diameter to allow for installation of sleeve(4).
- I. Reposition bumper to frame and reinstall side members (2 & 3) using 5/8-11 x 4-3/4" bolts (9), 5/8-11 locknuts (14), 5/8 washers (18) and sleeve (4) with bumper. Note vehicles with tow hooks require three washers between the frame and the side member of the drilled hole. Vehicles without tow hooks require only one washer(on each side).

Note: before tightening the fasteners, the clevis (*) should be level with the ground and pushed back as far under the vehicle as possible.

For 2006 Vehicles:

- J. Attach LH and RH side-member weldments to clevis (*or**) using 1/2-13 x 1-3/4 bolts (6) and 1/2-13 locknuts (13). Attach under-frame (1) to rear of clevis (*or**) using 5/8-11 x 1-3/4 bolts (8) and 5/8-11 locknuts (14).
- K. Support assembly built in step J with a jack in position underneath the front of the vehicle. At the correct height, the front two holes on the hangers will be centered vertically on the frame.
- L. Attach back of under-frame (1) to vehicle cross-member with one handle bolt (10) with a 1-8 locknut (15) and 1" washer (19) near the center of the under-frame (1).
- M. Re-center the two smaller holes in the side-members (2 & 3) vertically in the side of the frame. Mark the positions of two smaller holes "D" and the larger hole "C" on the inside each of the frame rails.
- N. Drill a 7/16" diameter hole through the frame at four holes marked "D" in the illustration. Enlarge the holes on the inside of the frame rail only to 5/8" to install the 5/8" Sleeve (5).
- O. Drill a 13/16" diameter hole through the frame at two holes marked "C" in the illustration. Enlarge the holes on the inside of the frame rail only to 13/16" to install the 13/16" Sleeve (4).
- P. Install the assembly of weldments using the 7/16-14 x 4 1/2 bolts (7), 7/16 flat-washers (16) and 7/16-14 locknuts (12) as well as the 5/8-11 x 4-3/4 bolts (9), 5/8 flat washers (18) and 5/8-11 locknuts (14). Install washers as shown in the illustration.
- Q. Reinstall the bumper.
- R. Tighten all fasteners to their proper torque. Tighten bolts in the same order they were assembled.
- S. Install remaining snowplow hardware per separate instructions.

Note: when tightening Light Brackets to Lift Frame, you should pull them forward as far as possible, to avoid interference with Dodge hood.