



WESTERN PRODUCTS  
P.O. BOX 245038  
MILWAUKEE, WI 53224-9538



 A DIVISION OF DOUGLAS DYNAMICS, L.L.C.

**PARTS LIST - MODEL 3215**  
**Mount Assembly Box No. 62660-1**

Ford Excursion and Super Duty  
F-Series 250/350/450/550 4x2 and 4x4  
1999 and Later

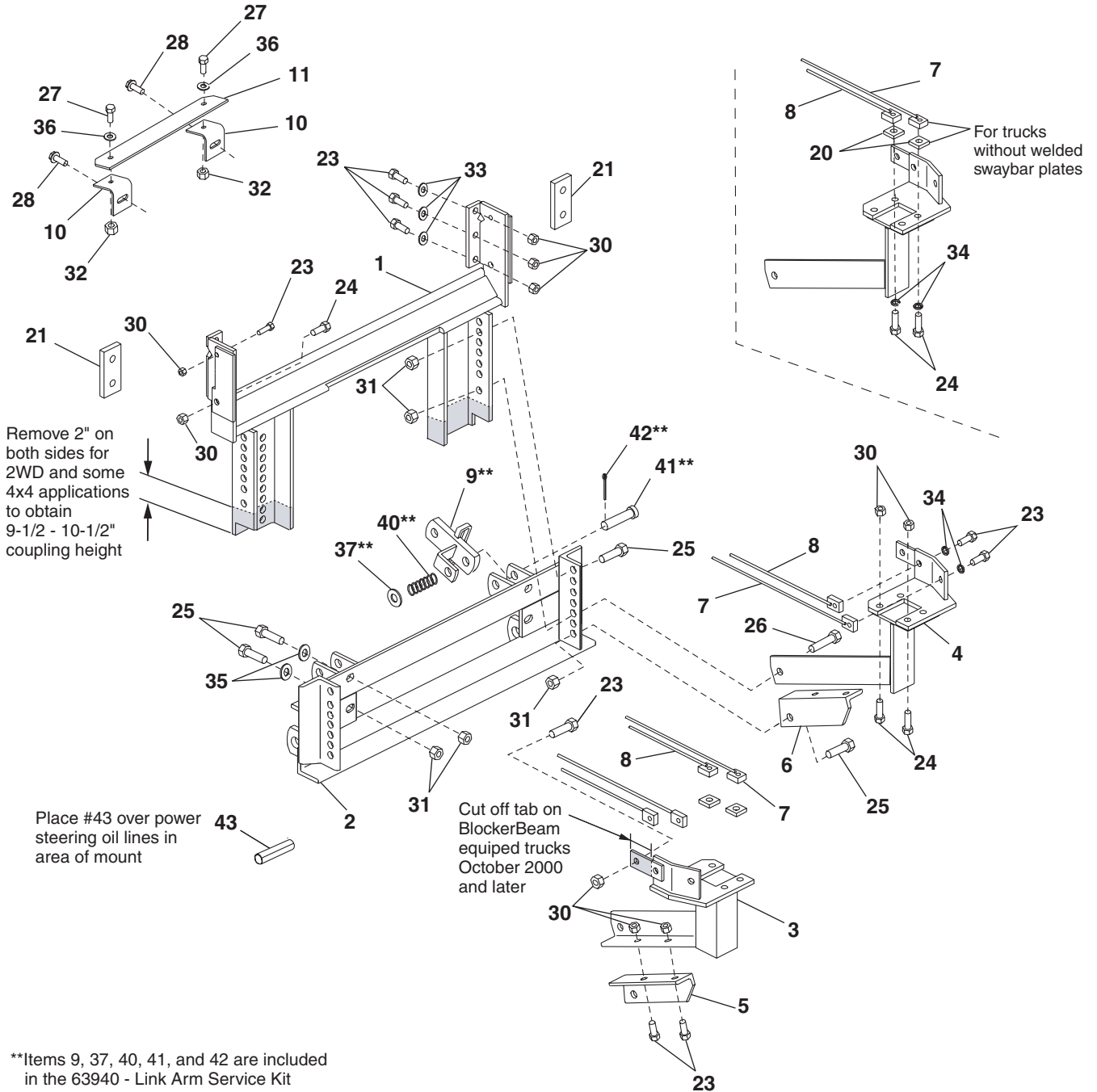

\*\*Items 9, 37, 40, 41, and 42 are included in the 63940 - Link Arm Service Kit

(Over)

# PARTS LIST - MODEL 3215

MODEL 3215 - MOUNT ASSEMBLY							
ITEM	PART NO.	QTY.	DESCRIPTION	ITEM	PART NO.	QTY.	DESCRIPTION
1	62661	1	MOUNT FRAME	8	63241	4	NUT BAR SHORT
2	62662	1	SPREADER FRAME	9	61412	2	LINK ARM
3	62663	1	THRUST ARM DS	10	67860	2	FORD POWER STEERING COOLER BRACKET
4	62664	1	THRUST ARM PS	11	67861	1	FORD POWER STEERING COOLER BRACE
5	62656	1	GUSSET DS				
6	62657	1	GUSSET PS				
7	63240	4	NUT BAR LONG				
<b>* 62659 - BOLT BAG</b> includes the following:							
20	62655	4	SHIM	35	91139	4	5/8 WASHER FL TY A NAR ZP
21	62665	2	BUMPER SPACER	36	90311	2	1/4 FLAT WASHER TYPE A WIDE
23	90210	18	1/2-13X1-1/2 HEX CAP SCREW	37	91147	2	WASHER FL 3/4 TY A NAR ZYC
24	90101	6	1/2-13X1-3/4 HEX CAP SCREW	40	63356	2	SPRING 3/4 ID X 3 LG
25	66448	8	5/8-11X1-3/4 HEX CAP SCREW	41	63354	2	CLEVIS PIN 3/4X6 HT ZYC
26	90130	2	5/8-11X2-1/4 HEX CAP SCREW	42	91911	2	5/32X1-1/2 COTTER PIN ZYC
27	90461	2	1/4-20X3/4 HEX CAP SCREW	43	62313	2	5/8" ID X 3" LG CONVOLUTED TUBE
28	93169	2	3/8-16X1 TRTS HW TY SW ZP	*	91055	2	M6-1.00X25 HW CS G8.8
30	91335	20	1/2-13 PT HW LK NUT NYIS ZYC	*	91056	2	M6-1.00 HW NUT
31	91337	10	5/8-11 PT HW LK NUT NYIS ZYC	*	91119	4	3/16 WASHER FL TY A WIDE ZP
32	91331	2	1/4-20 PT HW LK NUT NYIS ZP	*	61536	5	CABLE TIE - LONG
33	91105	6	1/2 WASHER FL TY A WIDE ZYC	*	66871	1	BLOCKER BEAM TAG
34	91205	8	1/2 WASHER SPLK ZYC				
<b>* 63934 - COOLER RELOCATION KIT</b> includes the following:							
*	63935	2	HOSE 3/8" I.D. X 3.0"	*	63937	4	HOSE CLAMP 5/8"
*	63936	2	BRASS HOSE MENDER 3/8"				

<b>* 63940 - LINK ARM SERVICE KIT</b>			
ITEM	PART NO.	QTY.	DESCRIPTION
9	61412	2	LINK ARM
37	91147	2	WASHER FL 3/4 TY A NAR ZYC
40	63356	2	SPRING 3/4 ID X 3 LG
41	63354	2	CLEVIS PIN 3/4X6 HT ZYC
42	91911	2	5/32X1-1/2 COTTER PIN ZYC

Abbreviations			
CS	Cap Screw	NAR	Narrow
DS	Driver Side	NYIS	Nylon Insert
FL	Flat	PS	Passenger Side
G	Grade	PT	Prevailing Torque
HX	Hex	SPLK	Split Lock
HXW	Hex Washer	SW	Swivel Washer Head
ID	Inside Diameter	TRTS	Thread Rolling Tapping Screw
LG	Long	TY	Type
LK	Lock	ZP	Zinc Plate
M	Metric	ZYC	Zinc Yellow Chromate

**\* NOT SHOWN**

Copyright © 2002 Douglas Dynamics, L.L.C. All rights reserved. This material may not be reproduced or copied, in whole or in part, in any printed, mechanical, electronic, film or other distribution and storage media, without the written consent of Western Products. Authorization to photocopy items for internal or personal use by Western Products outlets is granted.

Western Products reserves the right under its Product Improvement Policy to change construction or design details and furnish equipment when so altered without reference to illustrations or specifications used herein. Western Products and the vehicle manufacturer may require and/or recommend optional equipment for snow removal. Western Products offers a limited warranty on all snowplows and accessories. See separately printed page for this important information. The following are registered ® trademarks of Douglas Dynamics, L.L.C: UNIMOUNT® and WESTERN®.

Printed in U.S.A.