



PARTS & INSTALLATION INSTRUCTIONS

ROAD PRO RPBF

SNOW PLOW MOUNTING FOR

27,000-33,000 LB G.V.W. TRUCKS

(INCLUDING TILT CABS)

IMPORTANT NOTICE

End user must be given this instruction sheet prior to delivery of this Snow Plow.

The equipment you have just purchased should only be used on vehicles equipped with the Manufacturer's Snow Plow Preparation Packages. Snow Plowing without the original Snow Plow Preparation Package may damage your vehicle and the added weight to the equipment may impair the operation and control of the vehicle. Snow Plowing with a vehicle that the manufacturer does not recommend for that purpose may void your new vehicle warranty. If your vehicle is not originally equipped with the Snow Plow Package, additional parts may be necessary before snow plowing. Owners of these vehicles should consult their dealers before purchase or installation of such parts. CAUTION: the installation, on any vehicle, of these parts is not a full substitute for the original equipment Snow Plow Preparation Package.

Warning: Lift Arm extends beyond bumper of vehicle. To minimize damage from a front-end collision, Lift Arm should be removed from vehicle when Snow Plow is removed.

PARTS LIST

Item	Part No.	Qty	Description
	16522		RPBF Mounting Carton
	16523	1	• RPBF Mounting Frame Carton
1	10241	1	•• Brace L.H.
2	10242	1	•• Brace R.H.
3	19000	1	•• RPBF Lift Frame
4	19010	1	•• RP Lift Arm
5	19060	1	•• Sling Weldment
6	10946	1	•• Mounting Plate Weld
7	10947	1	•• Channel Bumper
8	19694	1	•• Cross Angle
	16524	1	• RPBF Mounting Parts Carton
9	10243	2	•• Clip Mounting
10	10948	2	•• Angle-Bumper Extension
11	10949	2	•• Side Member Weldment
12	10951	2	•• Angle-Support
13	80429	4	•• Gusset
14	10953	2	•• Bumper Clip
	08771	1	•• Hardware Bag
15	10286	2	••• Rivet
16	20420	2	••• 1/4 DIA. x 2 Cotter Pin CP
17	20141	14	••• Bolt H 5/8-11 x 2 Gr.5
18	20170	5	••• Bolt H 3/4-10 x 3-1/2 Gr.5
19	20165	2	••• Bolt H 3/4-10 x 2-1/4 Gr.5
20	20166	4	••• Bolt H 3/4-10 x 2-1/2 Gr.5
21	20171	2	••• Bolt H 3/4-10 x 3-3/4 Gr.5
22	20309	14	••• Locknut 5/8-11
23	20310	13	••• Locknut 3/4-10
24	20357	14	••• Flatwasher 5/8
25	21260	4	••• Flatwasher 3/4
26	19063	1	••• Hinge Pin 3/4
27	22083	1	••• Lynch Pin

Parts indented are included in the carton, bag or assembly under which they are indented.

Meyer Products reserves the right, under its continuing product improvement program, to change construction or design details, specifications and prices without notice or without incurring any obligation.

Meyer Products LLC
18513 Euclid Ave. • Cleveland, Ohio 44112-1084
Phone 486-1313 (Area Code 216)
www.meyerproducts.com • email info@meyerproducts.com



Meyer Products LLC
6 Angell Lane • Damariscotta, ME 04543-4507
Phone 563-2227 (Area Code 207)
www.meyerproducts.com • email info@meyerproducts.com

GENERAL INFORMATION

CAUTION: Always disconnect battery before beginning installation.

DO NOT BURN holes or **WELD** vehicle frame. This may cause frame failure.

After first use, retighten all mounting bolt connections to specified torque. All mounting bolt connections to be checked periodically for tightness.

Locknuts are furnished **DO NOT** tighten bolts and nuts until installation is complete (unless otherwise specified), then be sure to tighten all attaching parts per specified torque chart.

NOTE: It is important that the Meyer harness, all wires from the Meyer light switch, and all other electrical wires be routed around hot or moving engine parts, and any sharp metal. Protection must be provided to guard against wire damage at these points. All excess or loose wires must be neatly secured using wire ties.

Check contents against the parts list to determine all are correct and included, and also to familiarize yourself with them.

SAFETY PRECAUTIONS should be used when **Hydraulic Unit is in OPERATION** and plow is in a **RAISED** position. **Lower plow to ground when vehicle is PARKED.**

OVERHAUL and **SERVICE INFORMATION** are covered on separate instructions.

Follow these instructions explicitly. Warranty does not apply to a Meyer product which has been negligently or improperly assembled or installed.

TORQUE CHART FOOT LBS.

Bolt Nut Size	Gr. 2	Gr. 5	Gr. 8
1/4 - 20	4 - 5		
5/16 - 18	9 - 11		
3/8 - 16	17 - 20	26 - 29	
7/16 - 14		42 - 46	60 - 66
1/2 - 13		64 - 72	90 - 100
5/8 - 11		127 - 141	179 - 198
3/4 - 10		227 - 251	



Figure 1

Figure 2

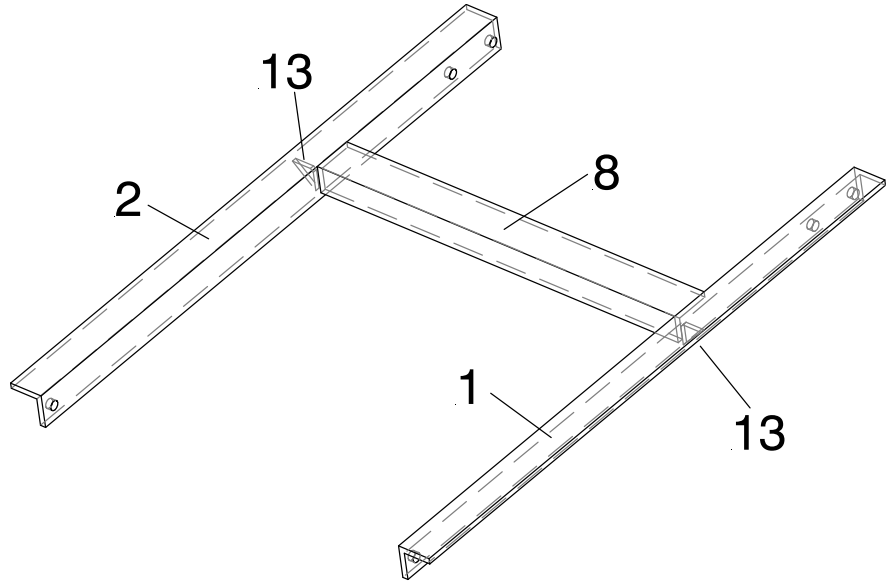
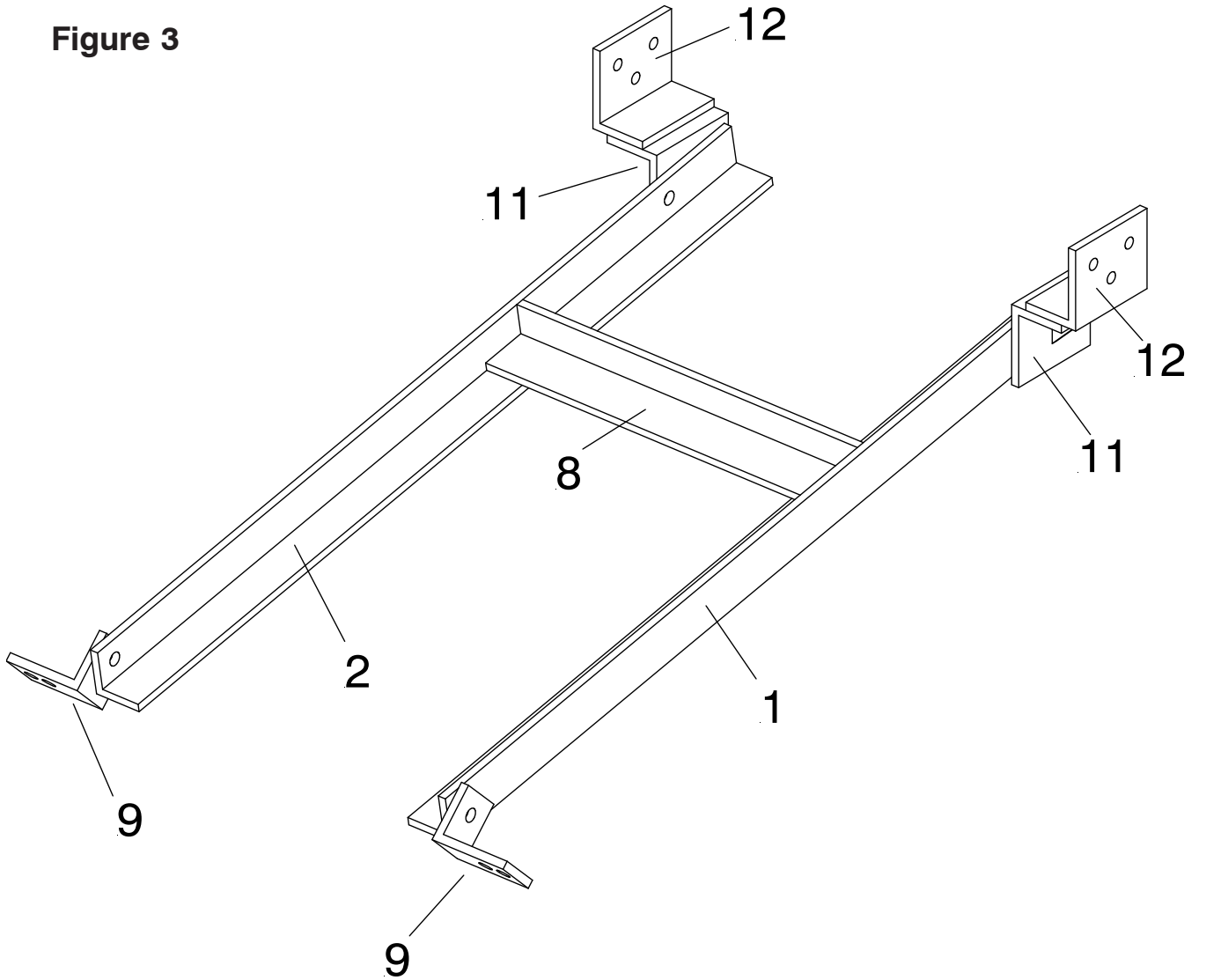

Figure 3



INSTALLATION INSTRUCTIONS

This is a universal mounting which is adaptable to vehicles with a GVW rating from 27,000 to 33,000 lbs. Cutting, welding, and drilling are required for all installations of this mounting.

- A. Remove truck bumper. It is probable that any original bumper brackets will not be reused. This will depend on each vehicle's front frame configuration. The bumper will be sandwiched between the Bumper Mounting Plate (6) and Bumper Channel (7).
- B. Locate Bumper Extension Angles (10) on end of truck frame. They can be positioned on the inside, outside, top or bottom of the vehicle frame, so as not to interfere with spring shackles. It is suggested that the Bumper Extension Angles (10), the Bumper Channel (7), vehicle bumper and Bumper Mounting Plate (6) be clamped in the desired position before any holes are drilled. Hold the Lift Frame (3) in position and verify that the clevis hole (A) height of 10-1/2" can be achieved by positioning Lift Frame (3) in one of the top three holes to Mounting Plate (6). If not, then items (6, 7 and 10) must be adjusted until the 10-1/2" dimension is obtained.
- C. After the 10-1/2" clevis height is obtained, drill four 11/16" holes in each Bumper Extension Angle (10) and truck frame. Use existing truck frame holes if possible. The Bumper Channel (7) is then welded to the Bumper Extension Angles (10) and this assembly bolted to the truck frame with 5/8-11 x 2" bolts (17), 5/8 washers (24) and 5/8 locknuts (22).
- D. Clamp the truck bumper and Bumper Mounting Plate (6) to the Bumper Channel (7) being certain they are positioned at the proper height as discussed in paragraph "B." Drill four 13/16" holes as shown through Bumper Mounting Plate (6) truck bumper and Bumper Channel (7) and install 3/4-10 x 3-1/2" bolts (18) and 3/4 locknuts (23).
- E. If desired, the Bumper Clip (14) can be drilled with a hole to accept an original bumper bolt and welded to the Bumper Channel (6) to accept an original lower hole in the truck bumper.
- F. Install Lift Frame (3) using Rivets (15) and Cotter Pins (16). Make sure Lift Frame (3) is level. Temporarily clamp the Braces (1 & 2), Mounting Clips (9), Sidemembers (11) and Support Angle (12) in position. Check for spring clearance and full motion of suspension and steering components between these pieces. The Sidemembers (11) Braces (1 & 2) and Mounting Clips (9) can be installed in different positions (see Figure 2 & 3) to obtain necessary clearance. It may be possible to attach Braces (1 & 2) directly to truck frame in some cases, and can be cut shorter if necessary.
- G. After being correctly positioned, drill three holes in the truck frame using the Support Angles (12) as a guide. Use existing truck frame holes if possible. NOTE: Be sure back side of frame is clear of any brake or fuel lines before drilling. Attach using 5/8-11 x 2" bolts (17), 5/8 washers (24) and 5/8 locknuts (22). Weld the Sidemember (11) to the Support Angle (12) and the Mounting Clips (9) to the Lift Frame (3).
- H. Drill 13/16" holes in Braces (1 & 2) and Sidemembers (11) and attach using 3/4-10 x 2-1/2" bolts (20) and 3/4 locknuts (23). Attach front of braces (1 & 2) to clip (9) using 3/4-10 x 3-3/4" bolts (21) and locknuts (23).
- I. **IMPORTANT:** Once installation is complete, verify that mounting parts do not interfere with full movement of steering or suspension and can not contact any engine components or accessories.
- J. Torque all mounting bolts at this time using the ft-lb chart on the previous page.
- K. Locate Cross Angle (8) between Braces (1 & 2) as far back as possible while maintaining proper clearance. Cut as necessary so the Cross Angle (8) ends meet with sides of Braces (1 & 2). Fully Weld Cross Angle (8) to Braces (1 & 2). Weld in Gussets (13) as shown in Figure (2) for strength.
- L. All components in Figure 3 should be welded together. The frame assembly in Figure 3 should only be bolted to the vehicle frame.
- M. Attach outer AG Lift Arm (4) ears to the Lift Frame (3) using 3/4-10 x 2-1/4" bolts (19), and locknuts (23). Attach inner AG Lift Arm bar to Lift Frame (3) using 3/4-10 x 3-1/2" bolt (18), and locknut (23). Snug these three bolts, do not torque.
- N. Attach Sling (5) to AG Lift Arm (4) using 3/4 Hinge Pin (26) and Lynch Pin (27) as shown.
- O. Assemble the Pivot Bar, A-Frame and Moldboard per separate instructions and attach to the Lift Frame (3) using the Yellow Handle Clevis Pins and Lynch Pins from AG A-Frame carton 16521.
- P. Re-torque all mounting bolts after plowing one to two times and then periodically using the ft-lb chart on the previous page.

Meyer Products assumes no responsibility for installations not made in accordance with these instructions.