

PARTS & INSTALLATION INSTRUCTIONS

MEYER SNOW PLOW MOUNTING FOR 1986 TOYOTA 4 x 4 PICKUP

**VEHICLE MUST COMPLY WITH VEHICLE MANUFACTURER'S
SPECIFICATIONS FOR SNOW PLOW APPLICATION.**

PARTS LIST

Item	Part No.	Qty.	Description
	18027	1	MOUNTING CARTON
1	10907	1	● Lift Frame
2	10529	1	● Support Arm
3	10514	1	● Lift Arm
4	10965	1	● Clevis - Underframe Weldment
5	10684	2	● Clevis - Lift Frame Strap
6	10656	2	● Light Brackets
7	10924	2	● Light Bracket Braces
8	13594	1	● A-Frame
9	12984	1	● Pivot Bar
10	12978	2	● Trip Springs
—	08568	1	● Gravel Guard Kit (see Service Bulletin #124)
	08558	1	● MOUNTING HARDWARE BAG
11	10970	2	● Bumper Extension Brackets
12	20002	2	● Bolts H 1/4-20 x 5/8" Gr. 2
13	20066	6	● Bolts H 3/8-16 x 1-1/4" Gr. 5
14	20094	4	● Bolts H 1/2-13 x 1-1/4" Gr. 5
15	20140	4	● Bolts H 5/8-11 x 1-3/4" Gr. 5
16	20144	1	● Bolt H 5/8-11 x 2-3/4" Gr. 5
17	20147	1	● Bolt H 5/8-11 x 3-1/2" Gr. 5
18	22076	4	● Bolts H 12mm x 1.25 x 100mm Gr. 8.8
19	21988	4	● Bolts H 12mm x 1.25 x 30mm Gr. 8.8
20	20678	2	● Machine Screws #10-24 x 1/2" Rd. Hd.
21	21897	2	● Hex Nuts #10-24
22	20524	2	● Hex Nuts 1/4-20
23	20307	4	● Locknuts 1/2-13
24	20309	6	● Locknuts 5/8-11
25	20327	6	● Lockwashers 3/8"
26	21991	8	● Lockwashers 12mm
27	21253	2	● Flat Washers 1/4" S.A.E.
28	10538	2	● Quick Disconnect Pins
29	21984	2	● Hair Pin Cotters
	08511	1	● SNOW PLOW HARDWARE BAG
30	11006	2	● Hinge Pin
31	21984	2	● Hair Pin Cotters
32	12150	2	● Eye Bolts
33	20318	4	● Nuts, Eslock 5/8-11
34	13598	2	● Pivot Bolts
35	13591	1	● King Bolt
36	20150	2	● Bolts H 5/8-11 x 4-1/2" Gr. 5
37	20309	5	● Locknuts, 5/8-11
	09916	1	● SNOW PLOW MARKER KIT
38	08201	2	● Snow Plow Marker Assys.
39	12816	2	● Clamps
40	20005	2	● Bolts H 1/4-20 x 1"
41	20312	2	● Locknuts 1/4-20
	20325	2	● Lockwasher 1/4"
42	09102	1	MOLDBOARD ASSEMBLY - TM-6.5
43	09100	1	● Cutting Edge - TM-6.5
44	21943	6	● Bolts C 1/2-13 x 1-3/4"
45	20307	6	● Locknuts 1/2-13

Parts indented are included in the carton, bag or assembly under which they are indented. When ordering parts furnish Part No., Name and Description. Also furnish Vehicle Model and Year. Type of Hydraulic Unit and Moldboard Size.

Meyer Products reserves the right, under its continuing product improvement program, to change construction or design details, specifications and prices without notice or without incurring any obligation.

GENERAL INFORMATION

CAUTION: Always disconnect battery before beginning installation.

DO NOT burn holes or weld vehicle frame. This may cause frame failure.

After first use retighten all mounting bolt connections to specified torque. All mounting bolt connections to be checked periodically for tightness.

Check contents against the parts list to determine all are correct and included; and also to familiarize yourself with them.

Locknuts are furnished. Do not tighten bolts and nuts until installation is complete (unless otherwise specified), then be sure to tighten all attaching parts per specified torque chart.

NOTE: It is important that the Meyer Electro-Touch Harness and Meyer Snow Plow Light Harness and all other electrical wires be routed around hot or moving engine parts, and any sharp sheet metal. Protection must be provided to guard against wire damage at these points. All excess or loose wire must be neatly secured using wire ties.

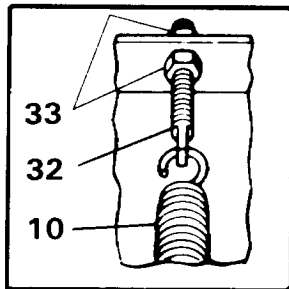
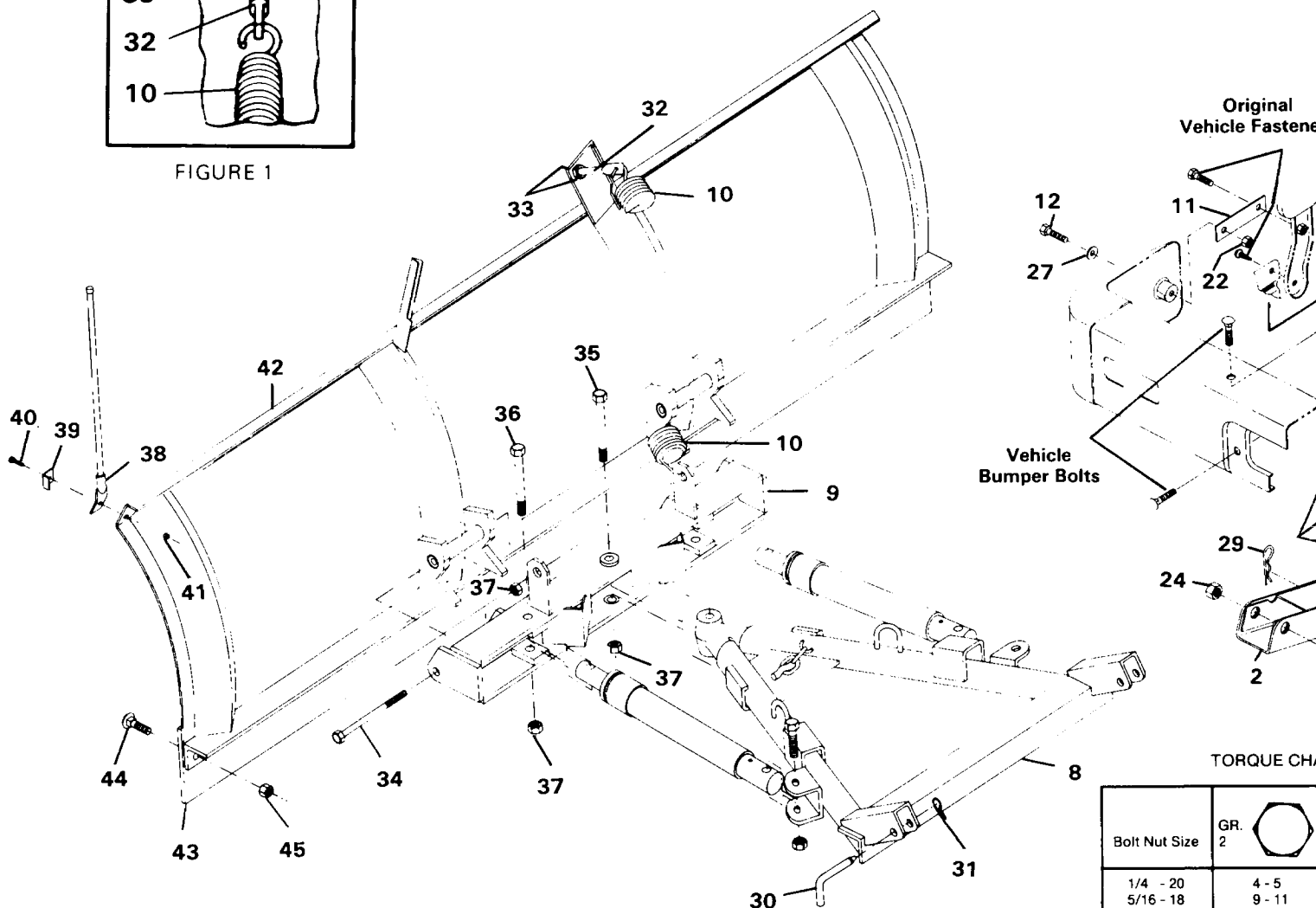

FIGURE 1



INSTALLATION INSTRUCTIONS

- A. Remove front bumper and bumper brackets. Detach brackets from bumper, they will not be used.
- B. Remove vehicle's front trim piece (airdam) and tow hooks. Retain self-tapping screws that secured the outer ends of the trim piece. All other hardware will not be used.
- C. Remove engine guard from below engine, retain all hardware.
- D. One at a time, carefully remove each of the four bolts, nuts and washers from the front suspension crossmember, and replace with 12mm x 10mm bolts (18), and vehicle's original flat washers.

NOTE: The flatwasher must be under the bolt head (18) to avoid interference with differential on other side of crossmember.

CAUTION:

DO NOT remove more than one vehicle bolt at a time. **DO NOT** dislodge crossmember tube spacers when installing new bolts (18).

- E. Place engine guard in position and attach at front. Leave rear of engine guard detached until Clevis Underframe weldment (4) is installed.
- F. Place vehicle's front trim piece loosely into cut out section of lift frame (1). Secure lift frame (1) to weldnuts in vehicle frame, using original vehicle bolts. (Move vehicle trim piece to one side to install these bolts. Protect the trim piece to prevent scratching.)

NOTICE: Meyer Products assumes no responsibility for installations not made in accordance with these instructions.

TORQUE CHART

Bolt Nut Size	GR. 2
1/4 - 20	4 - 5
5/16 - 18	9 - 11
3/8 - 16	17 - 20
7/16 - 14	
1/2 - 13 (12mm)	
5/8 - 11	
3/4 - 10	

- G. Attach Clevis lift frame straps (5) to weldnuts in truck frame using 12mm bolts (19) and to lift frame (1) using 1/2 x 1-1/4" bolts (14) and 1/2" locknuts (23).
- H. Put Clevis Underframe (4) in position and attach to Clevis lift frame straps (5) using 5/8 x 1-3/4" bolts (15) and locknuts (24). Secure rear of Clevis Underframe (4) to vehicle crossmember with 12mm x 100mm bolts (18) — previously installed in crossmember — original vehicle nuts and 12mm lockwashers (26).
- I. Tighten all fasteners per torque chart, again being careful not to scratch vehicle's front trim piece.
- J. Attach rear portion of engine guard to vehicle's crossmember using original fasteners.
- K. Attach trim piece to lift frame (1), using #10 machine screws (20) and nuts (21). Secure ends of trim piece to vehicle bracket using original self-tapping screws.
- L. Attach bumper to lift frame (1) using original vehicle fasteners. Fasten bumper extension brackets (11) to end of bumper using 1/4 x 5/8 bolts (12) 1/4 flatwashers (27) and 1/4 nuts (22). Secure other end to vehicle bracket using original vehicle bolt. Reinstall plastic hole cover in bumper. Refer to Service Bulletin #124 for Gravel Guard Installation.
- M. Assemble light brackets (6) and light bracket brace (7) to weldnuts in lift frame (1) with 3/8 x 1-1/4 bolts (13) and 3/8 lockwashers (25). Attach snow plow lights to light brackets (6 & 7). Before tightening ANY bolts, carefully open vehicle hood and adjust light brackets (6 & 7) to provide 1" clearance between vehicle hood and back of snow plow lights. Tighten bolts to proper torque.
- N. Snow Plow Lights must be adjusted to comply with Federal Regulations.
- O. Install plow light wiring per separate instructions.
- P. Assemble Electro-Touch Unit to support arm (2) with 5/8 x 3-1/2 bolt (17) and lift arm (3) using 5/8 x 2-3/4 bolt (16) and 5/8 locknuts (24). Install on lift frame (1) using quick disconnect pin (28) and hair pin cotter (29).
- Q. Install Hydraulic and Electrical system per separate instructions.
- R. Attach pivot bar (9) to moldboard (42) using pivot bolts (34) coated with chassis lubricant, and 5/8" locknut (37).
- S. Attach trip springs (10) to pivot bar (9) and moldboard (42) with eye bolts (32) and locknuts (33). Flat end of eye bolt (32) must be in a vertical position, as shown in Figure 1, to hinge properly when moldboard (42) trips. Proper tension is attained when trip spring (10) coils begin to separate and then tightening top locknut (33) four additional turns. Tighten bottom locknut (33) to secure eye bolt (32) in position. See Fig. 1.
- T. Assemble A-frame (8) to pivot bar (9) using king bolt (35) and 5/8" locknut (37). Grease king bolt (35) prior to installation.
- U. Install Power-Angling Rams with fitting end to the A-frame (8) Clevis using 5/8" x 3-1/4" bolt and 5/8" locknut. (packed in hardware bag 08363 in Electro-Touch carton) Attach piston end of ram to pivot bar (9) using 5/8" x 4-1/2" bolt (36) and 5/8" locknut (37).
- V. Straighten end of plow markers (38) so they will be vertical after installation. Attach using 1/4" x 1" bolt (40) clamp (39) and 1/4" locknut (41).
- W. Secure the Moldboard-Pivot Bar-A-Frame assembly to vehicle at Clevis Frame (4) using quick pins (30) and cotters (31). Attach lift chain to lift arm (3) allowing sufficient slack to allow moldboard to follow ground contours.

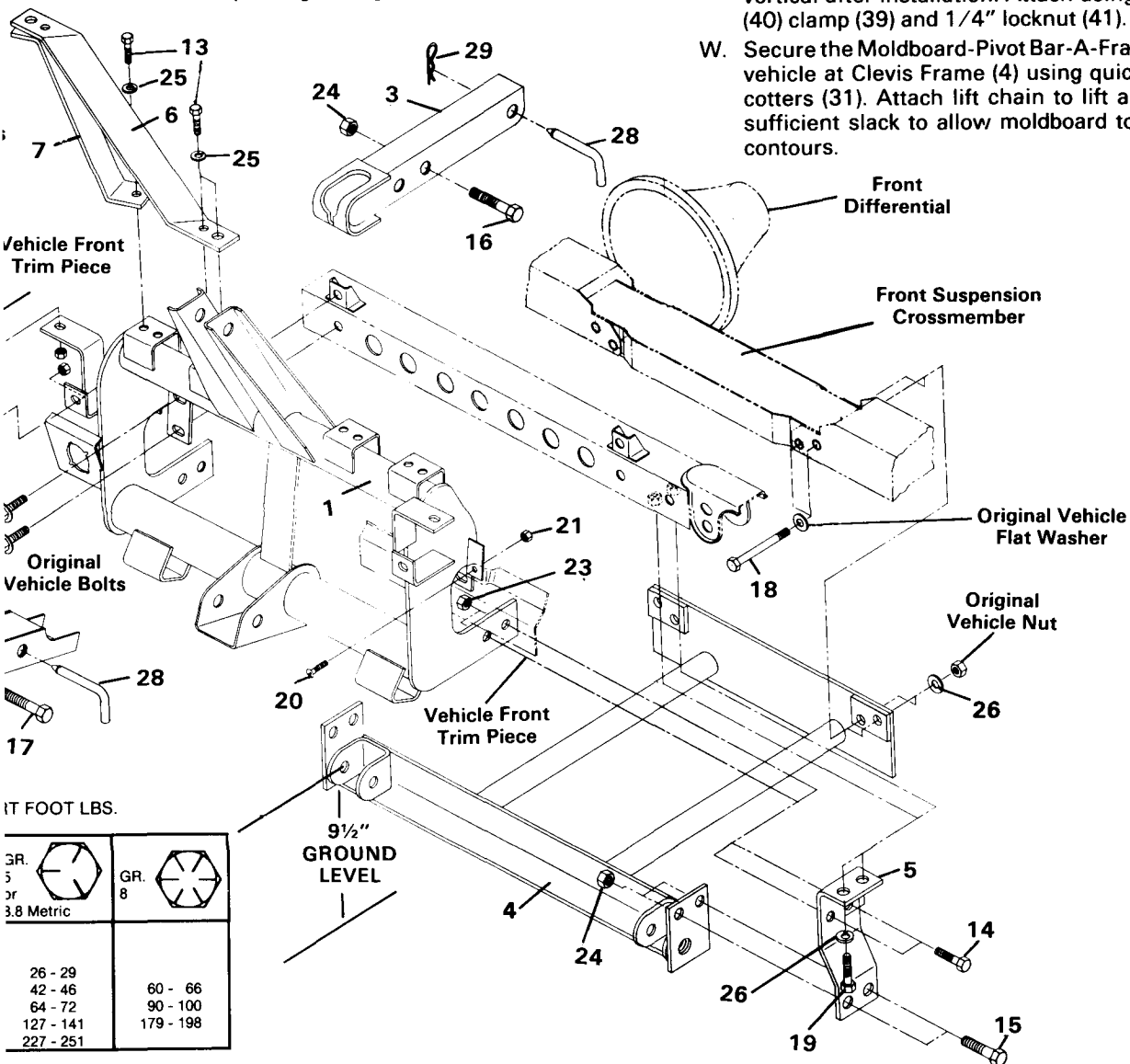

FT FOOT LBS.

GR. 5	GR. 8
26 - 29	60 - 66
42 - 46	90 - 100
64 - 72	127 - 141
127 - 141	179 - 198
227 - 251	