

PARTS & INSTALLATION INSTRUCTIONS MEYER SNOW PLOW MOUNTING 1987 & LATER NISSAN PICKUP 4 x 4

Vehicle manufacturer specifications must be adhered to for the installation of this equipment.

PARTS LIST

Item	Part No.	Quantity	Description
	18028	1	MOUNTING CARTON
1	10972	1	• Lift Frame
2	10529	1	• Support Arm
3	10514	1	• Lift Arm
4	11037	1	• Underframe
5	11015	1	• Frame Extension, Left Hand
6	11016	1	• Frame Extension, Right Hand
7	10715	1	• Light Bracket, Left Hand
8	10716	1	• Light Bracket, Right Hand
9	13594	1	• A-frame
10	12984	1	• Pivot Bar
11	12978	2	• Trip Springs
	08561	1	• MOUNTING HARDWARE BAG
12	20066	6	•• Bolt H 3/8-16 x 1-1/4" Gr. 5
13	20071	4	•• Bolt H 7/16-14 x 1" Gr. 5
14	20141	4	•• Bolt H 5/8-11 x 2" Gr. 5
15	20144	1	•• Bolt H 5/8-11 x 2-3/4" Gr. 5
16	20147	1	•• Bolt H 5/8-11 x 3-1/2" Gr. 5
17	21988	4	•• Bolt H 12 x 1.25 x 30 mm Gr. 8.8
18	20327	6	•• Lockwasher, 3/8"
19	20329	4	•• Lockwasher, 1/2"
20	20354	8	•• Flatwasher, 7/16"
21	20306	4	•• Locknut, 7/16"
22	20309	6	•• Locknut, 5/8"
23	10538	2	•• Quick Disconnect Pin
24	21984	2	•• Hairpin Cotter
	08511	1	• SNOW PLOW HARDWARE BAG
25	11006	2	•• Hinge Pins
26	21984	2	•• Hair Pin Cotter
27	12150	2	•• Eye Bolts
28	20309	5	•• Locknuts, 5/8-11
29	13598	2	•• Pivot Bolts
30	13591	1	•• King Bolt
31	20150	2	•• Bolts, H 5/8-11 x 4-1/2" Gr. 5
32	20318	4	•• Locknuts, Eslok, 5/8-11
	09916	1	• SNOW PLOW MARKER KIT
33	08201	2	•• Snow Plow Marker Assemblies
34	12816	2	•• Clamps
35	20005	2	•• Bolts, H 1/4-20 x 1 Gr. 2
36	20312	2	•• Locknuts, 1/4-20
	08470	1	• ELECTRICAL DISCONNECT KIT
37	09102	1	MOLDBOARD ASSEMBLY, TWO-METER
38	09100	1	• Cutting Edge, 78"
39	21943	6	• Bolts, C 1/2-13 x 1-3/4
40	20307	6	• Locknuts, 1/2-13

Parts indented are included in the carton, bag or assembly under which they are indented.

Meyer Products, Inc., reserves the right, under its continuing product improvement program, to change construction or design details, specifications and prices without notice or without incurring any obligation.

GENERAL INFORMATION

CAUTION: Always disconnect battery before beginning installation.

DO NOT burn holes or weld vehicle frame. This may cause frame failure.

After first use retighten all mounting bolt connections to specified torque. All mounting bolt connections to be checked periodically for tightness.

Check contents against the parts list to determine all are correct and included, and also to familiarize yourself with them.

Locknuts are furnished. **DO NOT** tighten bolts and nuts until installation is complete (unless otherwise specified), then be sure to tighten all attaching parts per specified torque chart.

When ordering parts furnish Part No., Name and Description. Also furnish Vehicle Model and Year, Type of Hydraulic Unit and Moldboard Size.

INSTALLATION INSTRUCTIONS

- A. Remove front bumper, leaving brackets attached to vehicle, save bumper bolts. Remove skid plate and tow hook; they will not be used. Leave air dam on vehicle.
- B. Attach Frame Extensions (5 & 6) to weldnuts on bottom of vehicle frame using 12 x 30 mm Bolts (17), 1/2" Lockwasher (19) and 7/16" Flatwasher (20). Do not tighten.

- C. Place Lift Frame (1) in position and attach to vehicle bumper bracket using 7/16 x 1" Bolts (13), 7/16" Flatwasher (20), and 7/16" Locknut (21). Do not tighten.
- D. Put Underframe (4) in position and attach the rear portion to vehicle crossmember with vehicle bolts and flatwashers from vehicle stabilizer bar. (Depending on date of manufacture the stabilizer bar will have either two or four bolts and flat washers.) Attach front of Underframe (4) to Lift Frame (1) and Frame Extensions (5 & 6), using 5/8 x 2" Bolts (14) and 5/8" Locknuts (22).
- E. Tighten all fasteners according to torque chart beginning with Frame Extensions (5 & 6), and back of Underframe (4) and then all other fasteners.
- F. Attach Light Brackets (7) and (8) to weldnuts in light bracket clip on Lift Frame (1) using 3/8" x 1-1/4" Bolts (12) and 3/8" Lockwashers (18). Attach Snow Plow Light to Light Bracket (7 & 8) and tighten all Bolts. Check for clearance at Light when vehicle hood is opened. Snow Plow Lights must be adjusted to comply with Federal Regulations.
- G. Install Snow Plow Light Wiring per separate instructions.

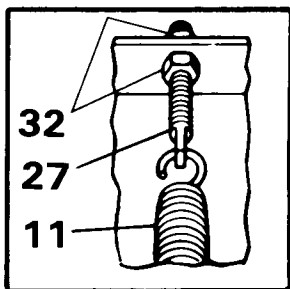
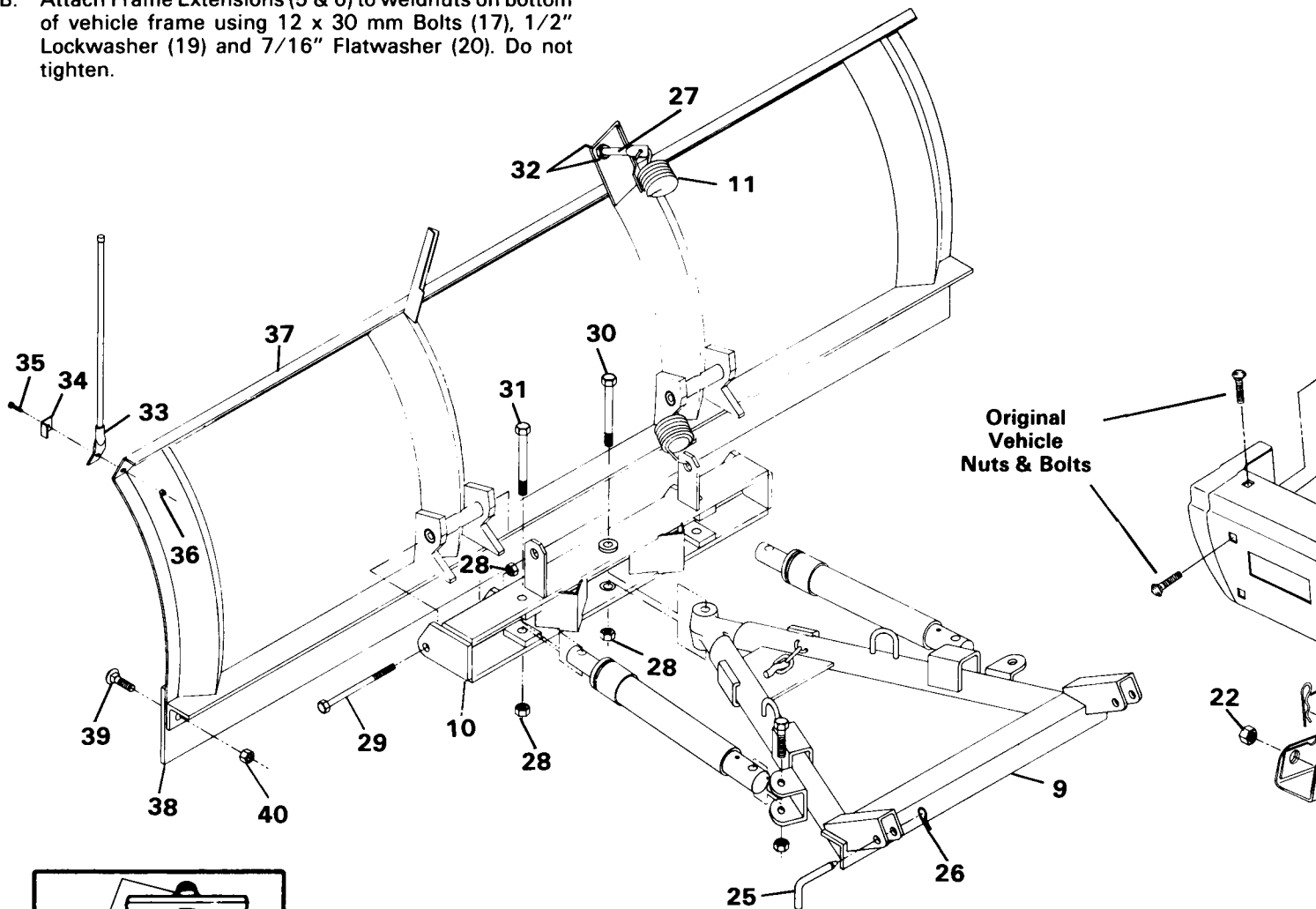

FIGURE 1

TORQUE CHART FOOT LBS.

Bolt-Nut Size	GR. 2	GR. 5 or 8.8 Metric	GR. 8
	1/4 - 20	4 - 5	
5/16 - 18	9 - 11		
3/8 - 16	17 - 20	26 - 29	
7/16 - 14		42 - 46	60 - 66
1/2 - 13		64 - 72	90 - 100
5/8 - 11		127 - 141	179 - 198
3/4 - 10		227 - 251	

NOTICE: Meyer Products at installations not made in acco

- H. Attach bumper to Lift Frame (1) using original vehicle nuts and bolts.
 - I. Assemble Electro-Touch Unit to Support Arm (2) using 5/8" x 3-1/2" Bolt (16) and 5/8" Locknut (22) and Lift Arm (3) to Lift Ram using 5/8" x 2-3/4" Bolt (15) and 5/8" Locknut (22). Secure this assembly to Lift Frame (1) using Quick Disconnect Pins (23) and Hair Pin Cotter (24).
 - J. Install Hydraulic and Electrical System per separate instructions.
 - K. Attach Pivot Bar (10) to Moldboard (37) using Pivot Bolts (29) coated with chassis lubricant, and 5/8" Locknut (28).
 - L. Attach Trip Springs (11) to Pivot Bar (10) and Moldboard (37) with Eye Bolts (27) and Locknuts (32). Flat End of Eye Bolt (27) must be in a vertical position, as shown in Figure 1, to hinge properly when Moldboard (37) trips. Proper tension is attained when Trip Spring (11) coils begin to separate and then tightening top Locknut (32)
- four additional turns. Tighten bottom Locknut (32) to secure Eye Bolt (27) in position. See Fig. 1.
 - M. Assemble A-frame (9) to Pivot Bar (10) using King Bolt (30) and 5/8" Locknut (28). Grease King Bolt (30) prior to installation.
 - N. Install Power-Angling Rams with fitting end to the A-frame (9) Clevis using 5/8" x 3-1/4" Bolt and 5/8" Locknut, (packed in hardware bag 08363 in Electro-Touch carton) Attach piston end of ram to Pivot Bar (10) using 5/8" x 4-1/2" Bolt (31) and 5/8" Locknut (28).
 - O. Straighten end of Plow Markers (33) so they will be vertical after installation. Attach using 1/4" x 1" Bolt (35). Clamp (34) and 1/4" Locknut (36).
 - P. Secure the Moldboard-Pivot Bar-A-Frame assembly to vehicle at Clevis on Underframe (4) using Hinge Pins (25) and Hair Pin Cotter (26). Attach Lift Chain to Lift Arm (3) allowing sufficient slack to allow Moldboard to follow ground contours.

