



PARTS & INSTALLATION INSTRUCTIONS
MDII™ and EZ MOUNT PLUS™
SNOW PLOW MOUNTING 17156
2006 & Later Ford L45/L55
and International CF500/CF600

End user must be given this instruction sheet prior to delivery of this Snow Plow.

SAFETY DEFINITIONS

	This is the safety alert symbol. It is used to alert you to potential personal injury hazards. Obey all safety messages that follow this symbol to avoid possible injury or death.
	DANGER Indicates an imminently hazardous situation which, if not avoided, will result in death or serious injury.
	WARNING Indicates a potentially hazardous situation which, if not avoided, could result in death or serious injury.
	CAUTION Indicates an potentially hazardous situation which, if not avoided, may result in minor or moderate injury.
	CAUTION used without the safety alert symbol indicates a potentially hazardous situation which, if not avoided, will result in property damage.

IMPORTANT NOTICE

In conjunction with FMVSS (Federal Motor Vehicle Safety Standards) and OEM (Original Equipment Manufacturer) guidelines, Meyer Products has designed this plow package with the following guidelines:

	Installation of a snowplow may effect your new vehicle warranty. For more information consult your Vehicle Owner's Manual / Vehicle Dealer.
	The vehicle must not be operated when overloaded. In all cases, the loaded vehicle weight, including the entire snowplow system, all aftermarket accessories, driver, passenger, options, nominal fluid levels, and cargo must not exceed the front/rear Gross Axle Weight Rating (GAWR), and total Gross Vehicle Weight Rating (GVWR). These weights ratings are specified on the safety compliance certification label on the driver's side door opening. The use of rear ballast weight may be required to prevent exceeding the front GAWR.

According to the NHTSA (National Highway Traffic Safety Administration) new and untitled vehicles need to be verified by the installer that snowplow and ballast (if needed) do no exceed the front/rear GAWR and total GVWR.

	Read the Meyer Owner's Manual before operating or servicing a snowplow. FOLLOW THESE INSTRUCTIONS EXPLICITLY.
--	--

GENERAL INFORMATION

	SAFETY PRECAUTIONS should be used when Hydraulic Unit is in OPERATION and plow is in a RAISED position. Lower plow to ground when vehicle is PARKED in case of hydraulic failure.
--	---

Check contents against the parts list to determine all are correct and included, and also to familiarize yourself with them.

	Warranty does not apply to a Meyer or Diamond product which has been negligently or improperly assembled or installed.
--	--

	CAUTION: To avoid harm to vehicles electrical system always disconnect battery before beginning installation. DO NOT BURN holes or WELD vehicle frame. This may cause frame failure.
--	---

OVERHAUL and **SERVICE INFORMATION** are covered on separate instructions.

Meyer Products and Diamond Equipment reserves the right, under its continuing product improvement program, to change construction or design details, specifications and prices without notice or without incurring any obligation.

Meyer Products Inc.
18513 Euclid Ave. • Cleveland, Ohio 44112-1084
Phone 486-1313 (Area Code 216)
www.meyerproducts.com • email info@meyerproducts.com

Diamond Equipment
6 Angell Lane • Damariscotta, ME 04543-4507
Phone 563-2227 (Area Code 207)
www.diamondplow.com • email info@diamondplow.com



PARTS LIST

ITEM	PART NO.	QTY.	DESCRIPTION
	17156	1	MOUNTING CARTON
1	19647	2	• Hanger Weld
2	19687	1	• L.H. Brace Assembly
3	19686	1	• R.H. Brace Assembly
	08126	1	• Hardware Bag
4	20096	9	•• Bolt H 1/2-13 x 1-3/4" Gr. 5
5	20141	7	•• Bolt H 5/8-11 x 2" Gr. 5
6	20307	9	•• Locknut ESNA 1/2-13
7	20309	7	•• Locknut ESNA 5/8-11
8	20357	2	•• Flatwasher 5/8"
*	19370	1	Universal Clevis (Part of Plus CLF Carton)
**	11770	1	Universal Clevis (Part of MDII CLF Carton)
15" SAF			MEYER
	PART NO.	QTY.	DESCRIPTION
	16516	1	Sector A-Frame Carton
DIAMOND			
	81504	1	Common Attaching Kit
	81026	1	Push Frame

Parts indented are included in the carton, bag or assembly under which they are indented.

IMPORTANT

After first use, retighten all mounting bolt connections to specified torque. All mounting bolt connections to be checked periodically for tightness.

Locknuts are furnished **DO NOT** tighten bolts and nuts until installation is complete (unless otherwise specified), then be sure to tighten all attaching parts per specified torque chart.

TORQUE CHART FOOT

Bolt Nut Size	Gr. 2	Gr. 5	Gr. 8
1/4 - 20	4 - 5		
5/16 - 18	9 - 11		
3/8 - 16	17 - 20	26 - 29	
7/16 - 14		42 - 46	60 - 66
1/2 - 13		64 - 72	90 - 100
5/8 - 11		127 - 141	179 - 198

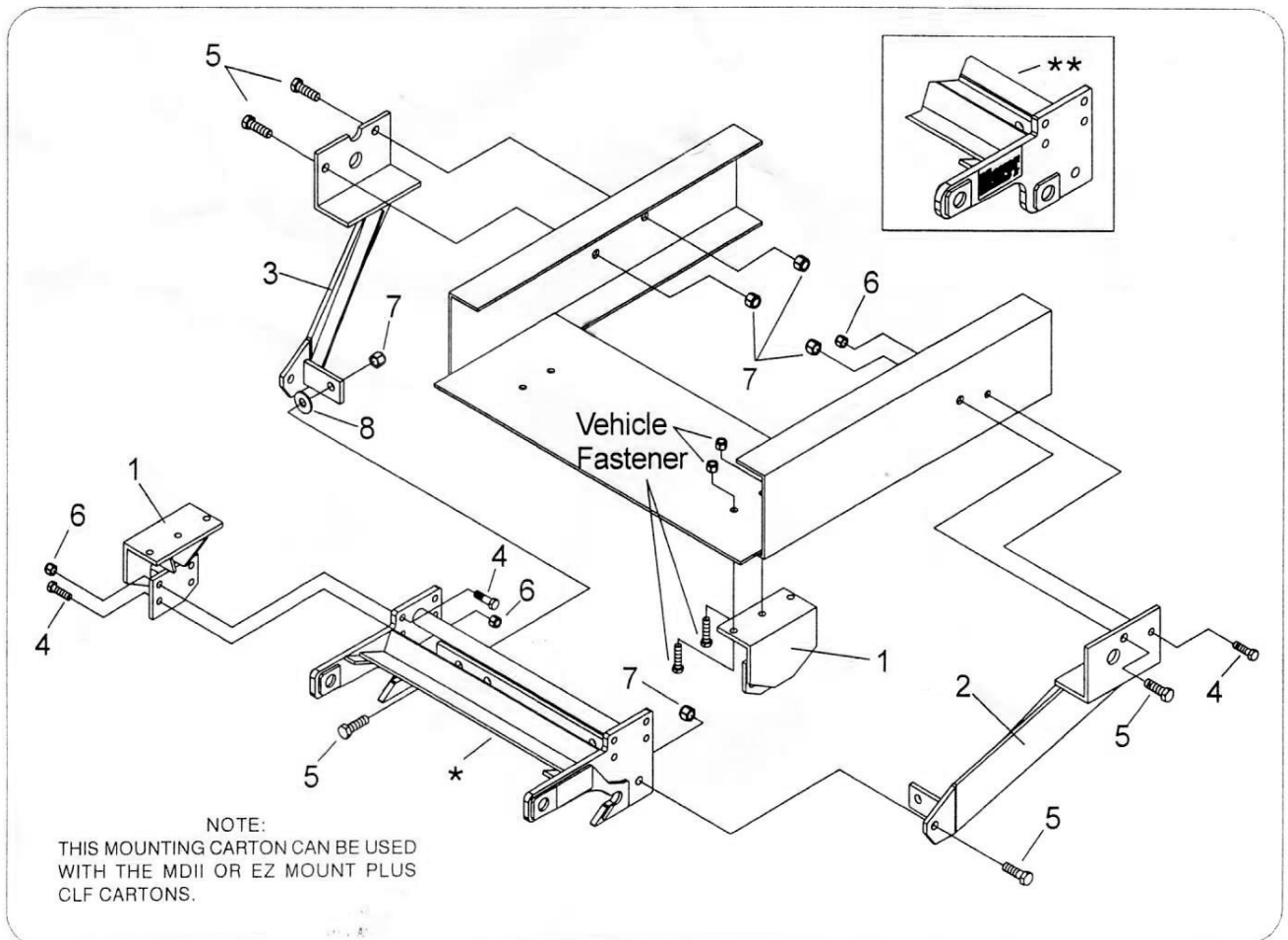

VEHICLE RECOMMENDATIONS

Vehicle option packages may vary. If in doubt, it is always a good idea to weigh the vehicle to ensure all weight ratings are not exceeded with plow in the raised position.

⚠ WARNING

- A ballast weight may be required to prevent front GAWR overloading. If required, ballast must be securely attached at least 24 inches behind the rear axle.
- Front end wheel alignment and headlight aim may require readjustment after installation of equipment, and is the responsibility of the equipment installer. Failure to adjust front wheel alignment may cause premature uneven tire wear. If required, reset to chassis manufacture's specifications found in the Ford or International Shop Manual.

Rear ballast is determined by weighing a vehicle's front and rear axles and adding weight behind the rear axle until front axle weight is under or equal to the vehicle specific front GAWR while not exceeding the rear GAWR and GVWR.

Vehicle option packages may vary. If in doubt, it is always a good idea to weigh the vehicle to ensure all weight ratings are not exceeded with plow in the raised position.

INSTALLATION INSTRUCTIONS

- A. Remove Tow Hooks and retain hardware to reinstall at next step.
 - B. Align Hanger Welds (1) front two holes with the tow hook holes on bottom of truck. Make sure the plate with four holes is facing inward as shown in illustration. Attach using hardware from tow hooks in previous step.
 - C. Cut cable tie holding vehicle harness and vehicle L bracket in place on Driver side of vehicle, remove L bracket and hardware, Retain L bracket to reattach if desired. vehicle L bracket hardware will not be reused. Align LH Brace Assembly (2) to outside holes on driver side of vehicle. Attach 5/8-11 x 2 Bolt (5) through first hole and fasten with 5/8-11 Locknut (7). Attach 1/2-13 x 1 3/4 Bolt (4) and vehicle L bracket through second hole and fasten with 1/2-13 Locknut (6). Use cable tie to reattach vehicle harness to vehicle L bracket.
 - D. Remove Wire Holder from bottom of the frame on the passenger side of vehicle, this will not be reused. Align RH Brace Assembly (3) to outside holes on passenger side of vehicles. Attach 5/8-11 x 2 bolt (5) through front two holes and fasten with 5/8-11 locknut (7).
 - E. Attach Clevis (*) to Hanger Welds (1) using 1/2-13 x 1 3/4 Bolt (4) in four upper holes and fasten using 1/2-13 Locknut (6). Note: the top two holes need to be installed from clevis side and bottom two holes from Hanger Weld side.
 - F. Attach LH & RH Brace Assembly (2 & 3) to Clevis (*) bottom hole using 5/8-11 x 2 Bolt (5) and fasten with 5/8-11 locknut (7). Attach 5/8-11 x 2 bolt (5) through first hole on angle of Clevis (*) and fasten with 5/8-11 locknut (7), with 5/8 flat washer (8) in-between Clevis (*) and LH & RH Brace Assembly (2 & 3).
- Note: Before tightening the fasteners, the Clevis Frame (*) should be level with the ground and pushed back as far under the vehicle as possible.**
- M. Tighten all fasteners to their proper torque. Tighten bolts in the same order they were assembled to the vehicle.
 - N. Install remaining snowplow hardware per separate instructions.

Meyer Products or Diamond Equipment assumes no responsibility for installations not made in accordance with these instructions.