

# Accessory Light Kit

## UTV Snowplows

### PARTS LIST

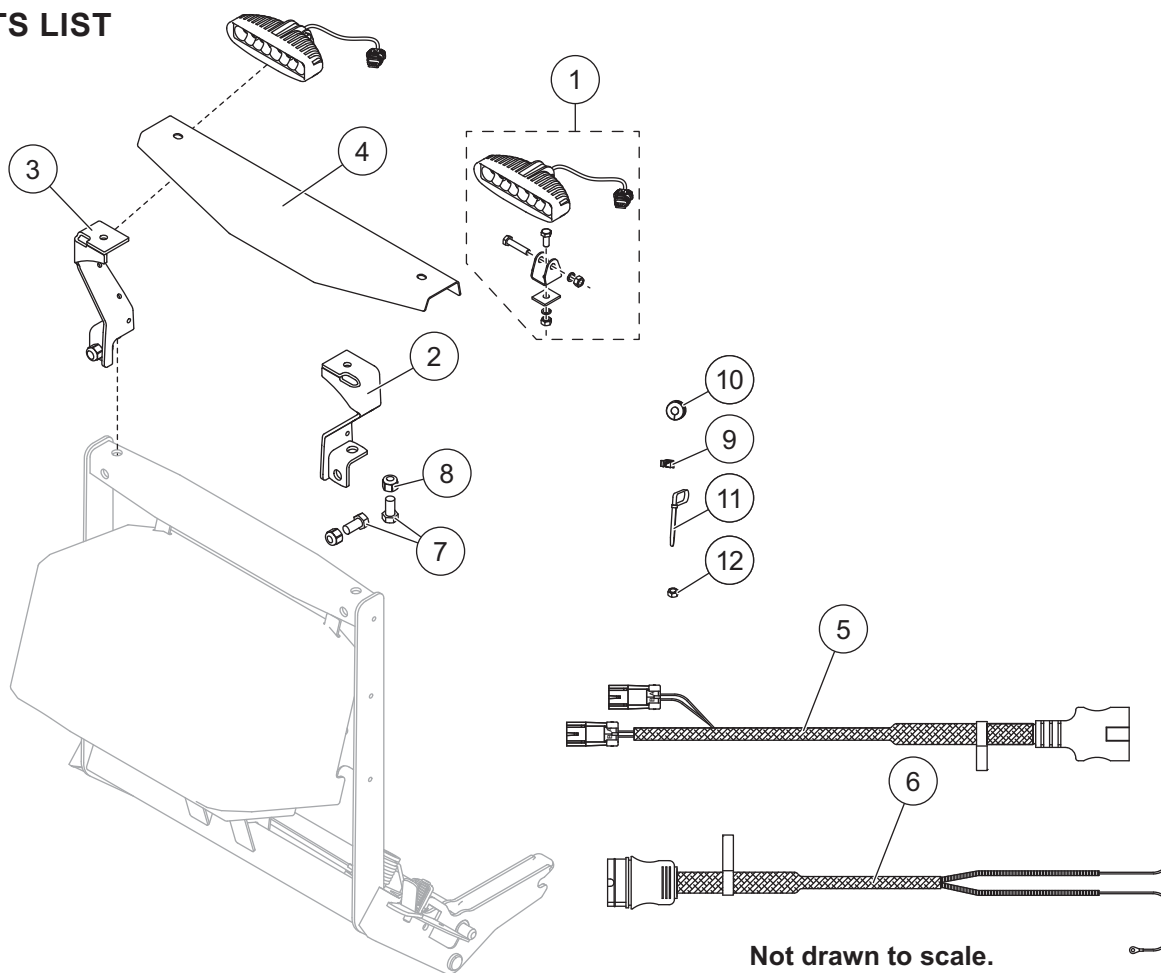

83980 UTV Accessory Light Kit							
Item	Part	Qty	Description	Item	Part	Qty	Description
1	83989	2	Headlamp, LED UTV w/Hardware	5	83985	1	Harness, 3-Pin Snowplow (service)
2	83981	1	Upright, DS	6	83986	1	Harness, 3-Pin Vehicle (service)
3	83982	1	Upright, PS	ns	83984	1	Bolt Bag
4	83983	1	Light Mounting Plate				
83984 Bolt Bag							
7		4	1/2-13 x 1 Hex Cap Screw G5	12*		4	M8 x 1.25 Locknut
8		4	1/2-13 Hex Locknut GB	ns	61548K	1	Plug Cover Kit
9	56595	6	Cable Tie Anchor	ns		1	Heatshrink Tubing, 3/16 x 6
10	66130	2	Rubber Grommet	ns		1	Splice (pkg of 5)
11		22	Cable Ties				
ns = not shown			M = Metric		G = Grade		

\* Item 12, if included in bolt bag, replaces hex nuts included in item 1. See Installation Instructions.

**SAFETY DEFINITIONS**

**⚠ WARNING**

Indicates a potentially hazardous situation that, if not avoided, could result in death or serious personal injury.

**⚠ CAUTION**

Indicates a potentially hazardous situation that, if not avoided, may result in minor or moderate injury. It may also be used to alert against unsafe practices.

**NOTE:** Indicates a situation or action that can lead to damage to your snowplow and vehicle or other property. Other useful information can also be described.

**FUSES**

The snowplow electrical and hydraulic systems contain several automotive-style fuses. If a problem should occur and fuse replacement is necessary, the replacement fuse must be of the same type and amperage rating as the original. Installing a fuse with a higher rating can damage the system and could start a fire. Fuse Replacement, including fuse ratings and locations, is located in the Maintenance section of the Owner's Manual.

**BATTERY SAFETY**

**⚠ CAUTION**







Batteries normally produce explosive gases, which can cause personal injury. Therefore, do not allow flames, sparks, or lit tobacco to come near the battery. When charging or working near a battery, always cover your face and protect your eyes, and also provide ventilation.

- Batteries contain sulfuric acid, which burns skin, eyes, and clothing.
- Disconnect the battery before removing or replacing any electrical components.

**TORQUE CHART**

**⚠ CAUTION**

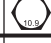
Read instructions before assembling. Fasteners should be finger tight until instructed to tighten according to the torque chart. Use standard methods and practices when attaching snowplow, including proper personal protective safety equipment.

Recommended Fastener Torque Chart					
Inch Fasteners Grade 5 and Grade 8					
Size	Torque (ft-lb)		Size	Torque (ft-lb)	
	 Grade 5	 Grade 8		 Grade 5	 Grade 8
1/4-20	8.4	11.9	9/16-12	109	154
1/4-28	9.7	13.7	9/16-18	121	171
5/16-18	17.4	24.6	5/8-11	150	212
5/16-24	19.2	27.3	5/8-18	170	240
3/8-16	30.8	43.6	3/4-10	269	376
3/8-24	35.0	49.4	3/4-16	297	420
7/16-14	49.4	69.8	7/8-9	429	606
7/16-20	55.2	77.9	7/8-14	474	669
1/2-13	75.3	106.4	1-8	644	909
1/2-20	85.0	120.0	1-12	704	995
Metric Fasteners Class 8.8 and 10.9					
Size	Torque (ft-lb)		Size	Torque (ft-lb)	
	 Class 8.8	 Class 10.9		 Class 8.8	 Class 10.9
M6 x 1.00	7.7	11.1	M20 x 2.50	325	450
M8 x 1.25	19.5	26.9	M22 x 2.50	428	613
M10 x 1.50	38.5	53.3	M24 x 3.00	562	778
M12 x 1.75	67	93	M27 x 3.00	796	1139
M14 x 2.00	107	148	M30 x 3.50	1117	1545
M16 x 2.00	167	231	M33 x 3.50	1468	2101
M18 x 2.50	222	318	M36 x 4.00	1952	2701
These torque values apply to fasteners except those noted in the instructions.					

## INSTALLATION INSTRUCTIONS

### **⚠ WARNING**

Do not exceed GVWR or GAWR, including blade and ballast. The rating label is found on the driver-side vehicle door cornerpost.

### **⚠ CAUTION**

Install auxiliary lights for compliance and visibility in accordance with local regulations. The lights provided in this kit are for "OFF ROAD USE" only. The lights are NOT DOT or CE approved.

### **⚠ CAUTION**

Read this document before installing the accessory light kit.

### **⚠ CAUTION**

Use standard methods and practices when attaching snowplow and installing accessories, including proper personal protective safety equipment.

### **⚠ CAUTION**

See your sales outlet/website for specific vehicle application recommendations before installation. The online selection system has specific vehicle and snowplow requirements.

### **⚠ CAUTION**

Use recommended splicing procedure (at the end of this document) when attaching snowplow accessory wires to the OEM vehicle wires.

## Install Vehicle Lighting Harness

1. Park the vehicle on a smooth, level, hard surface, such as concrete. Lower the blade to the ground, and turn the control OFF. Disconnect the snowplow from the vehicle, or turn the vehicle ignition to the "OFF" position and remove the key.

**NOTE: Use dielectric grease on all electrical connections to prevent corrosion. Fill receptacles and lightly coat ring terminals before assembly.**

2. Disconnect both the NEGATIVE (-) and the POSITIVE (+) battery cables.
3. Route the red (+12V) wire of the 3-pin vehicle harness (PN 83986) from the grille or bumper to a 10A switched accessory circuit. Using the supplied splices, follow the splicing procedure on page 6 to connect the wires.

No headlamp ON/OFF switch is provided to toggle the lights on and off because many UTVs have upfitter accessory switches available onboard the vehicle. Wiring into these switches is acceptable provided the circuit is fused at 10A. Follow the UTV manufacturer's recommendations when connecting to the UTV manufacturer's supplied accessory switches.

The supplied vehicle harness wires (red and/or black) can be shortened or coiled and cable tied to length appropriate for the installation.

**NOTE: The approximate amperage draw of the LED lamps is 2.5A. Avoid sharp edges and hot or moving parts while routing the wires.**

4. Route the black wire from the vehicle harness to the NEGATIVE (-) battery terminal.
5. Reconnect the POSITIVE (+) and NEGATIVE (-) battery cables. Secure wires with supplied cable ties as required.

### Plug Cover Installation

Stretch the rectangular opening of the plug cover strap over the end of the vehicle battery cable. Place the plug cover over the molded plug when snowplow is not in use.

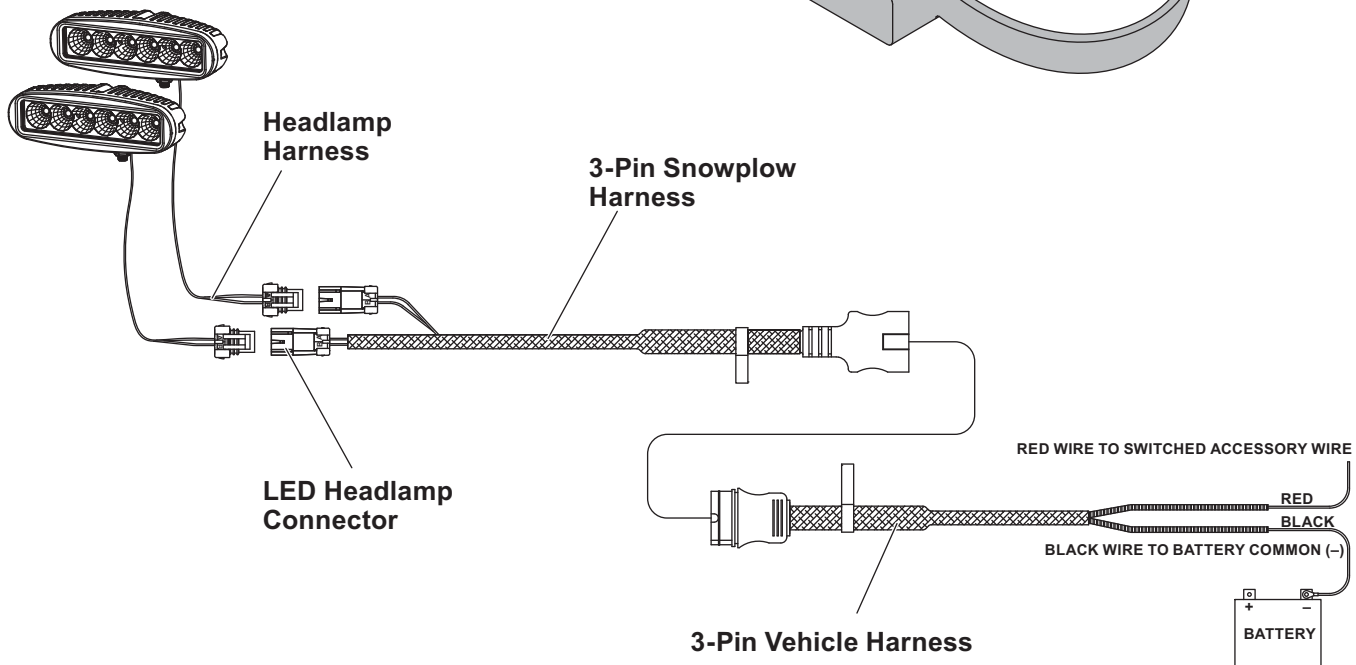
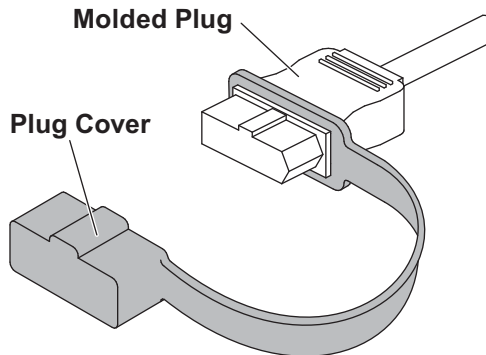

## Install Mounting Brackets and Headlamps

1. Install the driver-side and passenger-side uprights (PN 83981 & PN 83982) using the specified hardware from the bolt bag (PN 83984). Loosely install the hardware.

**NOTE: All hardware will be tightened at the end of the installation.**

2. Install the headlamp channel (PN 83984) and the LED headlamps (PN 83989) as shown in the image on page 1. If the nuts included with Item 1 are not locking nuts (Nylock type), discard them and use the locknuts that are included in the supplied bolt bag. Loosely attach hardware.
3. Torque the 1/2" fasteners to 75 ft-lb. Align the headlamps and torque the M8 mounting fasteners to 16 ft-lb.
4. Install the grommet around the headlamp jacketing and fit the grommet into the headlamp channel.

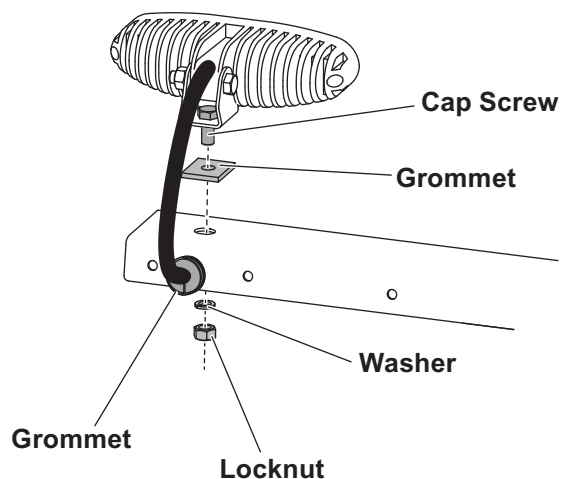

5. Install six cable tie anchors into the 1/4" holes on the rear of the headlamp channel from inside the channel, with the locking tabs in the horizontal position.
6. Connect the LED headlamp connectors to the connectors from the headlamp harness.
7. Secure the harness under the headlamp channel to the cable tie anchors using cable ties. Finish routing the harness as shown, securing with cable ties in available holes or by wrapping cable ties around the headgear upright side plate.

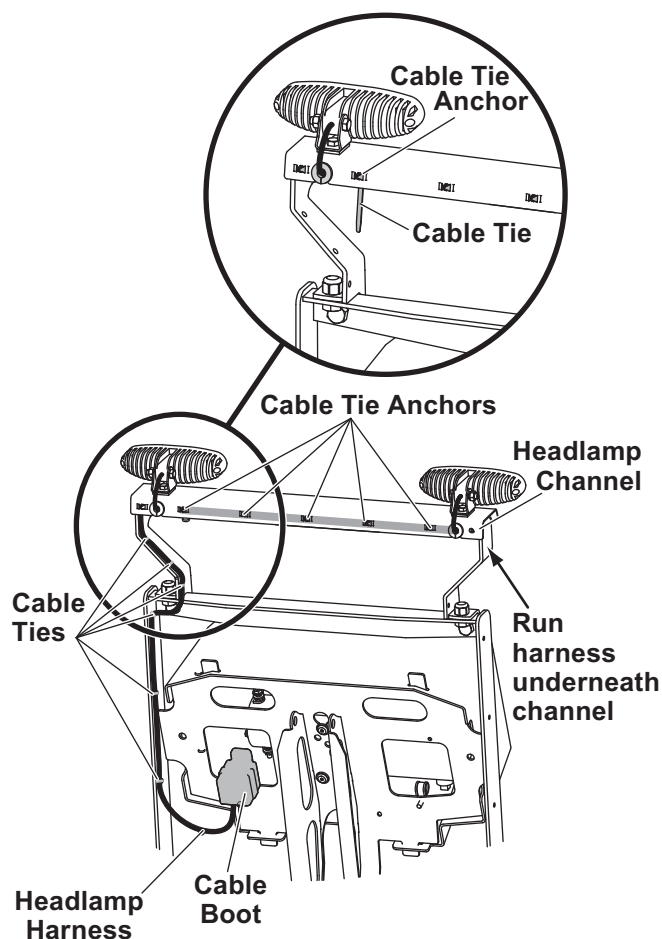

8. Verify that all harnesses are free of sharp edges and hot or moving parts.
9. When the snowplow is not in use, store the molded plug of headlamp harness in the cable boot located on the headgear.

## Usage/Testing

1. Plug in the electrical light harness and turn ON the 10A switched accessory circuit to verify headlamp operation.
2. The accessory headlamps will be active when the bumper connection is made and the 10A vehicle switched accessory circuit is activated.

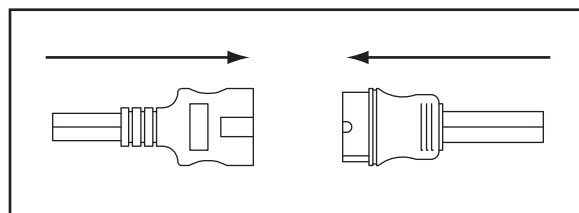

## RECOMMENDED SPLICING PROCEDURE

1. Locate the wire to be spliced into.
2. Cut the wire at least 1-1/2" from any other splice, connector, or terminal. If wires are covered by tubing or braid, remove enough of it to achieve the minimum clearance required.
3. Strip away 5/16" of the insulation from the ends of the wires to be spliced.
4. Slide two wires into one end of the supplied parallel splice.
5. Place a piece of heatshrink tubing (3/16" x 1-1/4") over the remaining wire to be spliced. Cut the tubing into 1-1/4" lengths, if required.
6. Insert the wire into the open end of the splice and crimp using an appropriate crimp tool. One or two crimps may be necessary to ensure a good connection. No wire strands should be visible outside of the splice.
7. Preheat a soldering tool for at least one minute to help promote even solder flow.
8. Apply heat to the splice. Avoid heating too close to the insulation. Apply solder to the wires, using just enough solder to produce an even flow through the splice. **Use rosin core solder ONLY. Do not use acid core solder.**

**NOTE: Avoid using an excessive amount of solder, as it can result in wicking. Wicking occurs when solder travels up the wire core. This may cause the wire to become stiff or brittle, which could lead to a broken or open circuit.**

9. Check circuits for continuity.
10. Cover the splice with heatshrink tubing. The tubing should extend beyond the splice on both sides.
11. Using a hot air source, starting in the center and working to either side, apply heat until the tubing recovers and glue can be seen around the edges. Allow the tubing to cool before handling.

**NOTE: The splices supplied will accommodate 18-gauge wires as shown. For larger-gauge wires, cut the wire, strip the ends 3/8" to 1/2" and twist together. Apply solder to the splice and cover with heatshrink tubing.**

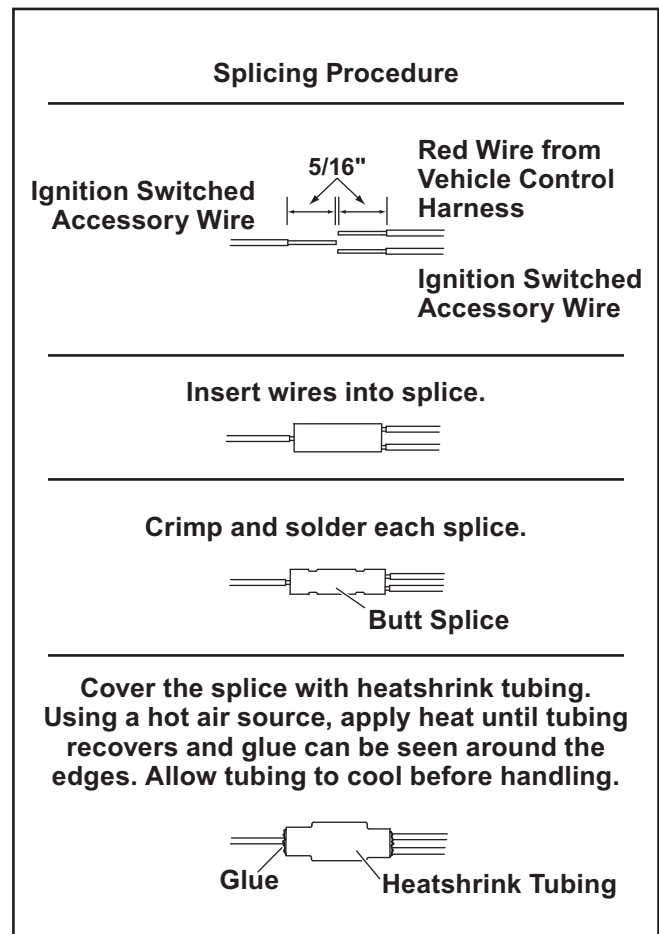

Copyright © 2019 Douglas Dynamics, LLC. All rights reserved. This material may not be reproduced or copied, in whole or in part, in any printed, mechanical, electronic, film, or other distribution and storage media, without the written consent of the company. Authorization to photocopy items for internal or personal use by the company's outlets or snowplow owner is granted.

The company reserves the right under its product improvement policy to change construction or design details and furnish equipment when so altered without reference to illustrations or specifications used. This equipment manufacturer or the vehicle manufacturer may require or recommend optional equipment for snow removal. Do not exceed vehicle ratings with a snowplow. The company offers a limited warranty for all snowplows and accessories. See separately printed page for this important information.

Printed in U.S.A.