

PARTS & INSTALLATION INSTRUCTIONS

MEYER SNOW PLOW MOUNTING

HEAVY ADJUSTABLE TRACTOR MOUNTING (H.A.T)

IMPORTANT NOTICE

End user must be given this instruction sheet prior to delivery of this Snow Plow.

The equipment you have just purchased should only be used on vehicles equipped with the Manufacturer's Snow Plow Preparation Packages. Snow Plowing without the original Snow Plow Preparation Package may damage your vehicle and the added weight to the equipment may impair the operation and control of the vehicle. Snow Plowing with a vehicle that the manufacturer does not recommend for that purpose may void your new vehicle warranty. If your vehicle is not originally equipped with the Snow Plow Package, additional parts may be necessary before snow plowing. Owners of these vehicles should consult their dealers before purchase or installation of such parts. CAUTION: the installation, on any vehicle, of these parts is not a full substitute for the original equipment Snow Plow Preparation Package.

Warning: Lift Arm extends beyond bumper of vehicle. To minimize damage from a front-end collision, Lift Arm should be removed from vehicle when Snow Plow is removed.

PARTS LIST

ITEM	PART NO.	QTY.	DESCRIPTION		
	16305	1	MOUNTING CARTON		
1	10235	1	• Lift Frame		
2	10240	1	• Support Angle.		
3	10241	2	• L.H. Brace		
4	10242	2	• R.H. Brace		
5	10243	6	• Mounting Clip		
6	10514	1	• Lift Arm		
	08403	1	• HARDWARE BAG - MTG.		
		12	•• Bolt H 5/8-11 x 2-1/4" Gr. 5		
7		1	•• Bolt H 5/8-11 x 2-3/4" Gr. 5		
8		2	•• Bolt H 5/8-11 x 3-1/4" Gr.5		
		22	•• Bolt 3/4-10 x 2-1/2" Gr.5		
9		15	•• Locknut 5/8-11		
		22	•• Locknut 3/4-10		
		4	•• Flatwasher 5/8"		
			11" Sector	15" Sector	
ITEM	PART NO.	QTY.	PART NO.	QTY.	DESCRIPTION
	16472	1	06715	1	SECTOR -A-FRAME CARTON
	12326	1	12793	1	• Sector
10	13299	1	13396	1	• A- Frame
	07017	3	07017	4	• Trip Spring
	13003	1	13004	1	• Sector Shear Pin
	09916	1	09916	1	• Marker Kit
	08166	1	08341	1	• PLOW HARDWARE BAG
	09119	2	09119	2	•• Pivot Pin w/Cotter
11	11101	2	11101	2	•• Hinge Pin
12	22083	2	22083	2	•• Linch Pin
	09122	1	09125	1	•• King Bolt w/Locknut
	09124	3	09124	4	•• Eye Bolt w/Locknuts
	08299	1	HYDRAULIC COMPMENTS CARTON		
13	05984	1	• Hydraulic Cylinder 1-1/2" x 6" S.A.		
14	05993	1	• Needle Valve 1/4		
15	05996	1	• Hose Assembly 1/4" x 84"		
16		1	• Pipe Nipple - 1/4" close		
17		1	• Street Ell - 1/4" x 1/4"		
18		1	• Swivel Fitting 1/4" x 1/4"		

Parts indented are included in the carton, bag or assembly under which they are indented. When ordering parts, furnish Part No., Name, and Description. Also furnish Vehicle Model and Year. Type of Hydraulic Unit and Moldboard Size.

Meyer Products reserves the right, under its continuing product improvement program, to change construction or design details, specifications and prices without notice or without incurring any obligation.

FRONT END MOUNTING

FIGURE 1

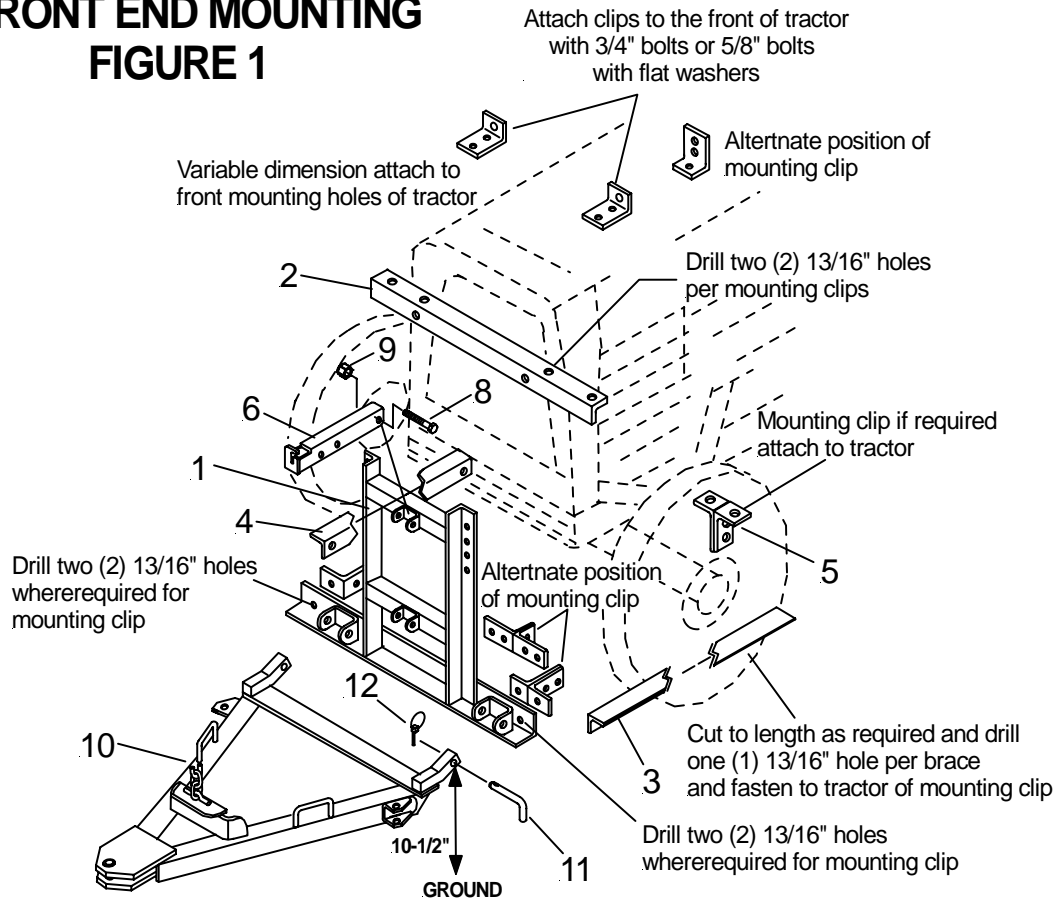

SIDE MOUNTING

FIGURE 2

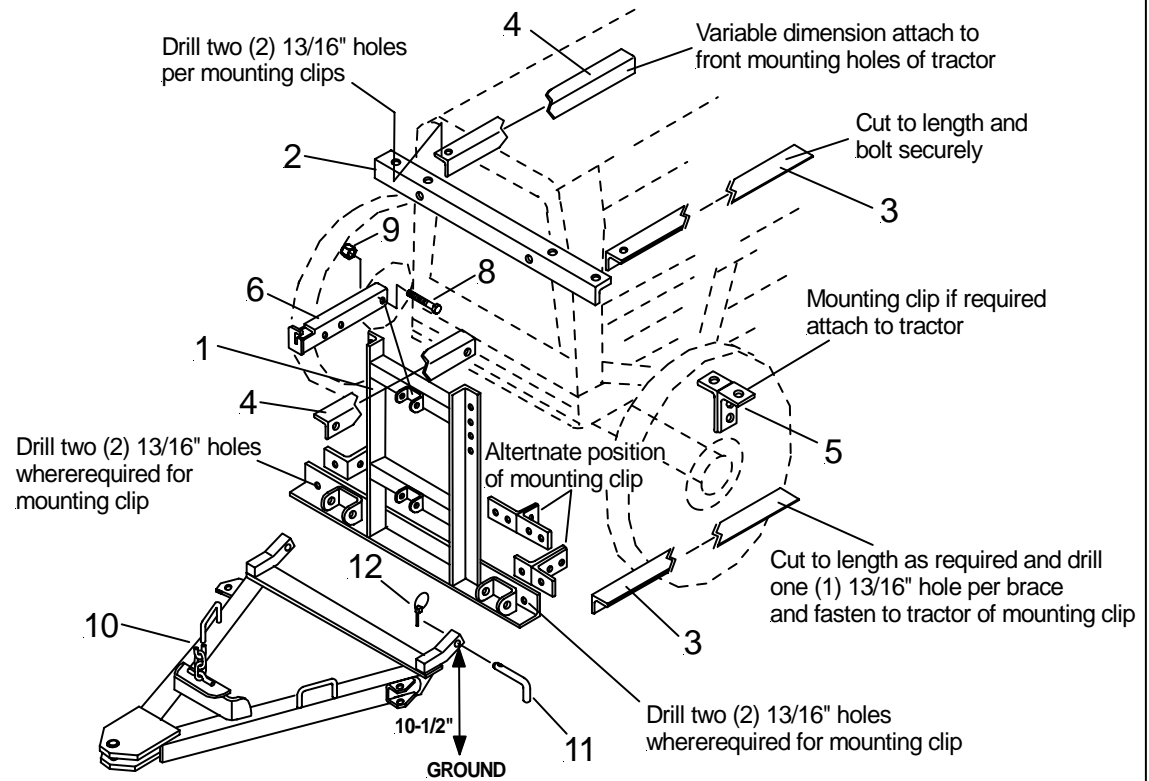

GENERAL INFORMATION

CAUTION: Always disconnect battery before beginning installation. **DO NOT BURN** holes or **WELD** vehicle frame. This may cause frame failure.

This is an adjustable mounting which is easily installed with minimum labor. Figures 1 and 2 show separate general installation procedures. Determine which procedure or whether a combination of both is most suitable for the installation. Figure 3 shows the general installation procedure when the tractor hydraulic system is to be used.

Locknuts are furnished **DO NOT** tighten bolts and nuts until installation is complete (unless otherwise specified), then be sure to tighten all attaching parts per specified torque chart.

After first use, retighten all mounting bolt connections to specified torque. All mounting bolt connections to be checked periodically for tightness.

NOTE: It is important that the Meyer harness, all wires from the Meyer light switch, and all other electrical wires be routed around hot or moving engine parts, and any sharp metal. Protection must be provided to guard against wire damage at these points. All excess or loose wires must be neatly secured using wire ties.



SAFETY PRECAUTIONS should be used when **Hydraulic Unit is in OPERATION** and plow is in a **RAISED** position. **Lower plow to ground when vehicle is PARKED.** **OVERHAUL** and **SERVICE INFORMATION** are covered on separate instructions.

Follow these instructions explicitly. Warranty does not apply to a Meyer product which has been negligently or improperly assembled or installed.

INSTALLATION INSTRUCTIONS

- Position Lift Frame (1) to proper height (10-1/2" from ground to centerline of clevises) and forward of the front sheet metal.
- After determining the installation procedure to be used, position Support Angle (2), Braces (3 & 4) and Mounting Clips (5) referring to Figures 1 and 2.
- Make certain that a minimum of 2" clearance exists between all mounting parts and tractor wheels (cycle left and right and consider axle oscillation). Readjust if necessary.

TORQUE CHART FOOT LBS.

Bolt Nut Size	Gr. 2 	Gr. 5 	Gr. 8 
1/4 - 20	4 - 5		
5/16 - 18	9 - 11		
3/8 - 16	17 - 20	26 - 29	
7/16 - 14		42 - 46	60 - 66
1/2 - 13		64 - 72	90 - 100
5/8 - 11		127 - 141	179 - 198
3/4 - 10		227 - 251	

- With mounting parts clamped or supported in desired positions, drill holes and bolt parts together and to tractor as shown in Figures 1 and/or 2.
- Excess lengths on mounting parts may be cut off for clearance and appearance.
- Attach Lift Arm (6) to Lift Frame (1) with a 5/8 x 3-1/4" bolt and locknut. (8, 9).
- Pre-assemble Moldboard Assembly, A-Frame (10), Sector, etc., per separate instruction.
- Connect A-Frame (10) to Lift Frame (1) using Hinge Pins and Spring Clips (11 & 12).
- Hook A-Frame chain to Lift Arm (6) allowing sufficient slack to enable Moldboard to follow ground contour while plowing.

USE OF TRACTOR HYDRAULIC SYSTEM

Refer to Figure 3

Integral hydraulic systems on tractors so equipped may usually be used to operate the Snow Plow. Raising and lowering of the Plow is controlled either by a built-in control valve or by an accessory control valve made for the specific tractor.

The Hydraulic Components Carton contains the parts necessary for connection to most built-in or accessory control valves. Use of additional fittings or adaptors may be necessary. Generally, the parts are used as follows:

- Attach Hydraulic Cylinder (13) to Lift Frame (1) and forward hole in Lift Arm (6) with 5/8 x 2-3/4" bolts and locknuts. (7, 9).
- Install Hose Assembly (15) to Hydraulic Cylinder (13).
- Install Street Ell (17), Pipe Nipple (16), Needle Valve (14), Swivel Fitting (18) and opposite end of Hose Assembly (15) to tractor outlet.

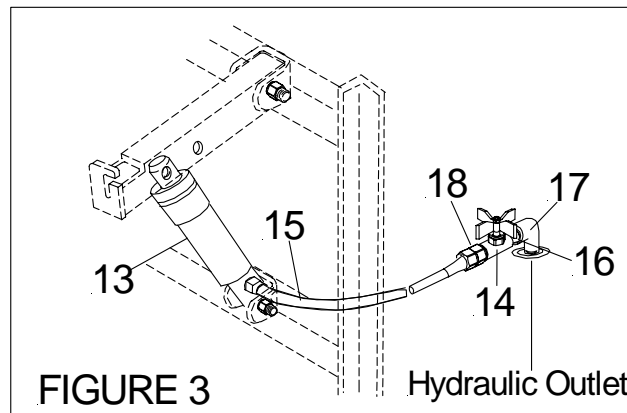

USE OF ELECTROTOUCH™ UNIT

A Meyer out front hydraulic unit may be installed if the tractor has an adequate alternator. See instructions packaged in hydraulic carton for installation.