

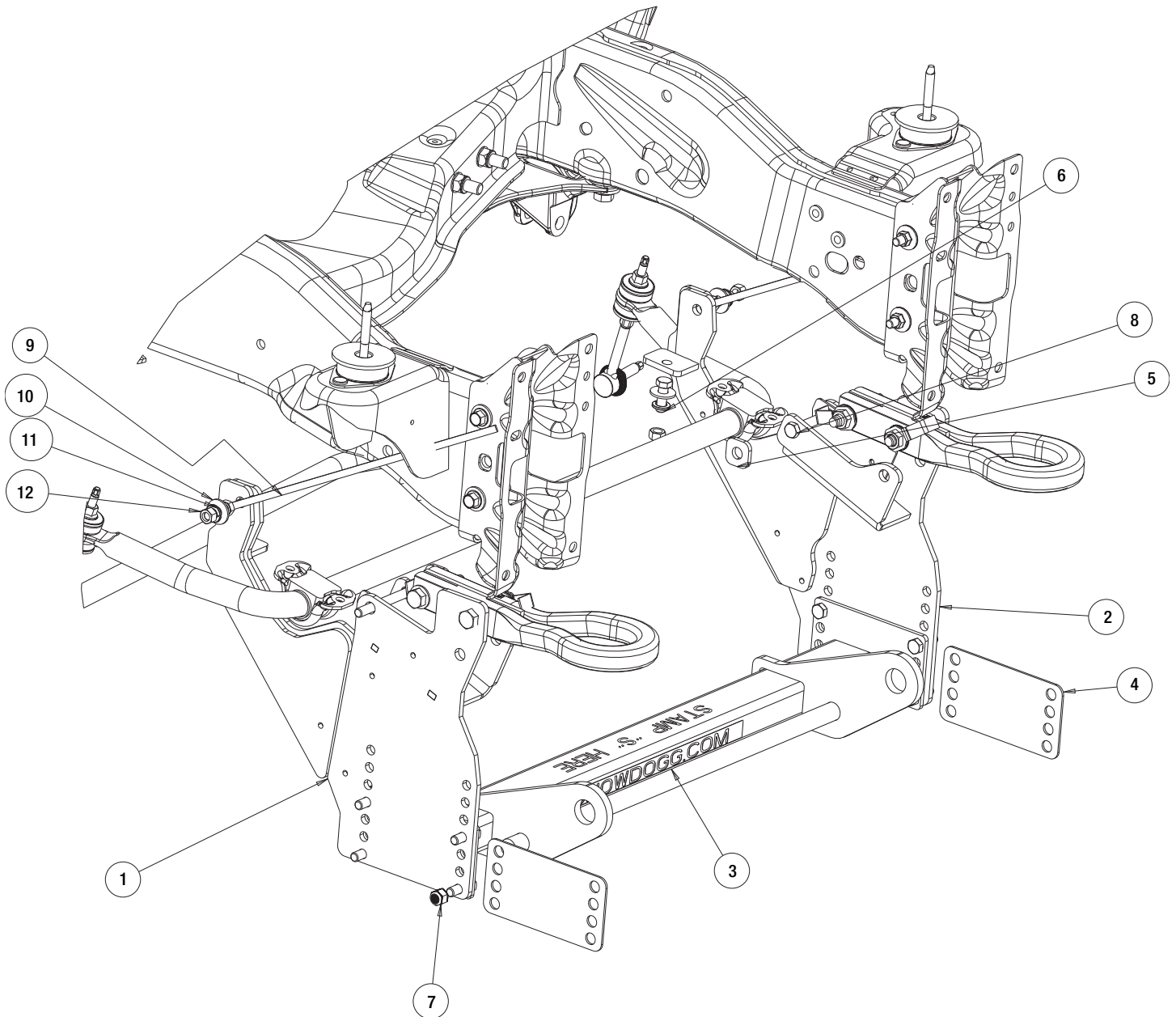

SnowDogg® Snowplow

TRUCK MOUNT INSTALLATION MANUAL

16063270
RAM 2019+ 4500/5500



Bill of Materials

ITEM	PART NO.	QTY.	DESCRIPTION
1	16063271	1	SIDEPLATE, PS, WELD, 19 RAM 4500
2	16063272	1	SIDEPLATE, DS, WELD, 19 RAM 4500
3	16063256	1	PUSHBAR, DODGE 4500 08+
4	3040394	2	PLATE, PUSH MOUNT, THICKNESS SPACER
5	3043797	2	SPACER, RAM 4500, 19+
6	3006202	10	SCREW, HEX HD - 1/2-13 X 1 - 1/2 GR 8 ZC
7	3002397	10	LOCKNUT, HEX NYLOCK, 1/2- 1 3 ZN, G8

ITEM	PART NO.	QTY.	DESCRIPTION
8	FCS050013450	2	SCREW, HEX HEAD CAP, 1 /2- 13 X 4- 1/2, GR 5
9	16801004	2	SCREW, HEX HD, 1 /2- 1 3x 1 - 1/2 GR 5 W/ HDL
10	FWF050138014	4	WASHER, FLAT, 1/2" USS, ZN
11	FWL050088013	4	WASHER, LOCK - 1 /2 SPLIT ZN
12	3006201	4	NUT, 1/2-13 HEX GR. 8 ZP
13	FWL050088013	6	WASHER, LOCK - 1/2 SPLIT ZN

INSTRUCTIONS

1. It is recommended to remove the bumper for this installation.
2. Remove the tow hooks. Keep the existing fasteners for later re-installation with the side plates.
3. Hold the PS Side Plate (1) up against the Passenger side frame rail aligning it to the tow hook bolts. Use the 4.5" bolts along with a square spacer to fill the gap of the inside frame.

Fig. 1

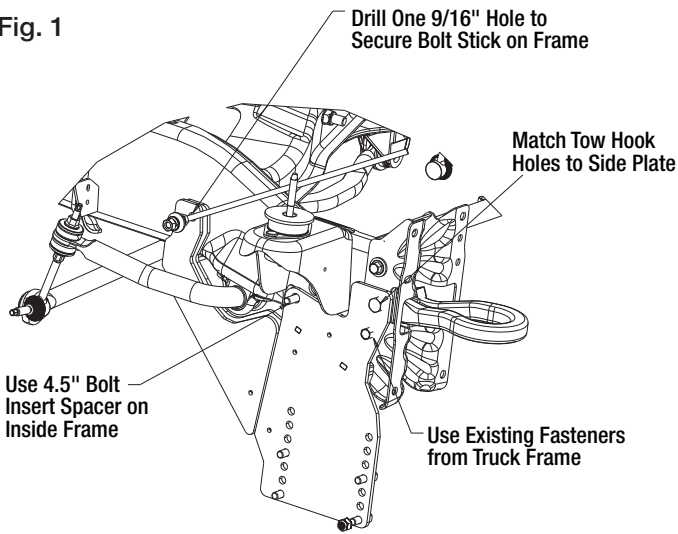

4. Toward the rear of the truck, drill one 9/16" hole to secure it onto the side frame of the truck. At the bottom of the frame, drill one 9/16" hole to install the 1/2" fasteners onto the truck frame.

Fig. 2

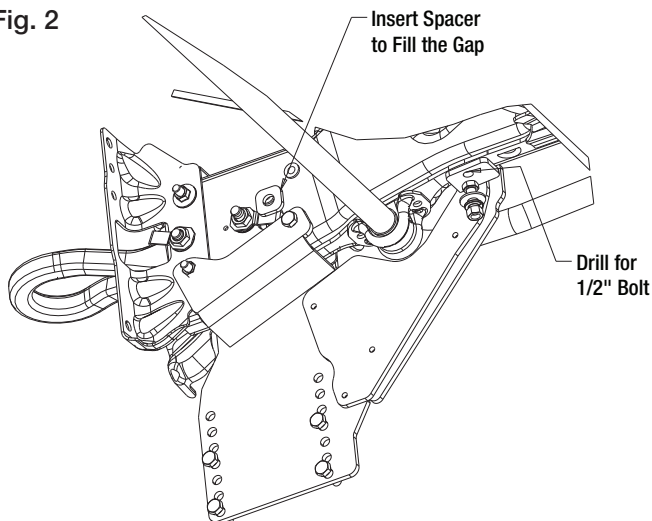



5. Repeat step 3-4 to install the DS driver side Sideplate (2).

6. Install the Pushbar (3) onto the two Sideplates (1,2) installed earlier using 8 bolts (6) and nuts (7) provided. Measure the Pushbar to about 11 inches from the level Floor. Insert the Pushbar-filler-Spacer (4) between the Sideplates to fill the gap.

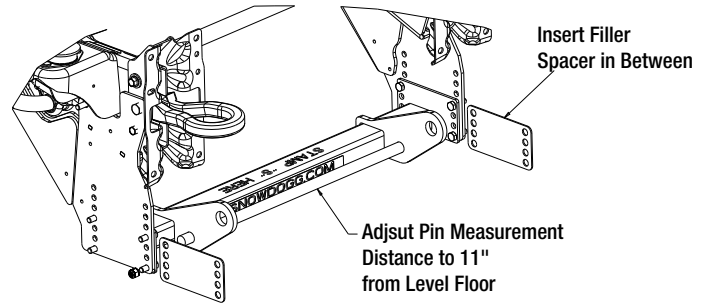
Fig. 3



7. Torque all fasteners as shown in the chart. Check and re-torque all fasteners after 5 hours of usage to ensure safe plow operation. Ensure all coolant lines and wires are clear from moving or hot components.

Recommended Fastener Torque Chart (ft.-lb.)			
	SAE Grade 2	SAE Grade 5	SAE Grade 8
Size			
1/4-20	6	9	13
5/16-18	11	18	28
3/8-16	19	31	46
3/8-24	24	46	68
7/16-14	30	50	75
1/2-13	45	75	115
9/16-12	66	110	165
5/8-11	93	150	225
3/4-10	150	250	370
7/8-9	150	378	591
1-8	220	583	893
Metric Grade 8.8 (ft.-lb.)			
Size	Torque	Size	Torque
M6	7	M12	60
M8	17	M14	95
M10	35	M16	155
<i>These torque values apply to fasteners except those noted in the instruction.</i>			

WARNING

- DO NOT under any circumstances disable, remove or relocate any sensors or components related to the operation of the air bags.
- Always follow the vehicle manufacturers' recommendations relating to snowplow installation.
- To comply with Federal Regulations and to assure a safe vehicle, the Front Gross Axle Weight Rating (FGAWR), Rear Gross Axle Weight Rating (RGAWR), and the Gross Vehicle Weight Rating (GAWR) must not be exceeded at any time.
- Due to the variety of equipment that can be installed on this vehicle, it is necessary to verify that the Front Gross Axle Weight Rating (FGAWR), Rear Gross Axle Weight Rating (RGAWR), and the Gross Vehicle Weight Rating (GAWR) are not exceeded at any time. This may require weighing the vehicle and adding ballast as necessary. It may also limit payload capacity of the vehicle. It is the operator's responsibility to verify that these ratings are not exceeded.

CAUTION

- Read all instructions prior to assembly
- It is critical that all fasteners be properly torqued for safe plow operation – see chart above.
- Fasteners should be retorqued after 5-8 hours of plow use

FULL ONE-YEAR WARRANTY

Manufacturer will repair, or at manufacturer's discretion will replace any part of this snowplow which proves to be defective in workmanship or material under normal use for a period of one year from the date of delivery to the original purchaser. Any cost incurred in returning the product to the supplier is the responsibility of the consumer.

EXCLUSIONS

Manufacturer shall not be liable for special, incidental, or consequential damages, or for damages resulting from lack of necessary maintenance, from misuse, abuse, acts of God, or alteration of the product. Some states do not allow the exclusion or limitation of incidental or consequential damages, so the above limitation or exclusion may not apply to you.