

PARTS & INSTALLATION INSTRUCTIONS MEYER SUPER-V OPTIONAL SNOW DEFLECTOR

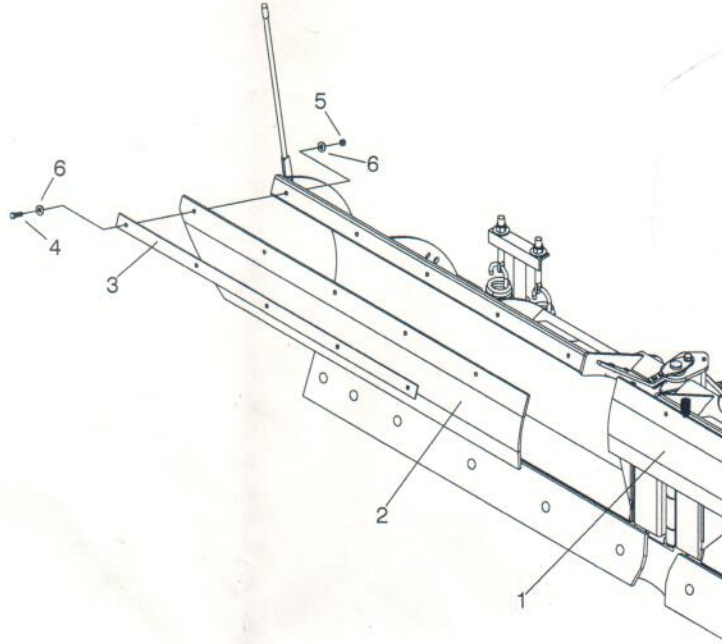

Installation Instructions

Place Snow Deflector (1 & 2) between top edge of plow wing and Deflector Bar (3). **Note: Deflector curvature should be toward plow wings.** (The plow wing has been predrilled for Snow Deflector installation) Fasten Deflector Bar (3) and Snow Deflector (1 & 2) to plow wing using Bolt H 3/8-16 x 1-1/4" (4), 3/8" Flatwasher (6) and 3/8-16 Locknut (5). Tighten fasteners such that the Deflector Bar (3) slightly compresses into the rubber deflector.

SUPER-V LD 7.5 PARTS LIST

Item	Part No.	Qty	Description
	13274	1	Super-V LD 7.5 Deflector Kit
1	13275	1	• Drivers Side Snow Deflector
2	13276	1	• Passenger Side Snow Deflector
3	13277	2	• Deflector Bar
	08614	1	• Hardware Bag
4	20050	15	•• Bolt H 3/8-16 x 1-1/4" Gr. 2
5	20314	15	•• Locknut 3/8-16
6	20353	30	•• Flat Washer 3/8

SUPER-V 8.5 PARTS LIST

Item	Part No.	Qty	Description
	12579	1	Super-V 8.5 Deflector Kit
1	12535	1	• Drivers Side Snow Deflector
2	12644	1	• Passenger Side Snow Deflector
3	12569	2	• Deflector Bar
	08614	1	• Hardware Bag
4	20050	15	•• Bolt H 3/8-16 x 1-1/4" Gr. 2
5	20314	15	•• Locknut 3/8-16
6	20353	30	•• Flat Washer 3/8

SUPER-V 9.5 PARTS LIST

Item	Part No.	Qty	Description
	12643	1	Super-V 9.5 Deflector Kit
1	12641	1	• Drivers Side Snow Deflector
2	12646	1	• Passenger Side Snow Deflector
3	12642	2	• Deflector Bar
	08614	1	• Hardware Bag
4	20050	15	•• Bolt H 3/8-16 x 1-1/4" Gr. 2
5	20314	15	•• Locknut 3/8-16
6	20353	30	•• Flat Washer 3/8

SUPER-V 10.5 PARTS LIST

Item	Part No.	Qty	Description
	13045	1	Super-V 10.5 Deflector Kit
1	13857	1	• Drivers Side Snow Deflector
2	13856	1	• Passenger Side Snow Deflector
3	13858	2	• Deflector Bar
	08614	1	• Hardware Bag
4	20050	15	•• Bolt H 3/8-16 x 1-1/4" Gr. 2
5	20314	15	•• Locknut 3/8-16
6	20353	30	•• Flat Washer 3/8

Parts indented are included in the carton, bag or assembly under which they are indented.

Meyer Products reserves the right, under its continuing product improvement program, to change construction or design details, specifications and prices without notice or without incurring any obligation.

Meyer Products Inc.
 18513 Euclid Ave. • Cleveland, Ohio 44112-1034
 Phone 486-1313 (Area Code 216)
www.meyerproducts.com • email info@meyerproducts.com