

VEE BLADE PLUG-N-PLOW JOYSTICK CONTROL

- Turn the ON/OFF switch on the control to the ON position. The indicator LED will glow green, indicating the control is ON.
NOTE: The ON/OFF switch can be used as an emergency stop when required.
- HOLD the handle switch to the DOWN position for 1.3 seconds to engage the FLOAT mode. The indicator LED will change from green to red. To cancel the FLOAT mode, momentarily press the handle switch to UP.
FLOAT mode will automatically cancel after 20 minutes, and the indicator LED will turn back to green. To restart FLOAT mode, repeat step 2.

JOYSTICK CONTROL for VEE BLADE

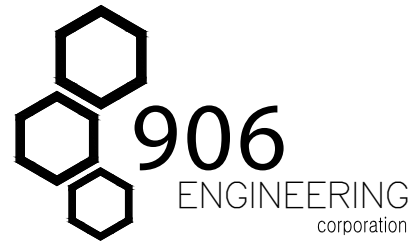

- CURTIS
- SNOWDOGG
- MEYERS (9-Pin) V-66
- MEYERS V-71
- MEYERS V-68 & V70
- BOSS
- HINIKER (Single Acting Cylinders)
- HINIKER (Double Acting Cylinders)
- WESTERN/FISHER (14-Pin)
- AIRFLO

Blade Operation Time Outs

All control functions automatically time out (shut off) after a period of time. This helps reduce wear on the pump motor and prevent unnecessary battery drain.
All functions will time out after 8.0 seconds.

Automatic Shutdown

After being idle for approx. 22 minutes, the control will automatically turn off and the indicator LED will blink from red to green.
To restart the control, turn the control OFF (ON/OFF switch) and then back ON.

Soft Stop

The Control automatically allows the blade to coast to a soft stop. This results in smoother operation and decreased wear on the plows hydraulic system.

Double Tap (UP & FLOAT)

A quick Double Tap of the UP button will automatically raise the plow for 6.0 seconds.
A quick Double Tap of the DOWN button will automatically engage FLOAT (WARNING: Plow will immediately drop to the ground when Double Tapping the DOWN).

NOTE: The Double Tap feature does not replace the normal operation (Press & Hold) of the buttons (UP & DOWN), it is an added feature designed to enhance the performance of the control.

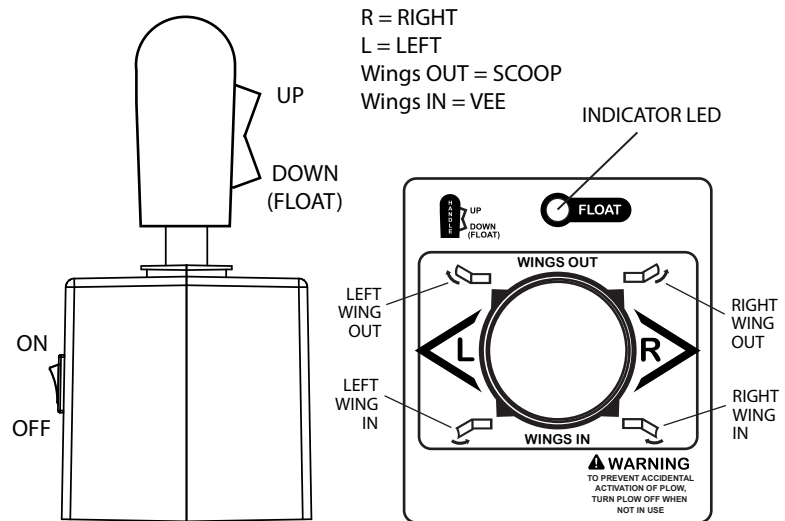

ON/OFF POWER SWITCH (Located on side of joystick case)

ON/OFF SWITCH

NOTE: ON/OFF/ON SWITCH for Blizzard

See your Blizzard plows owners manual about the Power Hitch Operation function.

For Hiniker & Meyers (12-Pin), headlights will switch when the control is plugged in. If you would like a separate headlight switch, contact 906 Engineering Corp. and ask about a headlight switch kit.

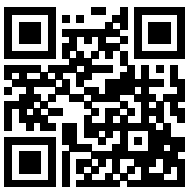

! WARNING

TO PREVENT
ACCIDENTAL ACTIVATION
OF PLOW, TURN PLOW
OFF WHEN NOT IN USE

PULLING UP on the handle will allow you to ROTATE the handle to a left-handed (or right-handed) position.
WARNING: Excessive rotating of the handle can damage the controller & may void your warranty.

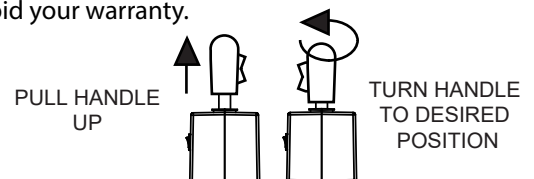

U-SET (User Settings) FEATURE for Vee Blade Joysticks

This feature allows the user to customize features on this control to their own preferences. Customizable features include:

* Soft Stop

* Quick Float

Disclaimer: 906 Engineering is NOT responsible for any damage or injury caused by the use of these customizable features. By changing the settings on the control, you take on all of the liability.

Soft Stop

The standard configuration (out of the box) for this control includes Soft Stop. This feature provides smooth operation and reduces wear on the plows hydraulic system. At times, a plow operator may prefer the plow to have quicker and more precise movements. Follow the instructions below to toggle the Soft Stop feature OFF & ON.



WARNING

Turning OFF the Soft Stop feature could cause damage to your plows hydraulic system and may shorten the life of valves and hoses. Excessive banging may occur with certain manufacturer's plows. Turning OFF the Soft Stop feature is NOT recommended for Meyers/Diamond plows.

1. Turn the control to the OFF position.
2. HOLD the Handle to the "WINGS OUT" position, then turn the control to the ON position. When the indicator light flashes BLUE, RELEASE the handle.
(You are now in programing mode and the control will not operate the plow)
3. MOVE the Handle "RIGHT" once and RELEASE, the indicator light will turn to GREEN. MOVE the Handle "RIGHT" again and RELEASE, the indicator light will turn to RED. The indicator light will toggle between GREEN and RED every time you move the handle to the "RIGHT" and release.

GREEN = Soft Stop - ON
RED = Soft Stop - OFF

4. Once the indicator light is set correctly (GREEN or RED), MOVE the Handle to "WINGS IN" and RELEASE. The indicator light will flash BLUE and your chosen setting is now programed.
5. MOVE the Handle to "WINGS OUT" to exit programing mode. The indicator will glow GREEN and your control is ready to use. Test the control to ensure proper changes were made.

Quick Float

The standard configuration (out of the box) for this control does not include the Quick Float feature. This feature reduces operating time by dropping the plow immediately into FLOAT when DOWN is engaged.

This eliminates the need to hold DOWN for the given time to engage FLOAT. Follow the instructions below to toggle the Quick Float feature ON & OFF.



WARNING

When Quick Float is turned ON, the plow will immediately drop into FLOAT when DOWN is engaged. When using Quick Float, it is recommended that you raise the plow and turn your control OFF (to avoid accidental activation of Float) when driving on the road.

1. Turn the control to the OFF position.
2. HOLD the Handle to the "WINGS OUT" position, then turn the control to the ON position. When the indicator light flashes BLUE, RELEASE the handle.
(You are now in programing mode and the control will not operate the plow)
3. MOVE the Handle "LEFT" once and RELEASE, the indicator light will turn to GREEN. MOVE the Handle "LEFT" again and RELEASE, the indicator light will turn to RED. The indicator light will toggle between GREEN and RED every time you move the handle to the "LEFT" and release.

GREEN = Quick Float - OFF
RED = Quick Float - ON

4. Once the indicator light is set correctly (GREEN or RED), MOVE the Handle to "WINGS IN" and RELEASE. The indicator light will flash BLUE and your chosen setting is now programed.
5. MOVE the Handle to "WINGS OUT" to exit programing mode. The keypad will glow GREEN and your control is ready to use. Test the control to ensure proper changes were made.