

SNO-WAY®

SNOW & ICE CONTROL EQUIPMENT

ASSEMBLY & INSTALLATION INSTRUCTIONS

**VEHICLE MOUNT KIT 99101131
FOR UTV SERIES PLOW**

TO FIT
2009 & Later - Polaris Ranger 800 & Ranger Diesel



©2013 Sno-Way® International

97101820A



1. THINK SAFETY, ALWAYS WEAR SAFETY GLASSES WHEN PERFORMING THE OPERATIONS PRESCRIBED IN THESE INSTRUCTIONS
2. READ ALL INSTRUCTIONS CAREFULLY BEFORE ATTEMPTING INSTALLATION
3. BEFORE BEGINNING WORK MAKE SURE TO SET PARKING BRAKE AND CHOCK WHEELS



ASSEMBLY TOOLS NEEDED

Drill Bits	1/4" - 17/32"
Impact Sockets	7/16" - 1-3/8"
Wrenches	7/16" - 1-3/8"
Torque Wrench	
Rat Tail Pry Bar	
Center Punch and Hammer	
C-Clamp	
Screwdrivers	

INSTALLATION NOTES

1. Vehicle should be parked on a level surface with a normal vehicle load on the FRONT suspension.
2. On some vehicles it may be necessary to raise or stiffen the suspension to decrease the vehicles front suspension sag with the snow plow in place.
3. Unless otherwise specified, mount all Vehicle Mount Kit Components to vehicle before tightening any hardware.
4. It is recommended that LOCTITE®, or similar thread locking product, be used on ALL mounting hardware (i.e. Nuts, Cap Screws, Bolts, etc.).
5. Items in parentheses () refer to quantity required for this step. Items in parentheses with a pound sign (#) indicate the part number as found in the parts list on the last page of this document.
Example: (2) 1/2" Lock Washers (#9).

MOUNTING INSTRUCTIONS

1. Locate and loosen the 3 lower bolts attaching the Bumper/Brush Guard to the frame.

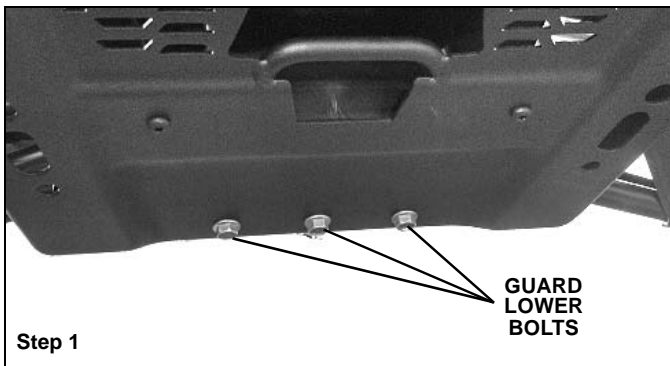

2. Located behind the Bumper/Brush Guard is one bolt on each side attaching it to the frame (DS Shown). Remove both upper bolts and retain for re-installation in the next step.

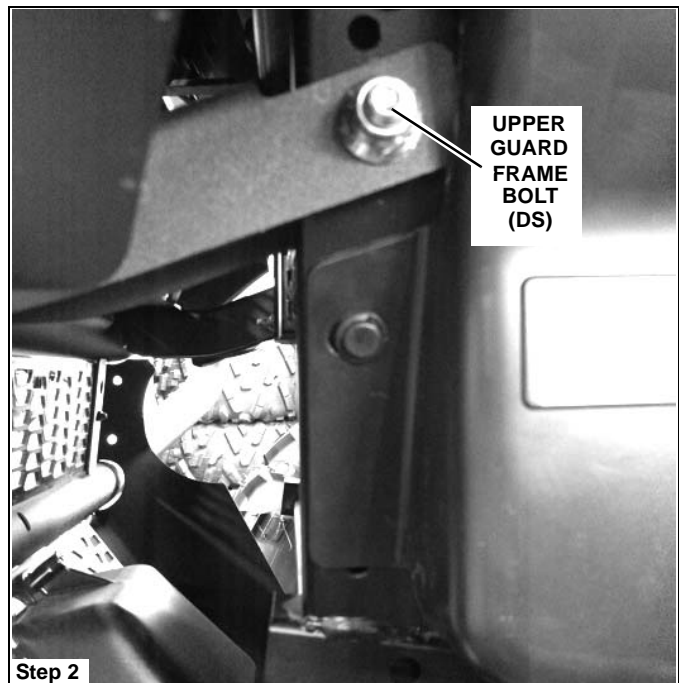

3. Install Top Bracket Weldment, DS (#5) on the driver's side. Align the top hole of the Weldment (#5) to the inside of the frame where the bolt was just removed in step 2. Insert the bolt that was removed in step 2 through the top hole of item and loosely attach with nut.

4. Align the Top Bracket Weldment (#5) lower hole to the outside of the frame with the existing empty hole. Insert (1) 3/8"-16 x 2-1/2" Cap Screw (#8) through the lower hole of the Weldment (#5) and the frame. Loosely attach with (1) 3/8" Locknut (#11).
5. Repeat steps 3 and 4 for installation of the Top Bracket Weldment, PS (#6).
6. Tighten the 3 lower bolts for the Bumper/Brush Guard that were loosened in step 1.
7. Align the Driver's Side Front Bracket (#3) over the two holes in the Bumper/Brush Guard that are aligned under the two bottom holes in the Top Bracket Weldment, DS (#5). Install (2) 3/8"-16 x 1-1/4" Cap Screw (#7) and (2) 3/8" Flat Washers (#10) through the Driver's Side Front Bracket (#3), Bumper/Brush Guard and Top Bracket Weldment (#5). Loosely secure with (2) 3/8" Locknuts (#11).
8. Repeat step 7 for installation of the Passenger Side Front Bracket (#4).
9. Place the Bottom Bracket Weldment (#2) on the skid plate and align the 5 holes in the Weldment (#2) with the 5 empty holes in the skid plate.
10. Insert (3) 3/8"-16 x 1-1/4" Cap Screws (#7) through the three holes in the front of Bottom Bracket Weldment (#2) and loosely secure with (3) 3/8" Locknuts (#11). Then, attach the remaining two holes in Bottom Bracket Weldment (#2) with (2) 5/16"-18 x 1" Cap Screws (#9) and (2) 5/16" Locknuts (#12).

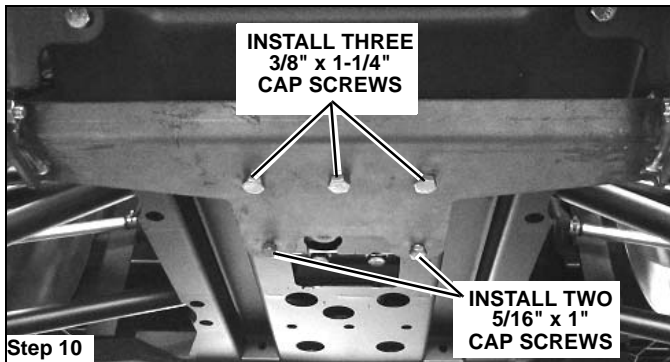

11. Attach each Front Bracket (#3 & 4) to the Bottom Bracket Weldment (#2) using (2) 3/8"-16 x 1-1/4" Cap Screw (#7) and (2) 3/8" Locknuts (#11).

12. Position the UTV Mount (#1) on the machine. Align the UTV Mount holes with both Front Brackets (#3 & 4) to provide an 11" to 12" height between the lower pin slots and the ground.

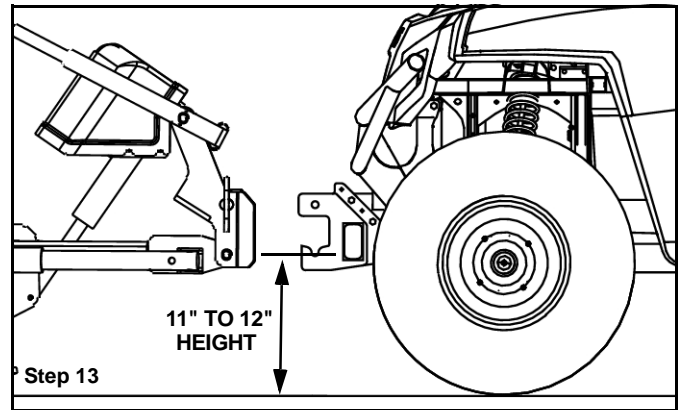

IMPORTANT: Height from the bottom of the lower pin slots on the UTV Mount to the ground should be between 11" and 12" to ensure proper operation.

13. Secure the UTV Mount (#1) to both Front Brackets (#3 & 4) using (6) 3/8"-16 x 1-1/4" Cap Screws (#7) and (6) 3/8" Locknuts (#11)..
14. Tighten all hardware using the Torque Specification Chart provided.

TORQUE SPECIFICATIONS FOR STANDARD MACHINE HARDWARE					
Bolt Size	GR.2 Dry	GR.5 Dry	GR.8 Dry	Metric Size	GR.8.8 Dry
1/4"	66*	9	12	M8	17
5/16"	11	17	25	M10	35
3/8"	20	30	45	M12	60
7/16"	32	50	70	M14	95
1/2"	50	75	110	M16	155
9/16"	70	110	150		
5/8"	100	150	220		
3/4"	175	260	380		
7/8"	170	430	600		
1"	250	640	900		

These torque values are to be used for all hardware. Unless otherwise specified, all torque values must meet this specification.
All torque values are in Ft.-Lbs unless otherwise stated
*In-Lbs

REMEMBER After 5 to 10 hours of snowplow usage, re-torque all hardware!

PARTS LIST

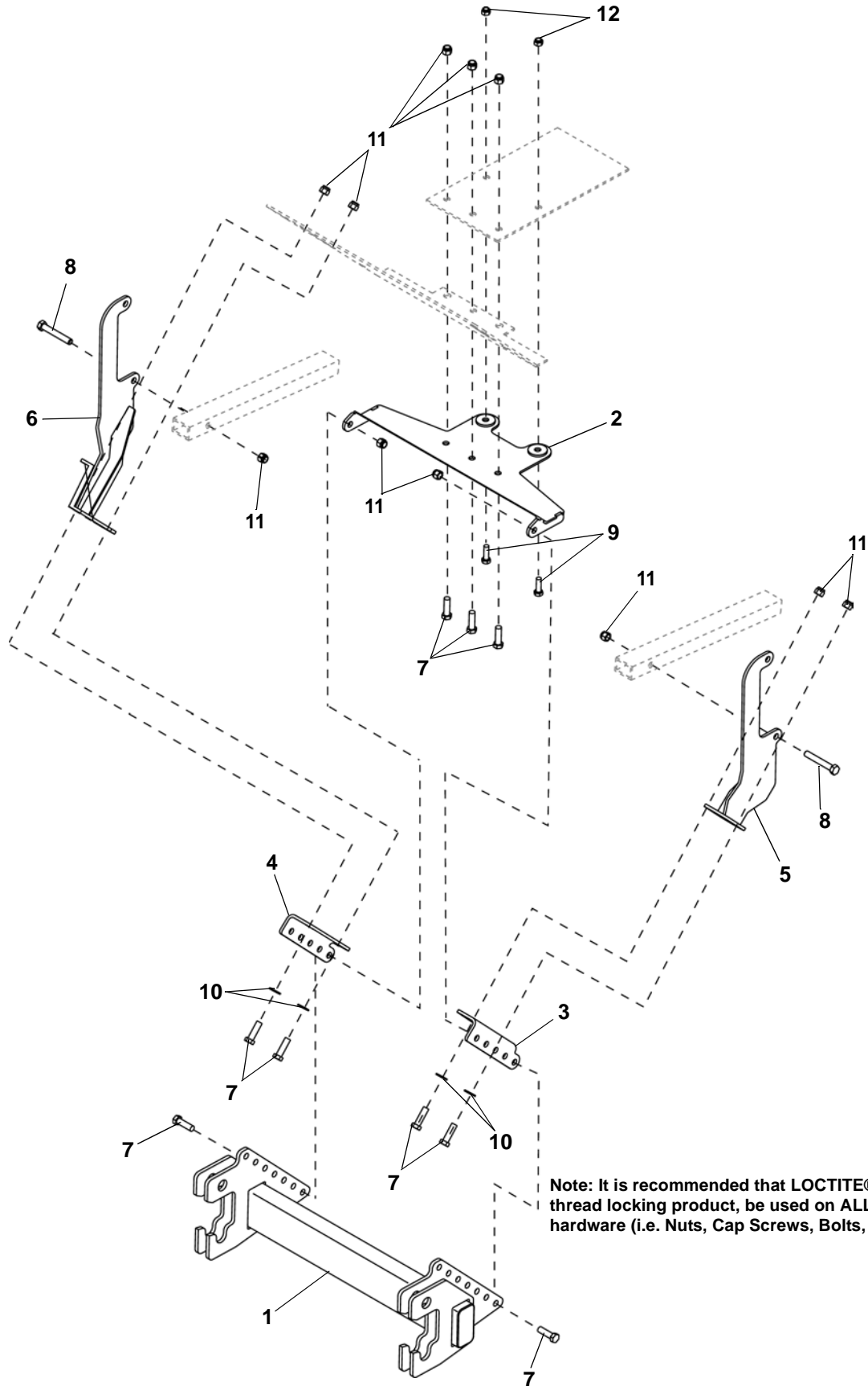

Note: It is recommended that LOCTITE®, or similar thread locking product, be used on ALL mounting hardware (i.e. Nuts, Cap Screws, Bolts, etc.).

PARTS LIST

ITEM	PART NO.	DESCRIPTION	QTY.
1		UTV Polaris Mount	1
2		Weldment, Bottom Bracket, Polaris.....	1
3		Bracket, Front, DS, Polaris 800.....	1
4		Bracket, Front, PS, Polaris 800.....	1
5		Weldment, Top Bracket, DS, Polaris 800	1
6		Weldment, Top Bracket, PS, Polaris 800	1
7		HHCS, 3/8"-16 x 1-1/4"	15
8		HHCS, 3/8"-16 x 2-1/2"	2
9		HHCS, 5/16"-18 x 1".....	2
10		PW, 3/8".....	4
11		LN, 3/8"-16	17
12		LN, 5/16"-18	2
13	96115041	Kit, HDWE (Not Shown) (Includes Items 7-12)	1

SNO-WAY[®] INTERNATIONAL, INC.



Hartford, WI 53027 USA
Website: www.snoway.com
©2013 Sno-Way[®] International

www.storksplows.com