

# **SNO-WAY**®

**SNOW & ICE CONTROL EQUIPMENT**

## **ASSEMBLY & INSTALLATION INSTRUCTIONS**

**VEHICLE MOUNT KIT 99101282  
AND  
VEHICLE CENTER MEMBER  
FOR 26 SERIES: 99100890**

**TO FIT  
2017 - LATER NISSAN TITAN 4X4**

Sno-Way®; Down Pressure® and EIS® are registered trademarks of Sno-Way International, Inc. ProControl™, MegaBlade™, V-Wing™, E-Z Switch™, Revolution™, MaxAdjust™, SpeedLock™, and QuickJack™ are trademarks of Sno-Way International, Inc.

©2017 Sno-Way® International

97102116A



1. THINK SAFETY, ALWAYS WEAR SAFETY GLASSES WHEN PERFORMING THE OPERATIONS PRESCRIBED IN THESE INSTRUCTIONS
2. READ ALL INSTRUCTIONS CAREFULLY BEFORE ATTEMPTING INSTALLATION
3. BEFORE BEGINNING WORK MAKE SURE TO SET PARKING BRAKE AND CHOCK WHEELS



## MINIMUM VEHICLE RECOMMENDATIONS

Heavy Duty Alternator

Heavy Duty Battery

*NOTE: On some vehicles it may be necessary to use a form of load booster to decrease the vehicle's front suspension sag with the snow plow in place. This can be accomplished with the use of supplementary air bags, booster springs, or similar load boosting devices. Since there are different load boosting devices available, it will up to the customer/end user to decide and purchase the product to suit the application, and not the responsibility of Sno-Way International, Inc.*

## INSTALLATION NOTES

1. Unless otherwise specified, mount all Vehicle Mount Kit components to vehicle before tightening any hardware.
2. It is recommended that LOCTITE®, or similar thread locking product, be used on ALL mounting hardware (i.e. Nuts, Cap Screws, Bolts, etc.).
3. Vehicle should be parked on a level surface with a normal vehicle load on the FRONT suspension.
4. Items in parentheses ( ) refer to quantity required for this step. Items in parentheses with a pound sign (#) indicate the part number as found in the parts list on the last page of this document.  
Example: (10) Washer, Lock, 1/2" (#8).
5. It maybe necessary to relocate license plate holder. Check state and local laws for placement, if needed.

## ASSEMBLY TOOLS NEEDED

Drill Bits	1/4 – 17/32"
Sockets	7/16" – 1-3/8"
	10mm – 18mm
Wrenches	7/16" – 1-3/8"
	10mm – 18mm
Torque Wrench	
Center Punch	
Hammer	

## MOUNTING INSTRUCTIONS

1. Dismount the splash guard and bumper from the vehicle. Remove tow hooks if equipped.
2. Remove the plastic guards found between frame rail and radiator (both Driver and Passenger side). Pull the plastic fasteners holding it in place, then pull down and toward the center of the vehicle to slide them out (See Figure 1 and Figure 2). This will make holes that are drilled later accessible.

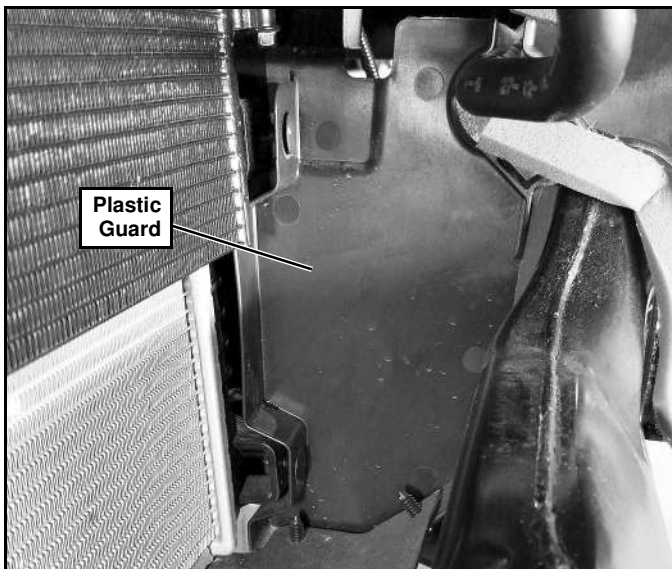

Figure 1



Figure 2 (Shown with Plastic Guard Removed)

3. Hold the Driver Side Mount Weldment (#2) to the truck frame as shown in Figure 3. Clamp the rear end of the mount to the inside of the truck frame rail. Clamp the front end of the mount to the bottom side of the truck frame. Make sure the mount is also tight against the truck's front crossmember.

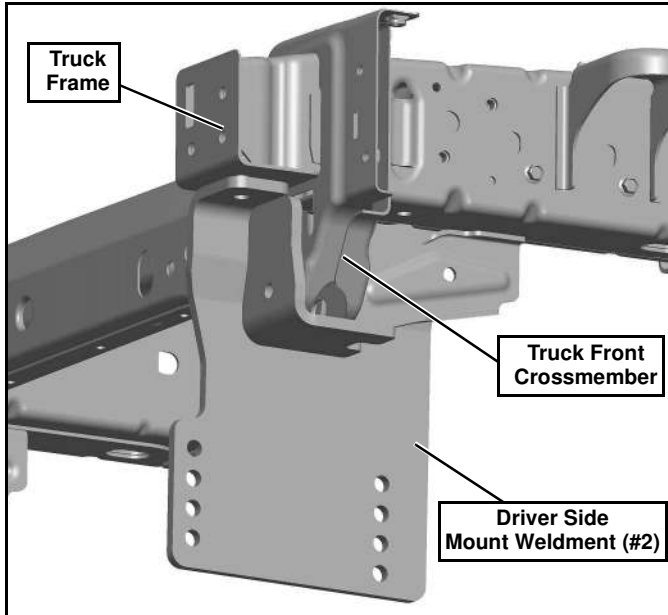

Figure 3

4. Use the four hole holes in Driver Side Mount Weldment (#2) as a template to center punch and drill  $\frac{1}{4}$ " pilot then  $\frac{17}{32}$ " holes in the truck frame (not through both sides of the frame) (See Figure 4).

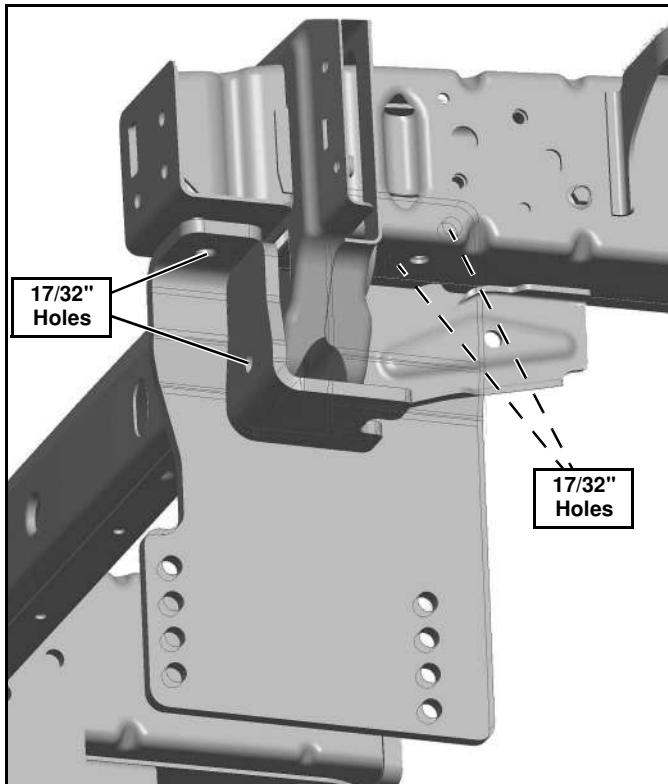

Figure 4

5. Insert a Nut Plate Weldment (#5) through the rectangular slot in the front of the truck frame and bend the wire as needed to align with the drilled hole (See Figure 5).

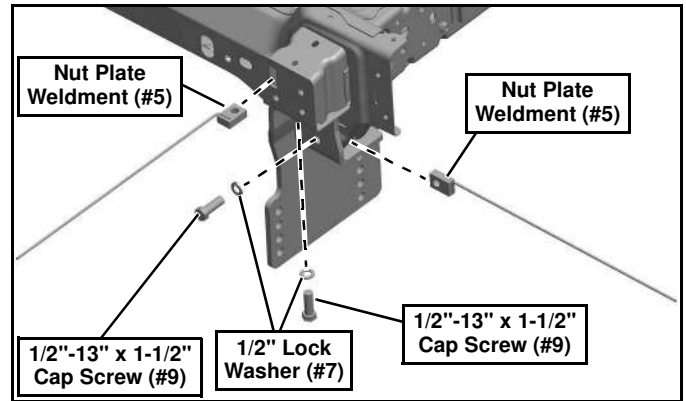

Figure 5

6. Fasten the front end of the Driver Side Mount Weldment (#2) to the truck. Use a  $\frac{1}{2}$ " Lock Washer (#7) and a  $\frac{1}{2}$ "-13 x 1- $\frac{1}{2}$ " Cap Screw (#9) to thread into the Nut Plate Weldment (#5) on the inside the frame (See Figure 5). Make sure the Nut Plate Weldment (#5) rests flat in the frame rail and does not get caught on any weld nuts located inside. Remove any excess wire sticking out of the frame because a tab in the bumper will need to stick back into this slot during re-assembly.

7. Fasten the lower hole to the front cross member. Use a Nut Plate Weldment (#5), a  $\frac{1}{2}$ " Lock Washer (#7) and a  $\frac{1}{2}$ "-13 x 1- $\frac{1}{2}$ " Cap Screw (#9) (See Figure 5). Remove any excess handle sticking out of the frame.

8. Insert a  $\frac{1}{2}$ "-13 x 1- $\frac{1}{2}$ " Handle Bolt Weldment (#6) into the frame rail and fasten one of the two holes in the rear side of the Driver Side Mounting Weldment (#2) with a  $\frac{1}{2}$ "-13 Locknut (#8) (See Figure 6). Use the hole in the top of the frame rail, just behind the front crossmember to access the inside of the frame. Bend the handle as needed and remove any excess handle sticking out of the frame. Repeat this step once more to fasten the second hole.

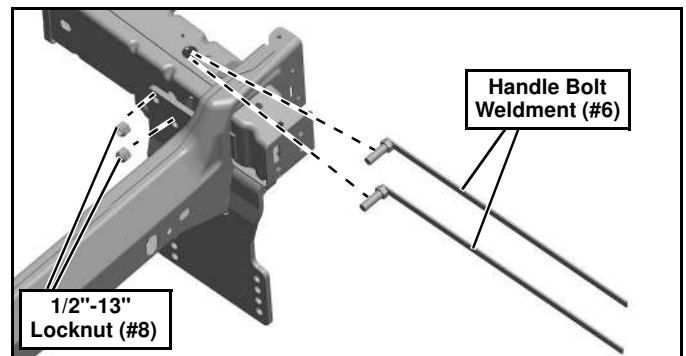

Figure 6

9. Remove the clamps and repeat steps 3-8 for installing the Passenger Side Mount Weldment (#3).

10. Put back in the plastic guards that were removed in step 2. Modify them if necessary to fit around the Mounting Weldments (#2 & 3).

11. Remove the lower valance from the bumper, if equipped. Cut a 1-3/4" x 3/4" slot in the bumper as shown on each side, so the Mounting Weldments (#2 & 3) do not interfere with the bumper. Measure from the edge of the lower bumper bracket and flat edge of the indent. (See Figure 7 and Figure 8.)

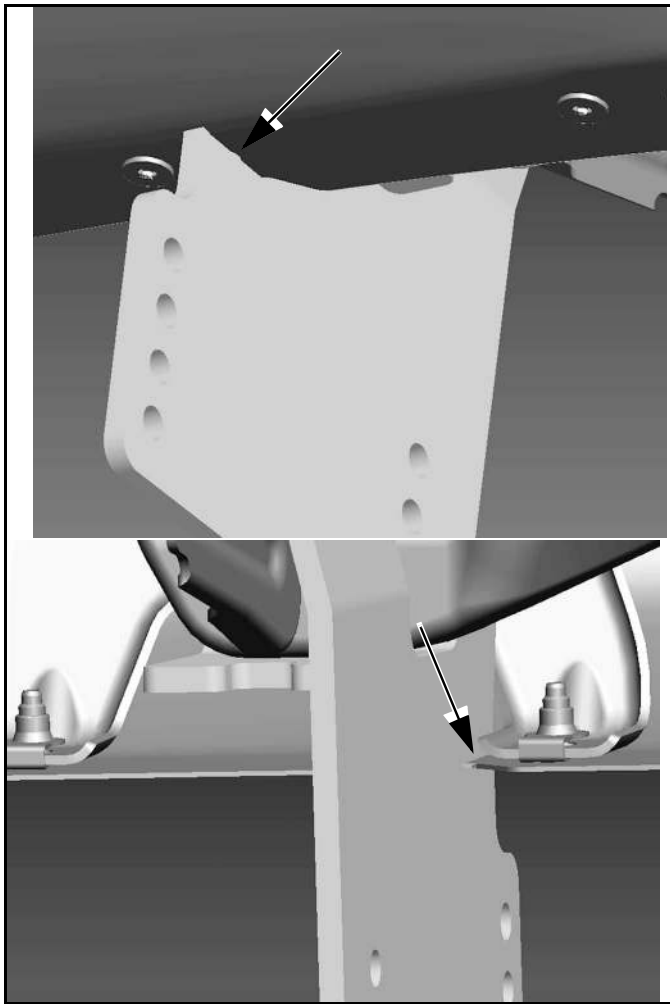

Figure 7

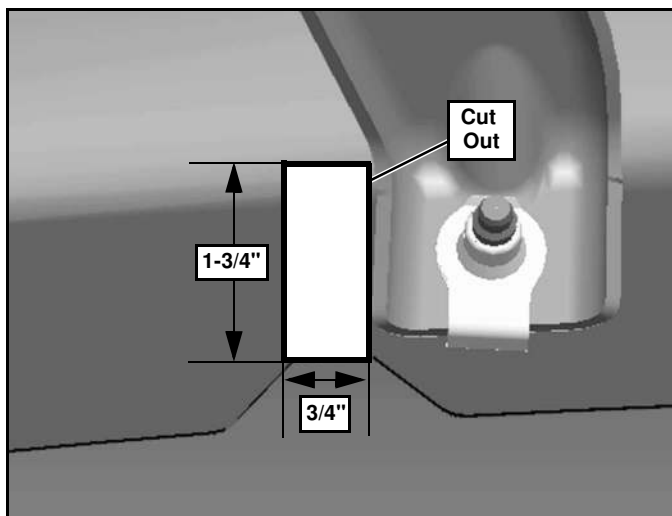

Figure 8

12. Install the bumper back onto the truck.

13. Attach the Vehicle Center Member (#1) to the Driver and Passenger Side Mount Weldments (#2 & 3). Secure using (4) 1/2" Spacer Plates (#4), (2) 1/2" Lock Washers (#7), (8) 1/2"-13 x 2" Cap Screws (#10), and (6) 1/2"-13 Locknuts (#8).

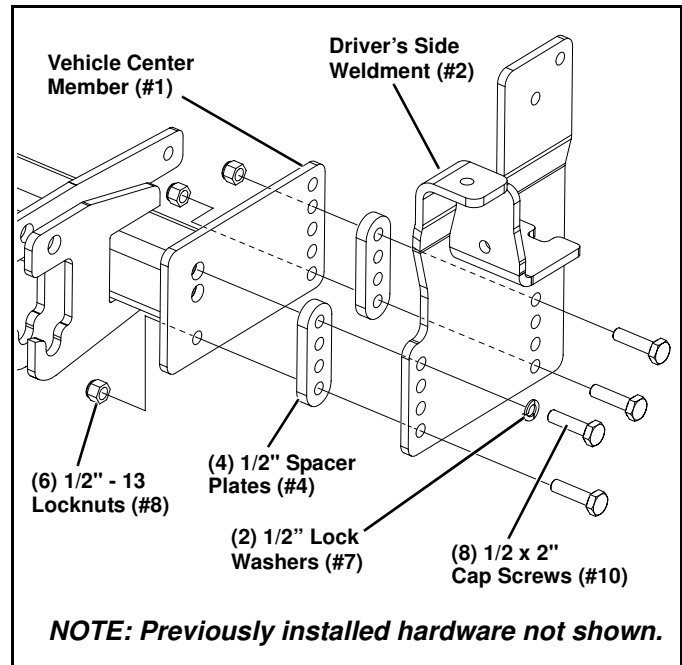

Figure 9

14. Using the torque specification chart provided (on the following page), torque all bolts.

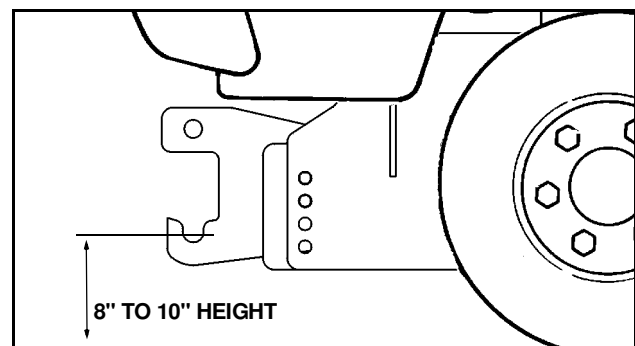

Figure 10

**IMPORTANT:** Height from the center of the lower plow mounting holes on the Vehicle Mount Kit to the ground should be between 8" and 10" to insure proper operation.

**NOTE: When mounting to the desired height for 26 series Vehicle Center Mounts, the vehicle could either be raised or the top inside lugs of the Vehicle Center Mount can be cut off and touched up with paint so to avoid interfering with the bumper (See Figure 11).**

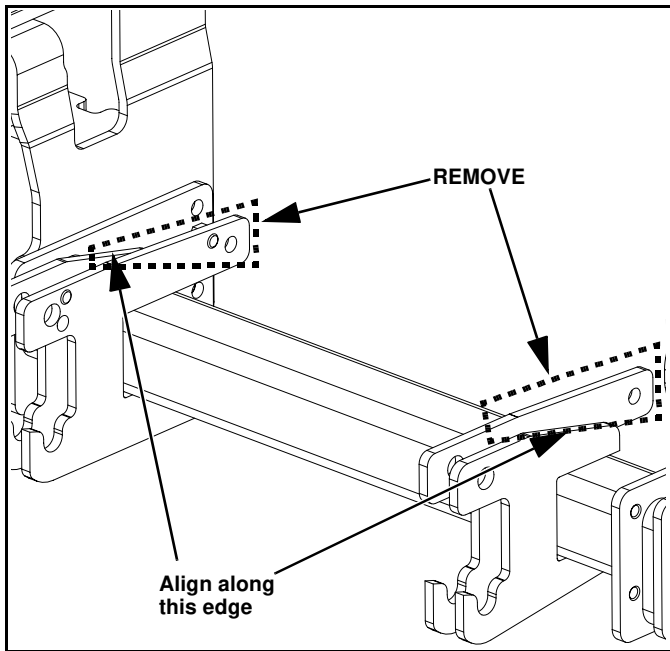

Figure 11

TORQUE SPECIFICATIONS FOR STANDARD MACHINE HARDWARE					
Bolt Size	GR.2 Dry	GR.5 Dry	GR.8 Dry	Metric Size	GR.8.8 Dry
1/4"	66*	9	12	M8	17
5/16"	11	17	25	M10	35
3/8"	20	30	45	M12	60
7/16"	32	50	70	M14	95
1/2"	50	75	110	M16	155
9/16"	70	110	150		
5/8"	100	150	220		
3/4"	175	260	380		
7/8"	170	430	600		
1"	250	640	900		

Note: These torque values are to be used for all hardware. Unless otherwise specified, all torque values must meet this specification.  
 Note: All torque values are in Ft.-Lbs unless otherwise stated  
 Note: \*In-Lbs

**NOTE: After 5 to 10 hours of snowplow usage, re-torque all Cap Screws!**

# PARTS LIST

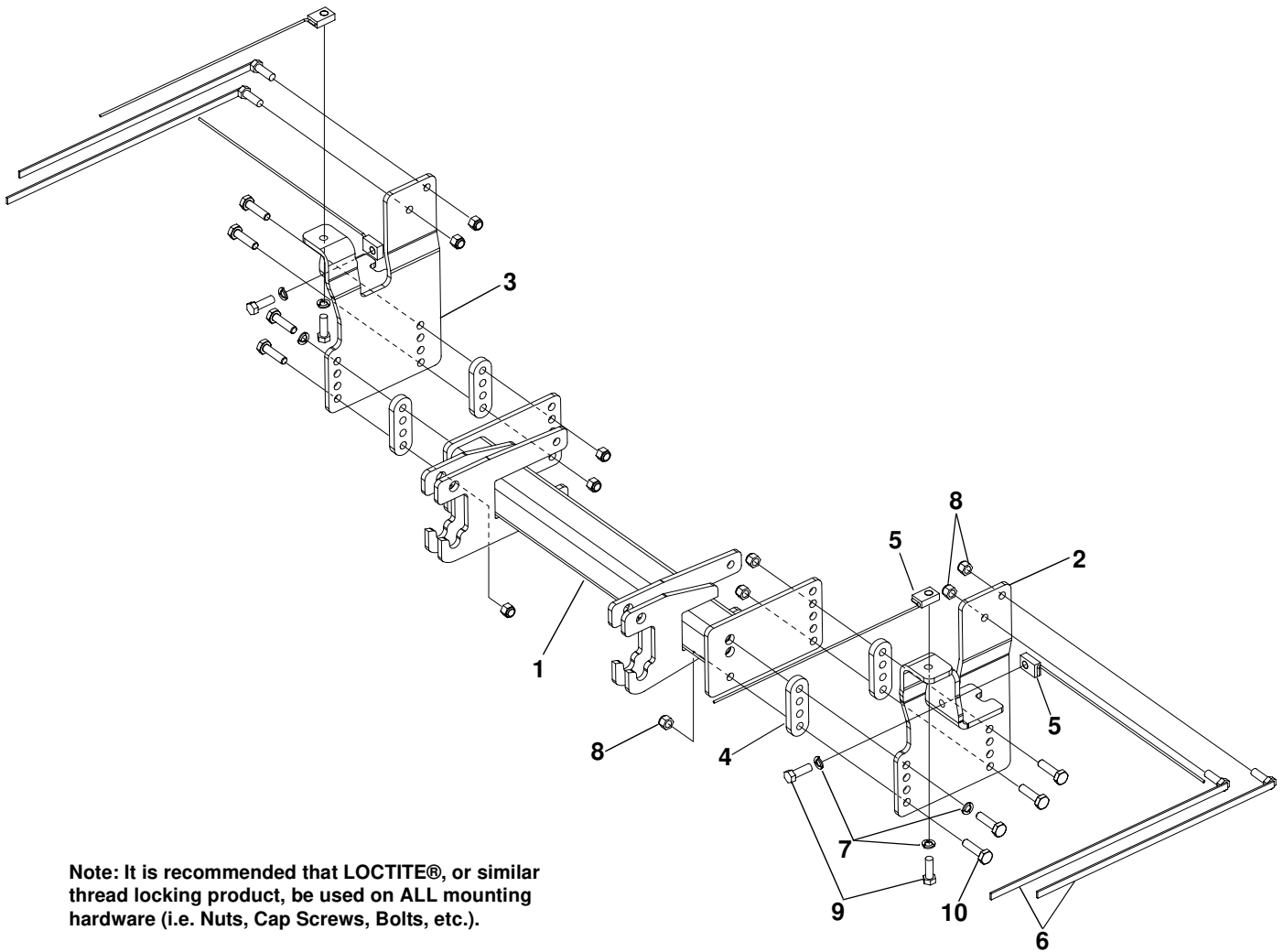

Note: It is recommended that LOCTITE®, or similar thread locking product, be used on ALL mounting hardware (i.e. Nuts, Cap Screws, Bolts, etc.).

ITEM	PART NO.	DESCRIPTION	QTY.
1	99100890	Vehicle Center Member, 26 Series .....	1
2		Weldment, Mount, DS .....	1
3		Weldment, Mount, PS.....	1
4		Spacer Plate, 1/2" .....	4
5		Weldment, Nut Plate.....	4
6		Handle Bolt Weldment, 1/2"-13 x 1-1/2" .....	4
7		LW, 1/2" .....	6
8		LN, 1/2"-13 .....	10
9		HHCS, 1/2"-13 x 1-1/2".....	4
10		HHCS, 1/2"-13 x 2".....	8
11	96116702	Kit, HDWE (Includes items 4-10) (Not Shown).....	1

# NOTES

---

**SNO-WAY® INTERNATIONAL, INC.**



Hartford, WI 53027 USA  
Website: [www.snoway.com](http://www.snoway.com)  
©2017 Sno-Way® International

[www.storksplows.com](http://www.storksplows.com)