

Fisher Engineering

P.O. Box 529 Rockland, Maine 04841

January 11, 2000

Lit. No. 20547

Minute Mount[®]

SYSTEM

Attachment Kit

Chevy/GMC
C3500 HD 2 WD Straight Axle 1990-20__

⚠ CAUTION

See your FISHER[®] outlet for application recommendations. The Kit Selection Guide has specific vehicle and snowplow requirements.

Table of Contents

Attachment Kit Assembly	2
Bolt Bag Parts List	2
Installation Instructions	3

7144 KIT PARTS LIST

7144 Attachment Kit					
Part #	Qty	Description	Part #	Qty	Description
20557	1	Pushplate – Driver Side	7892	2	Backing Plate
20558	1	Pushplate – Passenger Side	7928	2	5/8" x 1-1/2" Bolt w/ Handle
8661	1	Angle Brace	20545	1	Bolt Bag – 7144

PARTS LIST AND DIAGRAM

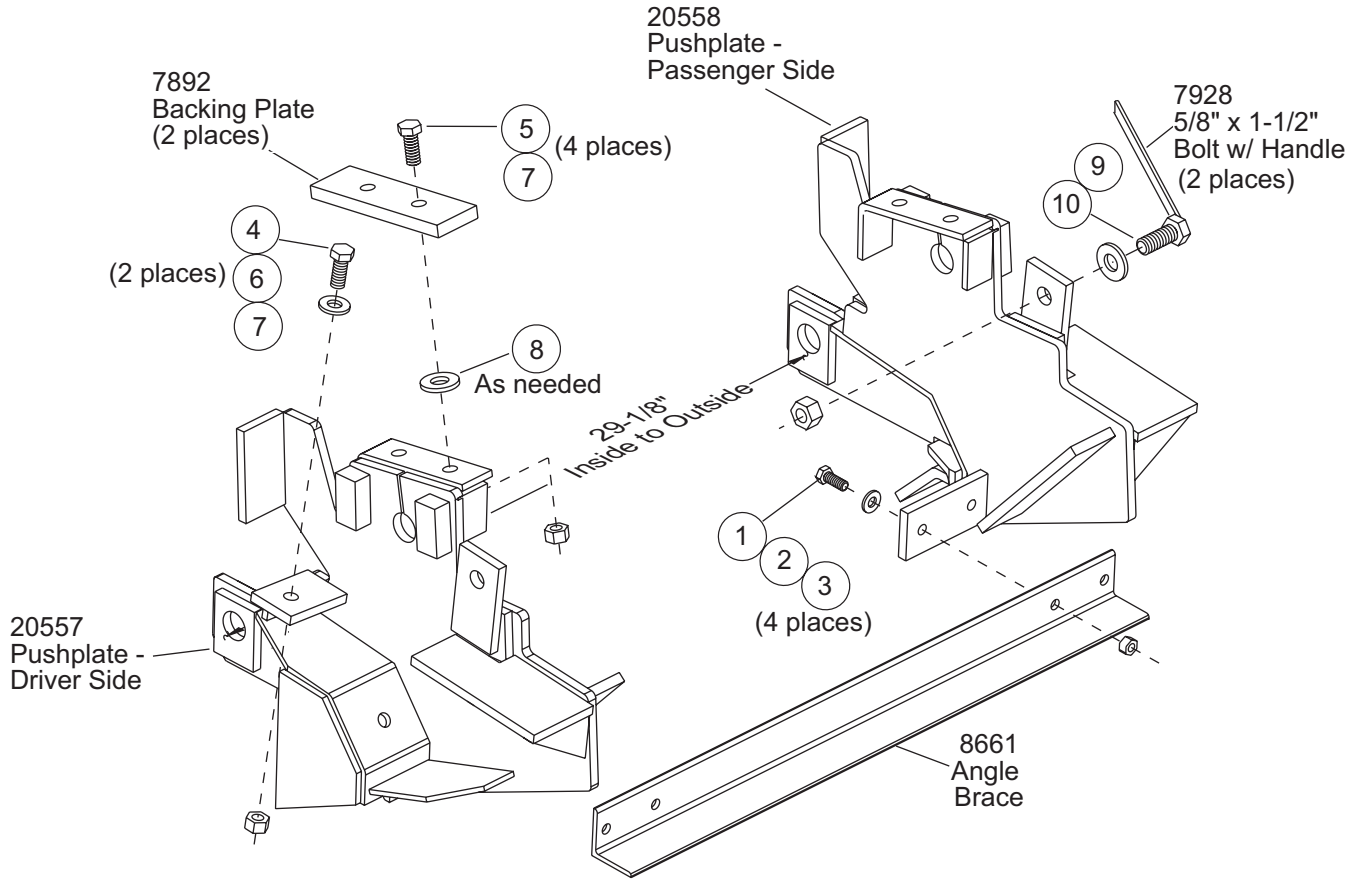

NOTE: Use bottom holes of A-frame when attaching A-frame to lower gear to obtain proper clearance during operation.

Bolt Bag – 20545							
Ref #	Part #	Qty	Description	Ref #	Part #	Qty	Description
1	90103	4	3/8"-16 x 1" Gr. 5 Cap Screw	6	90572	2	1/2" Gr. 8 Flat Washer
2	90315	4	3/8" Flat Washer	7	90355	6	1/2"-13 Locknut
3	90352	4	3/8"-16 Locknut	8	90323	6	5/8" Flat Washer
4	90210	2	1/2"-13 x 1-1/2" Gr. 5 Cap Screw	9	90576	2	5/8" Gr. 8 Flat Washer
5	90217	4	1/2"-13 x 2" Gr. 5 Cap Screw	10	5573	2	5/8"-11 Locknut

SAFETY INFORMATION

⚠ WARNING



Indicates a potentially hazardous situation that, if not avoided, could result in death or serious personal injury.

⚠ CAUTION

Indicates a situation that, if not avoided, could result in minor personal injury and/or damage to product or property.

NOTE: Identifies tips, helpful hints and maintenance information the owner/operator should know.

Torque all fasteners according to the torque chart. For proper fit, do not tighten fasteners until instructed to do so.

DIAMETER- THREADS PER INCH	NC FASTENER TORQUE (FT-LB)		
	GRADE		
			
	G2	G5	G8
1/4 - 20	6	9	13
5/16 - 18	11	18	28
3/8 - 16	19	31	46
7/16 - 14	30	50	75
1/2 - 13	45	75	115
9/16 - 12	66	110	165
5/8 - 11	93	150	225
3/4 - 10	150	250	370
7/8 - 9	150	378	591
1 - 8	220	583	893

INSTALLATION INSTRUCTIONS

- Remove and discard two inner and lower bumper bolts.
- Place driver-side pushplate inside of frame and leaf spring. Align front tab on pushplate with hole in bumper from previously removed fastener. Attach pushplate with a 1/2" x 1-1/2" cap screw and Gr. 8 flat washer down from top bumper hole and pushplate and secure with a 1/2" locknut.
- Check to see if the inside-to-outside distance between the connecting pin arms on pushplate is 29-1/8". To ensure the arms are parallel, take a second measurement farther back on the arms. This measurement must be the same as the first. Adjust if necessary and fully tighten the 3/8" angle brace fasteners.

Jack pushplates up against vehicle frame and tighten remaining pushplate fasteners.

NOTE: A floor jack may be required to align hole in rear tab on pushplate with slot on inside of frame.

Insert a 5/8" bolt with handle with a Gr. 8 flat washer inside frame (from front) and out through slot and rear tab on pushplate. Secure with a 5/8" locknut.

- Repeat step 2 for passenger-side pushplate.
- Place angle brace on inner tabs of pushplates with angle leg down and facing rearward. With heads of cap screws facing forward, attach with four 3/8" x 1" cap screws and flat washers. Secure with four locknuts on back side of angle brace.
- Using the remaining holes in pushplates as guides, drill two 17/32" holes through vehicle cross member above each pushplate. Place 5/8" flat washers between cross member and pushplates to fill gap if needed. Place backing plate on top of cross member. Fasten to pushplates by putting four 1/2" x 2" cap screws down through the cross member. Secure with locknuts.
- Make sure all fasteners are fully tightened.

Copyright © 2000 Douglas Dynamics, L.L.C. All rights reserved. This material may not be reproduced or copied, in whole or in part, in any printed, mechanical, electronic, film or other distribution and storage media, without the written consent of Fisher Engineering. Authorization to photocopy items for internal or personal use by Fisher Engineering outlets is granted.

Fisher Engineering reserves the right under its product improvement policy to change construction or design details and furnish equipment when so altered without reference to illustrations or specifications used herein. Fisher Engineering and the vehicle manufacturer may require and/or recommend optional equipment for snow removal. Fisher Engineering offers a limited warranty for all snowplows and accessories. See separately printed page for this important information. The following are registered (®) trademarks of Douglas Dynamics, L.L.C.: FISHER®, Minute Mount®

Printed in USA