

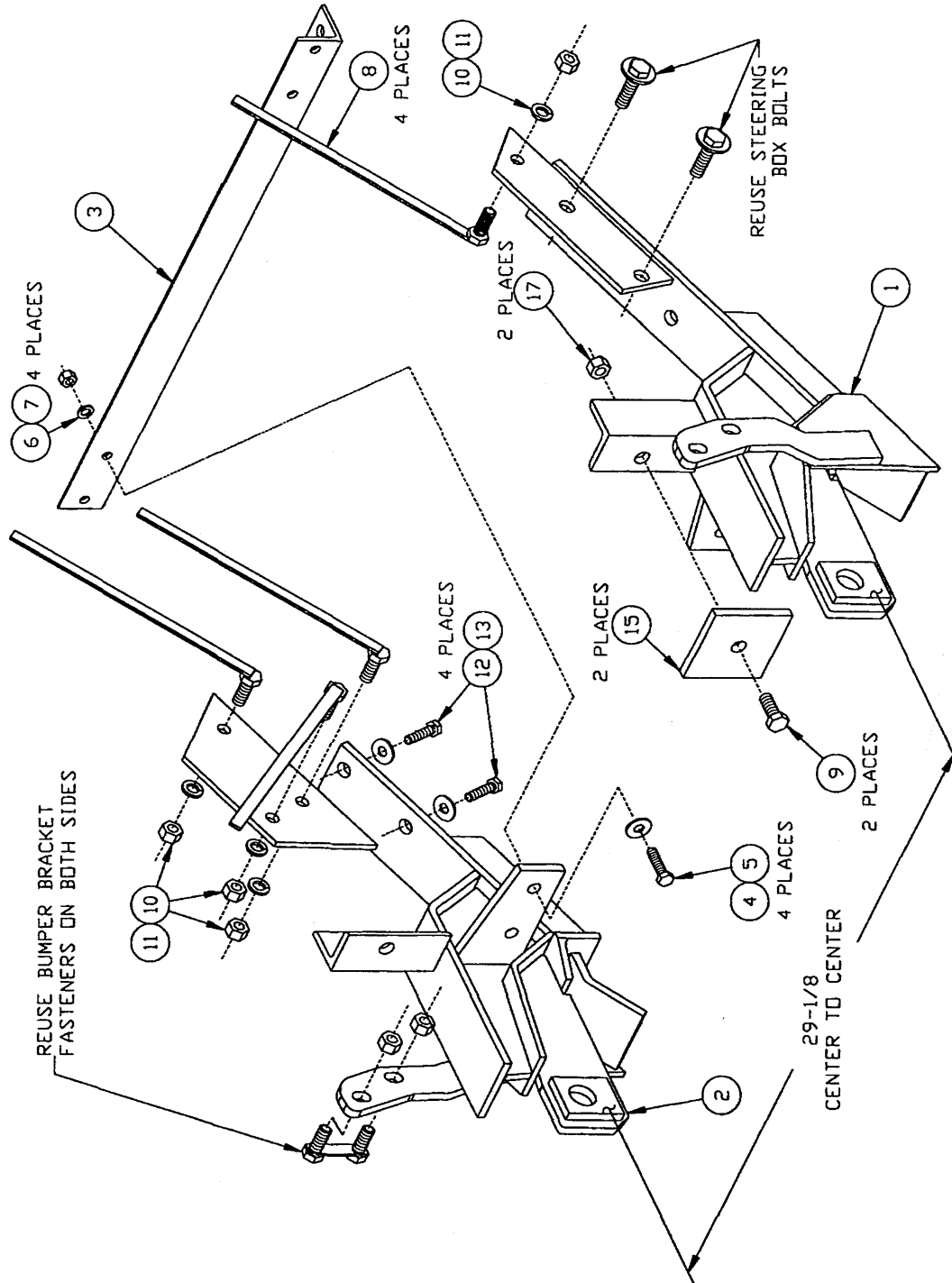

Dodge
2500 w/AHD and 8800 GVW
3500 w/AHD and 10,500 GVW
Except 3500 Cab-Chassis Models

1997
1997

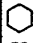

Parts List

Ref #	Part #	Qty	Description
1	21404	1	Pushplate - Dr. Side
2	21405	1	Pushplate - Pass Side
3	8661	1	Angle Brace
	21413	1	Bolt Bag for 7153 – includes the following parts:
4	90106	4	3/8-16 x 1-1/4" Gr.5 Cap Screw
5	90315	4	3/8" Plain Washer
6	90361	4	3/8" Split Lock Washer
7	90334	4	3/8"-16 Nut
9	90210	2	1/2-13 x 1-1/2" Gr.5 Cap Screw
10	90364	4	Split Lock Washer
11	90337	4	1/2"-13 Nut
12	90636	4	M10 x 1.50 x 40 Gr. 10.9 Cap Screw
13	90420	4	M10 Plain Washer
17	90355	2	1/2"-13 Locknut
59	8324	4	Hose Tie - 3/16" x 14"
62	90615	4	1/4 x 1/2" (NC) Gr.5 Cap Screw
63	90350	4	1/4" (NC) Nut
75	3666	4	Hose Tie - 3/16 x 8"
83	90461	4	1/4 x 3/4" (NC) Gr. 5 Cap Screw
85	90359	4	1/4" Lock Washer
86	90330	4	1/4" (NC) Nut
87	90311	4	1/4" Flat Washer
	21412	1	Bracket Bag for 7153 – incl. the following parts
8	8879	4	1/2-13 x 1-1/4" Gr.5 Cap Screw With Handle
15	21411	2	Backing Plate
61	8914	2	Grille Bracket

NC FASTENER TORQUE (FT-LB)			
DIAMETER- THREADS PER INCH	GRADE		
			
	G2	G5	G8
1/4 - 20	6	9	13
5/16 - 18	11	18	28
3/8 - 16	19	31	46
7/16 - 14	30	50	75
1/2 - 13	45	75	115
9/16 - 12	66	110	165
5/8 - 11	93	150	225
3/4 - 10	150	250	370
7/8 - 9	150	378	591
1 - 8	220	583	893

Important Notice:

Fisher Engineering recommends that the 7153 Peculiar Attachment Kit only be installed on the following vehicles:

Dodge 2500 with AHD package and 8800 pound GVW

Dodge 3500 with AHD package and 10,500 pound GVW (except Cab Chassis Models)

1. Remove the frame brackets from the sway bar and discard the fasteners. Remove and save the two forward bumper bracket bolts on the clips from both sides of the vehicle. Remove and save the two lower steering box bolts from the driver side of the frame.
2. Place the driver-side pushplate (1) with angle and side bar portions straddling the frame. Place the two forward bumper bracket bolts on the clips back through bracket and the front hanger on the pushplate. Do not tighten fasteners at this time. Reinstall both steering box bolts. Place a backing plate (15) inside the forward part of the cross member. Install a 1/2 x 1-1/2" cap screw (9) through the backing plate, cross member and pushplate angle. Fasten with a 1/2" locknut (17).
3. Insert a 1/2 x 1-1/2" cap screw with handle (8) through the large hole in the frame at the back of the pushplate. Bend the handle as necessary. Insert the cap screw out through the frame and rear hole of pushplate. Fasten with 1/2" lock washer (10) and nut (11).

4. Repeat steps #2 and #3 for the passenger-side pushplate (2), except for the top hole on side plate. Insert a 1/2 x 1-1/2" cap screw with handle (8) in through the square hole with the bumper brace attached and out through frame and top hole in rear side plate on pushplate. Fasten with 1/2" lock washer (10) and nut (11).
5. Reattach the sway bar brackets to the pushplates and frame with four M10 x 1.5 x 40 cap screws (12) and flat washers (13). Install the angle brace (3), with the leg on the bottom facing the rear, to the back of the inner tabs on the pushplate. Attach to the pushplates from front to rear of vehicle with four 3/8 x 1-1/4" cap crews (4), flat washers (5), lock washers (6) and nuts (7). Measure the distance between the connecting pin doublers. The distance should be 29-1/8" from center to center. A second measurement must be taken further back on the arms to ensure they are parallel.
6. Tighten the sway bar bolts first, the steering box bolts second and then all remaining fasteners. Use the two rear holes on the passenger-side pushplate as guides to drill two 17/32" holes through the frame. Bend the handles as needed and install two 1/2 x 1-1/2" cap screws with handle (8) through frame using the two large holes behind the pushplate. The rear sway bar fastener may have to be loosened to get the forward cap screw in. Attach with two 1/2" lock washers (10) and nuts (11). Bend the handles on all cap screws with handles to prevent contact with any vehicle components.

Grille Bracket Installation

A. For vehicles with under-hood hydraulics:

Install the grille brackets according to the peculiar hydraulic installation instructions.

B. For vehicles with out-front hydraulics:

Install grille brackets and panel mounts according to the hydraulic installation instructions.

Regular Duty vehicles with bumper "Sight Shield" provided with Laramie SLT package:

Place a grille bracket (61) on back of the grille plate as shown in the illustration. Attach with two 1/4 x 1/2" cap screws (62) and locknuts (63). Place the grille plate and bracket into the large hole in driver-side of the bumper. Use the holes in the grille plate as a guide to drill two 1/4" holes on both sides of the grille plate in line with grille plate holes; four holes in total. Fasten the bottom of the grille plate to the drilled holes with two tie wraps (75) and the top bracket to top plastic bumper liner with two long tie wraps (59).

Regular and Heavy Duty vehicles without bumper "Sight Shield":

Install the same as the regular duty with "sight shield", except position the grille brackets outwards in the large bumper openings against the bumper brackets. Insert four 1/4 x 3/4" cap screws (83) with flat washers (87) down through the bumper and bracket, using the holes in the grille brackets. Fasten with four lock washers (85), and nuts (86).

Heavy duty vehicles with bumper "Sight Shield":

Either remove the "Sight Shield" or cut as needed to install the grille brackets the same as vehicles without "Sight Shield". Another option is to not use the grille plates and brackets. Simply install the disconnects and dust plugs to ends of the lift and angle hoses and store inside the bumper when not in use.

