



Fisher Engineering

P.O. Box 529 Rockland, Maine 04841

July 27, 1999

No. 26563

Minute Mount[®]

S Y S T E M

Attachment Kit

Ford 650 Super Duty

2000-20__

⚠ CAUTION

See your FISHER[®] outlet for application recommendations. The Kit Selection Guide has specific vehicle and snowplow requirements.

Table Of Contents

Attachment Kit Assembly	2
Bolt Bag Parts List	2
Installation Instructions	3

7164 KIT PARTS LIST

7164 Attachment Kit					
Part #	Qty Req	Description	Part #	Qty Req	Description
26549	1	Pushplate - PS	26555	1	Pushbar Assembly
26548	1	Pushplate - DS	26564	1	Bolt Bag – 7164

PARTS LIST AND DIAGRAM

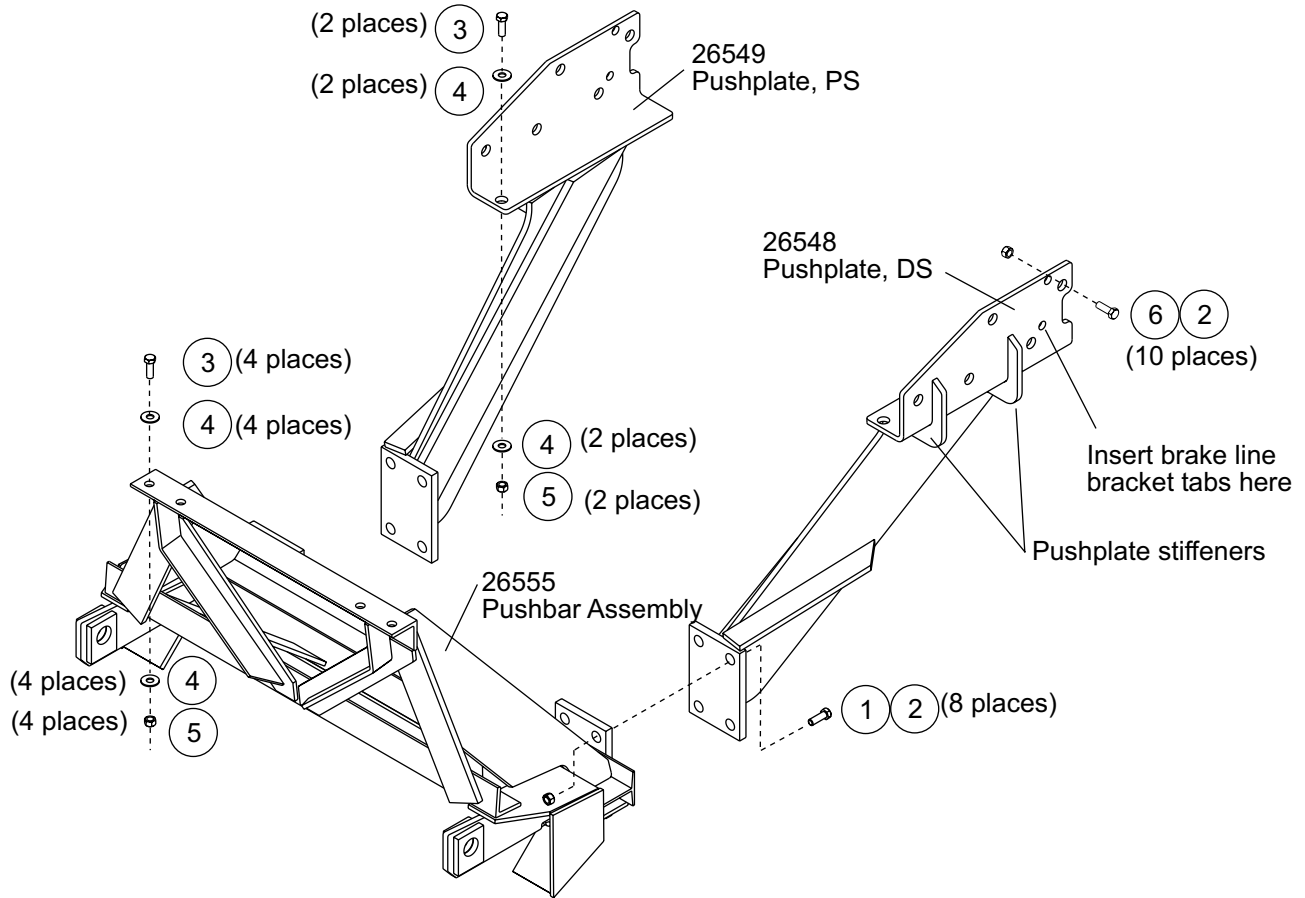

26564 – Bolt Bag							
Ref #	Part #	Qty	Description	Ref #	Part #	Qty	Description
1	90247	8	5/8-11 x 2" Cap Screw, Gr. 5	5	90593	6	1/2-13 Flanged Locknut
2	5573	18	5/8-11 Locknut	6	90244	10	5/8-11 x 1-1/2" Cap Screw Gr. 5
3	90218	6	1/2-13 x 2" Hex Cap Screw Gr. 8	ns	8992	2	Anti-Chafing Material
4	90572	12	1/2" Plain Washer Gr. 8	ns	3666	6	Hose Tie

SAFETY INFORMATION

WARNING



Indicates a potentially hazardous situation that, if not avoided, could result in death or serious personal injury.

CAUTION

Indicates a situation that, if not avoided, could result in minor personal injury and/or damage to product or property.

NOTE: Identifies tips, helpful hints and maintenance information the owner/operator should know.

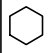
Torque all fasteners according to the torque chart. For proper fit, do not tighten fasteners until instructed to do so.

NC FASTENER TORQUE (FT-LB)			
DIAMETER- THREADS PER INCH	GRADE		
			
	G2	G5	G8
1/4 - 20	6	9	13
5/16 - 18	11	18	28
3/8 - 16	19	31	46
7/16 - 14	30	50	75
1/2 - 13	45	75	115
9/16 - 12	66	110	165
5/8 - 11	93	150	225
3/4 - 10	150	250	370
7/8 - 9	150	378	591
1 - 8	220	583	893

INSTALLATION INSTRUCTIONS

- Remove bumper. Save all fasteners for bumper reinstallation.
- Remove rearmost fasteners attaching the engine cradle crossmember to the frame rails. Discard these fasteners. Remove brake line brackets located just ahead of shock towers on vehicles so equipped. Remove plastic button head on passenger side on vehicles so equipped. Retain these fasteners for reinstallation using new hose tie.
- Loosely attach the pushplates using 1/2 x 2" cap screws, washers, and flanged locknuts where the engine cradle crossmember bolts were previously removed. Be sure to use a washer above and below the pushplate. Also loosely attach using a 5/8 x 1-1/2" cap screw and locknut through the pre-existing frame hole.
- Position the pushplate assembly so the bolting pads on the assembly line up with the bolting pads on the pushplate. Attach snugly, but do not tighten, with eight, 5/8 x 2" cap screws.
- With the top of the pushplate assembly held firmly in place against the formed pan running between the frame rails at the front of the vehicle, drill four, 17/32" holes using the pushplate assembly as a guide. Loosely attach using 1/2 x 2" cap screws washers, and flanged locknuts. Be sure to use a washer above and below the top of the pushplate assembly.
- Reinstall brake line brackets using previously removed fasteners and holes provided in pushplates. Refer to illustration for location of holes.
- Tighten all fasteners at this time per torque chart provided. Begin by tightening the 1/2 x 2" pushplate fasteners that come up through the bottom of the frame. Then, working from the rear to the front, tighten all remaining fasteners per torque chart provided.
- Using the pushplate holes as guides, drill the remaining four 5/8" holes in each frame rail and attach using the 5/8 x 1-1/2" cap screws. Check that all hoses and lines are clear before drilling. Position heads of cap screws facing outward when clearances between cap screws and brake hoses are insufficient. Tighten these per torque chart provided.
- Check clearances between pushplate stiffeners and brake hoses/lines. Use anti-chafing material when clearances are inadequate to prevent contact during normal vehicle operation.
- Reinstall bumper.

Copyright © 1999 Douglas Dynamics, L.L.C. All rights reserved. This material may not be reproduced or copied, in whole or in part, in any printed, mechanical, electronic, film or other distribution and storage media, without the written consent of Fisher Engineering. Authorization to photocopy items for internal or personal use by Fisher Engineering outlets is granted.

Fisher Engineering reserves the right under its product improvement policy to change construction or design details and furnish equipment when so altered without reference to illustrations or specifications used herein. Fisher Engineering and the vehicle manufacturer may require and/or recommend optional equipment for snow removal. Fisher Engineering offers a limited warranty for all snowplows and accessories. See separately printed page for this important information. The following are registered (®) trademarks of Douglas Dynamics, L.L.C.: FISHER®, Minute Mount®

Printed in USA