

www.storksplows.com
Poly Hopper Service Motor Kit
Installation Instructions

79065,
95755-2

⚠ CAUTION

Read this document before installing the service motor kit.

⚠ CAUTION

Use standard methods and practices when attaching spreader and installing accessories including proper personal protective safety equipment.

INSTALLATION INSTRUCTIONS

⚠ CAUTION

Disconnect electric and/or hydraulic power and tag out if required before servicing or performing maintenance.

Motor Type 1

1. Remove the four motor terminal cover screws and remove the cover.
2. Disconnect the two motor cables from the motor terminals. Note the cable color and location prior to removing.

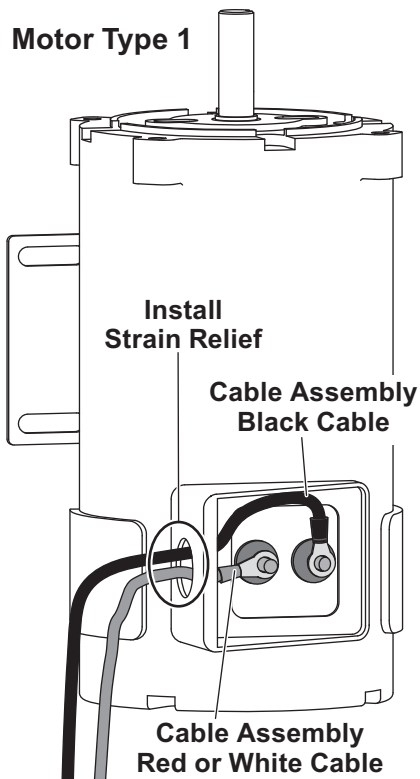

3. Remove the cables from the terminal housing. Remove and discard the rubber grommet.
4. Remove the old motor from the assembly.

Motor Type 2

1. Install the new motor in place of the old, using the original fasteners.
2. Remove and retain the four motor terminal cover screws. Remove the motor terminal cover. The new motor terminal cover is supplied with two cover gaskets. Both are required.
3. Remove the clamping nut from the cable strain relief. If installed, the internal rubber bushing must be removed and discarded in order to install the cable and cable bushing.
4. Place one of the supplied rubber washers on the strain relief and insert the strain relief into the terminal housing.

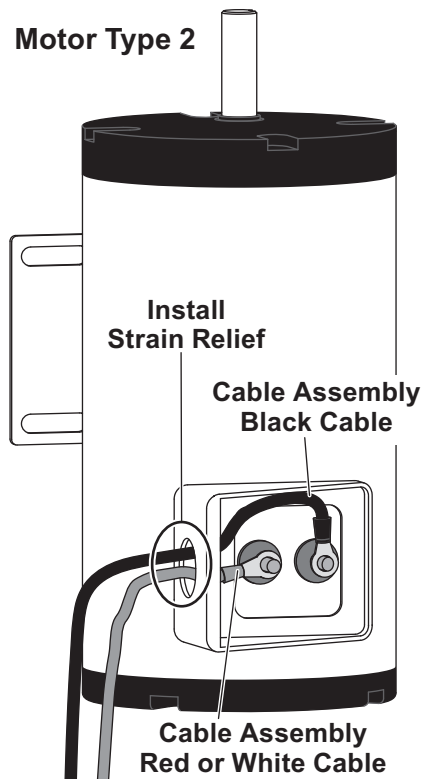
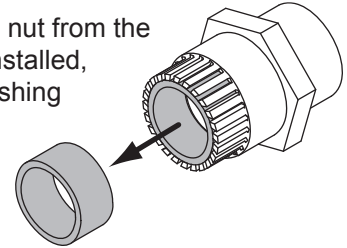

79065, 95755-2

5. Install the second rubber washer on the strain relief inside the housing. Install the mounting nut and securely tighten while holding the strain relief to prevent turning.

6. Install the two-position cable bushing and clamping nut onto the two cables. Cutting the bushing in the two locations shown will aid in the installation.

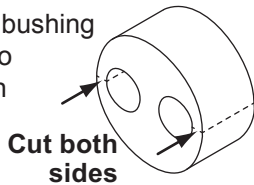

7. Pass the two cables through the strain relief and into the terminal housing. It may be necessary to pass one cable at a time through the strain relief.

8. Connect the cables to the motor terminals. The black cable will connect to the terminal furthest from the cable entry point. The red or white cable will connect to the terminal closest to the cable entry point.

9. Make sure that the ring terminals are not touching one another or the motor case after being tightened.

10. Install the motor terminal cover and both gaskets and tighten with the four supplied screws removed earlier.

11. Tighten the clamping nut, locking the cable in place.

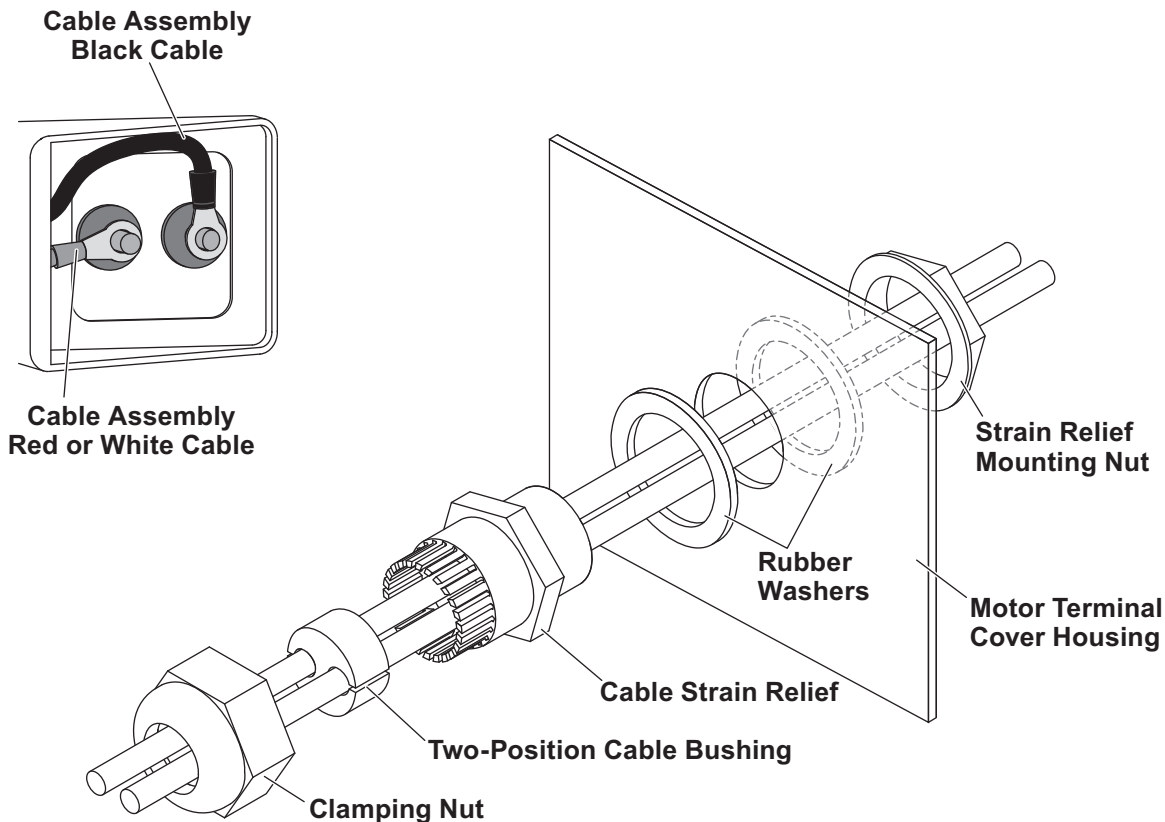

The company reserves the right under its product improvement policy to change construction or design details and furnish equipment when so altered without reference to illustrations or specifications used. This equipment manufacturer or the vehicle manufacturer may require or recommend optional equipment for spreaders. Do not exceed vehicle ratings with a spreader. The company offers a limited warranty for all spreaders and accessories. See separately printed page for this important information.