

INSTALLING FIXED MOUNT MODEL: (35200)

This section covers the installation of an BLASTER 750 & 750S as a fixed mount.

CAUTION – because of its bulk and weight, this salt spreader should be installed with an assistant. As with any new equipment installation, please read and understand all instructions prior to starting the job, and do not hurry through it. A correct installation now can save time and money later.

- 1.) With the help of an assistant, remove the spreader unit and all loose components from the packaging and set the cover aside until installation is complete. Retain original packaging for storage.
- 2.) Bolt the DS & PS Upright Weldments (2 & 3) to the spreader frame using (4) 3/8-16 x 1" Bolts (5) with 3/8" Flatwashers (9) and 3/16 Locknuts (7).
- 3.) Place the Tailgate Bracket (1) over the tailgate, centered with the brackets pointed away from the truck as shown below.
- 4.) Set the spreader with attached DS & PS Upright Weldments (1 & 2) on the bumper and center it with respect to the tailgate. After setting the spreader in place, the DS & PS Upright Weldments (1 & 2) should fall between the brackets welded to the Tailgate Bracket. Using a "C" clamp or vise grip pliers, clamp the DS & PS Upright Weldments (1 & 2) to the Tailgate Bracket (1) weldment brackets.
- 5.) Check that the unit is level and centered on the truck.
- 6.) The Tailgate Bracket (1) weldment brackets will have 2 holes in each, use these holes as a guide and drill a 3/8" hole through the DS & PS Upright Weldments (1 & 2). Be sure to place a 3/8-16 x 1" Bolt (5) with 3/8" Flatwashers (9) and 3/8-16 Locknuts (7) in each hole before removing clamps.
- 7.) Again, check to see that the unit is centered on the truck. Bolt both Stiffener brackets (4) to the Tailgate Bracket (1) using a 1/2-13 x 1-1/2" Bolt (6) with 1/2" Flatwashers (10) and 1/2-13 Locknuts (8) for each side. Do not tighten these bolts yet.
- 8.) Swing Stiffener brackets (4) until pre-punched hole is centered with top of bed rail. Use the Stiffener bracket (4) as a guide and drill 1/2" Dia. hole through the bed rail on both sides. Use a 1/2-13 x 1-1/2 Bolt (6) with 1/2" Flatwashers (10) and 1/2-13 Locknut (8) on each side. Tighten all bolts.
- 9.) Use the bottom of the DS & PS Upright Weldments (2 & 3) as a guide for drilling into the bumper. Drill a 3/8" Dia. hole through the bumper and fasten with a 1/2-13 x 1-1/4" Bolt (6) 1/2" Flatwashers (10) and 1/2-13 Locknut (8) on each side.
- 10.) Double check that all nuts and bolts are tight.
- 11.) Install cover and latch both sides.

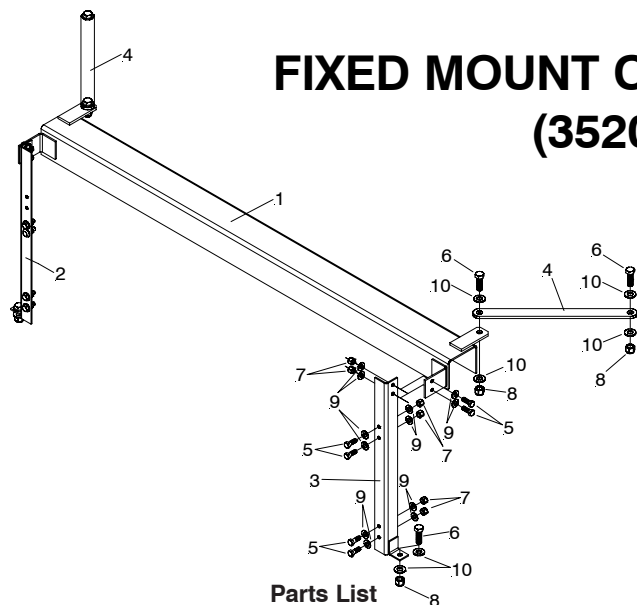

FIXED MOUNT COMPONENTS (35200)

Parts List

Item	Part No.	Qty.	Description
	35200		Blaster Fixed Mount
1	35207	1	• Tailgate Bracket
2	35205	1	• DS Upright Weldment
3	35202	1	• PS Upright Weldment
4	35201	2	• Stiffener
	35211	1	• Hardware Bag
5	22737	12	•• Bolt 3/8-16 x 1" SS
6	22742	6	•• Bolt 1/2-13 x 1-1/2" SS
7	22735	4	•• Locknut 3/8-16 SS
8	22732	6	•• Locknut 1/2-13 SS
9	22734	16	•• Flawasher 3/8" SS
10	22733	12	•• Flawasher 1/2" SS

Parts indented are included in the assembly under which they are indented.