

## PARTS & INSTALLATION INSTRUCTIONS

# MEYER SNOW PLOW MOUNTING

## 1983½ - 1986 NISSAN PICKUP 4 x 4

Vehicle manufacturer specifications must be adhered to for the installation of this equipment.

### PARTS LIST

Item	Part No.	Quantity	Description
	18015	1	MOUNTING CARTON
1	10882	1	● Lift Frame
2	10529	1	● Support Arm
3	10514	1	● Lift Arm
4	10872	1	● Underframe
5	10874	1	● Front Bracket, Right hand
6	10873	1	● Front Bracket, Left hand
7	10715	1	● Light Bracket, Left hand
8	10716	1	● Light Bracket, Right hand
9	13594	1	● A-frame
10	12984	1	● Pivot Bar
11	12978	2	● Trip Springs
	08526	1	● Mounting Hardware Bag
12	20002	2	●● Bolts, H 1/4-20 x 5/8 Gr. 2
13	22059	4	●● Bolts, C 1/4-20 x 1 Gr. 1
14	21253	4	●● Flat Washers, 1/4" S.A.E.
15	20303	4	●● Locknuts, 1/4-20
16	20524	2	●● HexNuts, 1/4-20
17	20066	10	●● Bolts, H 3/8-16 x 1-1/4 Gr. 5
18	20305	4	●● Locknuts, 3/8-16
19	20353	4	●● Flat Washers, 3/8
20	20327	6	●● Lock Washers, 3/8
21	20139	4	●● Bolts, H 5/8-11 x 1-1/2 Gr. 5
22	20140	4	●● Bolts, H 5/8-11 x 1-3/4 Gr. 5
23	20144	1	●● Bolt, H 5/8-11 x 2-3/4 Gr. 5
24	20147	1	●● Bolt, H 5/8-11 x 3-1/2 Gr. 5
25	20309	10	●● Locknuts, 5/8-11
26	14595	2	●● Bolts, Special 3/4"
27	21260	2	●● Flat Washers, 3/4 S.A.E.
28	20319	2	●● Locknuts, Eslok, 3/4-10
29	10880	2	●● Bumper Extension Plates
30	10538	2	●● Quick Disconnect Pins
31	21984	2	●● Hair Pin Cotter Pins
	08511	1	● Snow Plow Hardware Bag
32	11006	2	●● Hinge Pins
33	21984	2	●● Hair Pin Cotter
34	12150	2	●● Eye Bolts
35	20309	5	●● Locknuts, 5/8-11
36	13598	2	●● Pivot Bolts
37	13591	1	●● King Bolt
38	20150	2	●● Bolts, H 5/8-11 x 4-1/2" Gr. 5
39	20318	4	●● Locknuts, Eslok, 5/8-11
	09916	1	● Snow Plow Marker Kit
40	08201	2	●● Snow Plow Marker Assemblies
41	12816	2	●● Clamps
42	20006	2	●● Bolts, H 1/4-20 x 1 Gr. 2
43	20312	2	●● Locknuts, 1/4-20
	08470	1	● Electrical Disconnect Kit
44	09102	1	MOLDBOARD ASSEMBLY, TWO-METER
45	09100	1	● Cutting Edge - Two Meter
46	21943	6	● Bolts, C 1/2-13 x 1-3/4
47	20307	6	● Locknuts, 1/2-13

Parts indented are included in the carton, bag or assembly under which they are indented.

Meyer Products, Inc., reserves the right, under its continuing product improvement program, to change construction or design details specifications and prices without notice or without incurring any obligation.

## GENERAL INFORMATION

**CAUTION:** Always disconnect battery before beginning installation.

**DO NOT** burn holes or weld vehicle frame. This may cause frame failure.

After first use retighten all mounting bolt connections to specified torque. All mounting bolt connections to be checked periodically for tightness.

Check contents against the parts list to determine all are correct and included; and also to familiarize yourself with them.

Locknuts are furnished. **DO NOT** tighten bolts and nuts until installation is complete (unless otherwise specified), then be sure to tighten all attaching parts per specified torque chart.

When ordering parts furnish Part No., Name and Description. Also furnish Vehicle Model and Year, Type of Hydraulic Unit and Moldboard Size.

## INSTALLATION INSTRUCTIONS

- A. Remove front bumper, leaving the brackets attached to the vehicle. Remove skid plate and tow hook. Retain all hardware. Keep bumper end brackets attached.
- B. Attach Front Brackets (5 and 6) to weldnuts in end of vehicle frame using vehicle bolts which originally held tow hook to frame.

- C. Place Lift Frame (1) in position and insert 3/8" x 1-1/4" Bolts (17) through holes "A" in Lift Frame (1) and holes in vehicle bumper bracket. Secure with 3/8" Flatwashers (19), and 3/8" Locknuts (18).
- D. Insert 5/8" x 1-3/4" Bolts (22) into holes "B" in Lift Frame (1) and Front Brackets (5 and 6). Secure with 5/8" Locknuts (25).
- E. Attach Underframe (4) to Lift Frame (1) with 5/8" x 1-1/2" Bolts (21), and 5/8" Locknuts (25) and to vehicle frame cross member using special 3/4" Bolts (26) inserted into frame holes. Secure with 3/4" Flatwasher (27) and 3/4" Locknut (28). Tighten all bolts to proper torque, beginning with Front Brackets (5 and 6).
- F. Attach Light Brackets (7) and (8) to weldnuts in light bracket clip on Lift Frame (1) using 3/8" x 1-1/4" Bolts (17) and 3/8" Lockwashers (20). Attach Snow Plow Light to Light Bracket (7 and 8) and tighten all Bolts. Check for clearance at Light when vehicle hood is opened. Snow Plow Lights must be adjusted to comply with Federal Regulations.

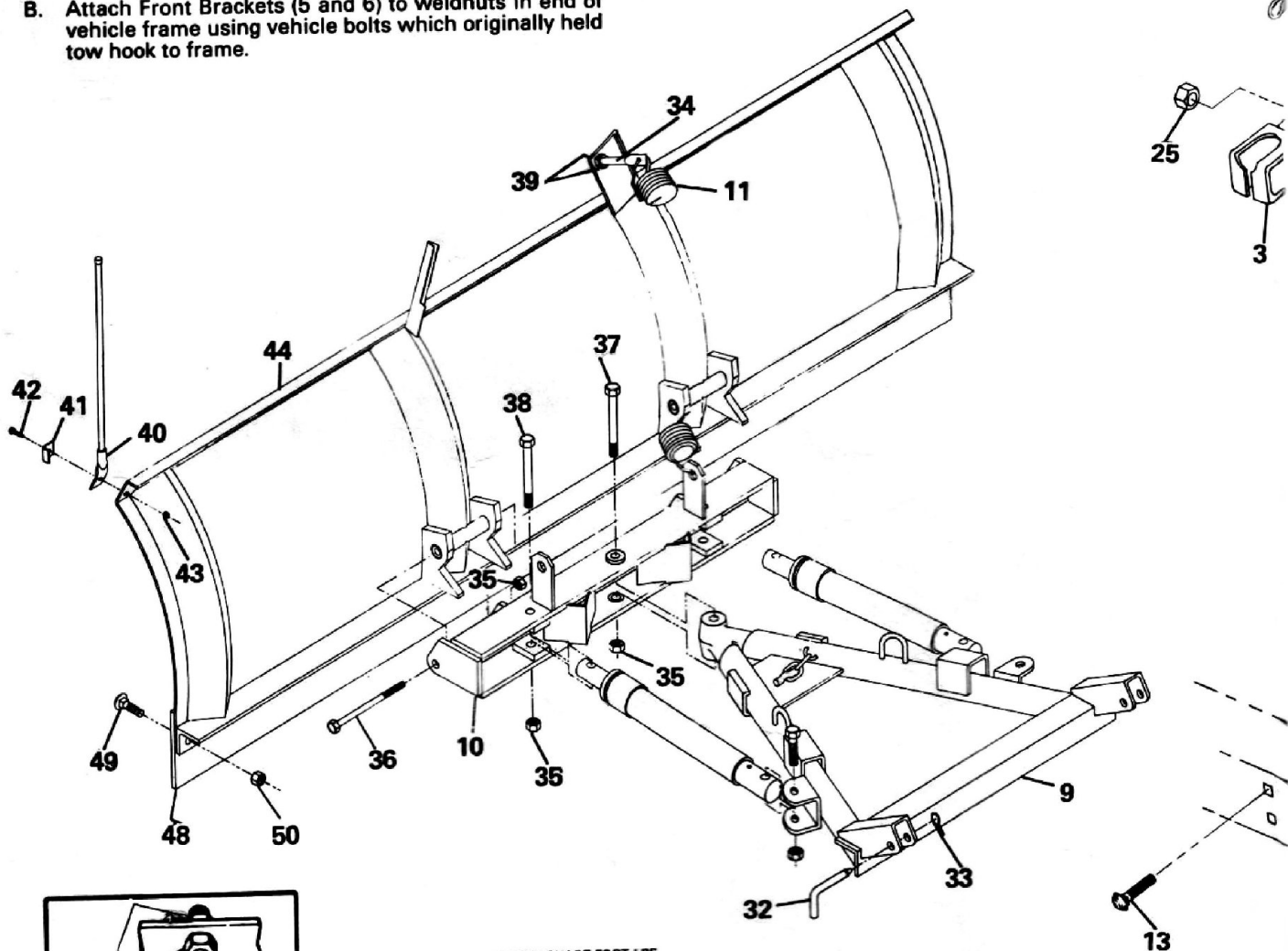

FIGURE 1

TORQUE CHART FOOT LBS.

Bolt-Nut Size	GR. 2	GR. 5	GR. 8
1/4 - 20	4 - 5		
5/16 - 18	9 - 11		
3/8 - 16	17 - 20	26 - 29	60 - 66
7/16 - 14		42 - 46	90 - 100
1/2 - 13		64 - 72	179 - 198
5/8 - 11		127 - 141	
3/4 - 10		227 - 251	

G. Install Snow Plow Light Wiring per separate instructions.

H. Attach bumper to Lift Frame (1) using 1/4" x 1" Carriage Bolt (13) and 1/4" Locknut (15). Secure Bumper Extension Plate (29) to fender using original vehicle bolt and 1/4" Flatwasher (14). Attach plastic guard to Bumper Extension Plate (29) using 1/4" x 5/8" Bolt (12), original vehicle Flatwasher, 1/4" Flatwasher (14) and 1/4" x 20" Hex Nut (16). Original vehicle "Z" bracket can be added to bumper if desired.

I. Assemble Electro-Touch Unit to Support Arm (2) using 5/8" x 3-1/2" Bolt (24) and 5/8" Locknut (25); and Lift Arm (3) to Lift Ram using 5/8" x 2-3/4" Bolt (23) and 5/8" Locknut (25). Secure this assembly to Lift Frame (1) using Quick Disconnect Pins (30) and Hair Pin Cotter (31).

J. Install Hydraulic and Electrical System per separate instructions.

K. Attach Pivot Bar (10) to Moldboard (44) using Pivot Bolts (36) coated with chassis lubricant, and 5/8" Locknut (35).

L. Attach Trip Springs (11) to Pivot Bar (10) and Moldboard (44) with Eye Bolts (34) and Locknuts (39). Flat End of Eye Bolt (34) must be in a vertical position, as shown in Figure 1, to hinge properly when Moldboard (44) trips. Proper tension is attained when Trip Spring (11) coils begin to separate and then tightening top Locknut (39) four additional turns. Tighten bottom Locknut (39) to secure Eye Bolt (34) in position. See Fig. 1.

M. Assemble A-frame (9) to Pivot Bar (10) using King Bolt (37) and 5/8" Locknut (35). Grease King Bolt (37) prior to installation.

N. Install Power-Angling Rams with fitting end to the A-frame (9) Clevis using 5/8" x 3-1/4" Bolt and 5/8" Locknut. (packed in hardware bag 08363 in Electro-Touch carton) Attach piston end of ram to Pivot Bar (10) using 5/8" x 5" Bolt (38) and 5/8" Locknut (35).

O. Straighten end of Plow Markers (40) so they will be vertical after installation. Attach using 1/4" x 1" Bolt (42), Clamp (41) and 1/4" Locknut (43).

P. Secure the Moldboard-Pivot Bar-A-Frame assembly to vehicle at Clevis on Underframe (4) using Hinge Pins (32) and Spring Clips (33). Attach Lift Chain to Lift Arm (3) allowing sufficient slack to allow Moldboard to follow ground contours.

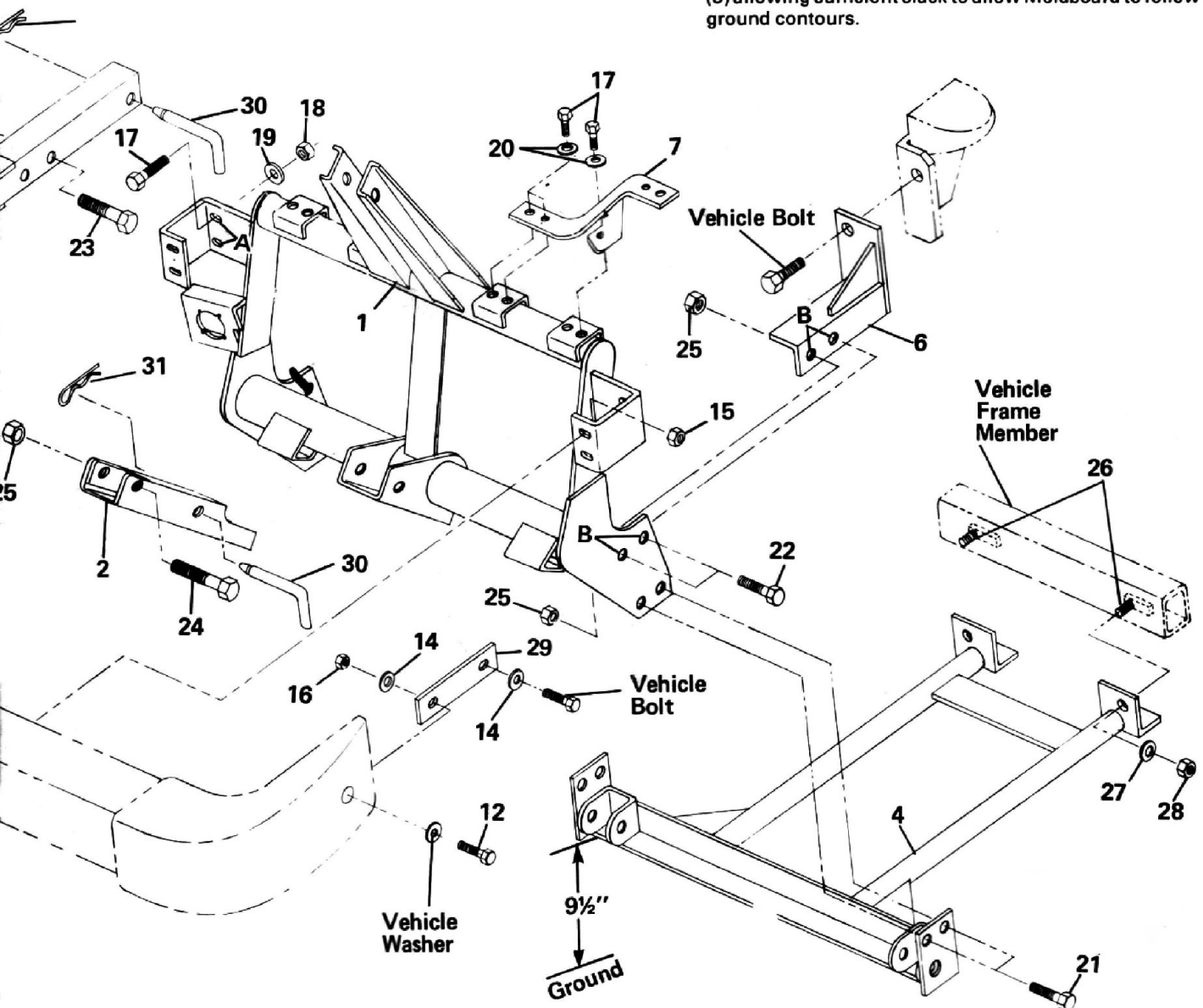

NOTICE: Meyer Products assumes no responsibility for installations not made in accordance with these instructions.